

PART #	"X" LENGTH	"Y" LENGTH	"T" TIME
0722	240 [6096]	180 [4572]	18
0722-1	360 [9144]	300 [7620]	28

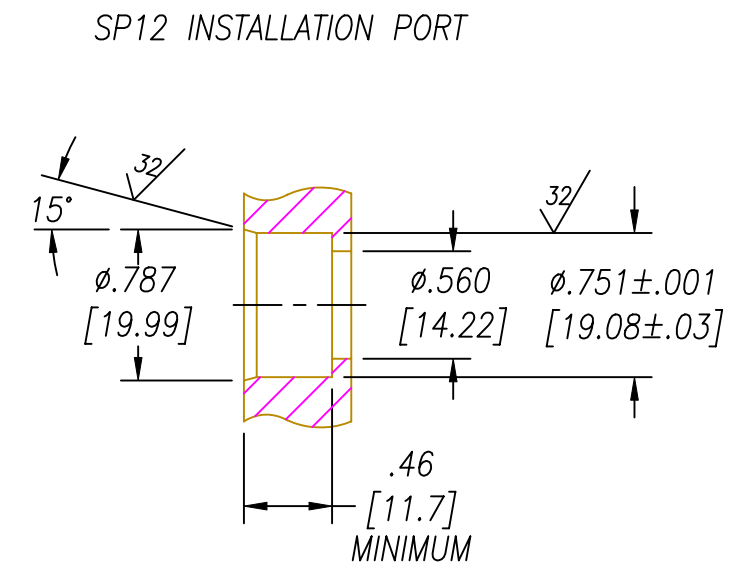
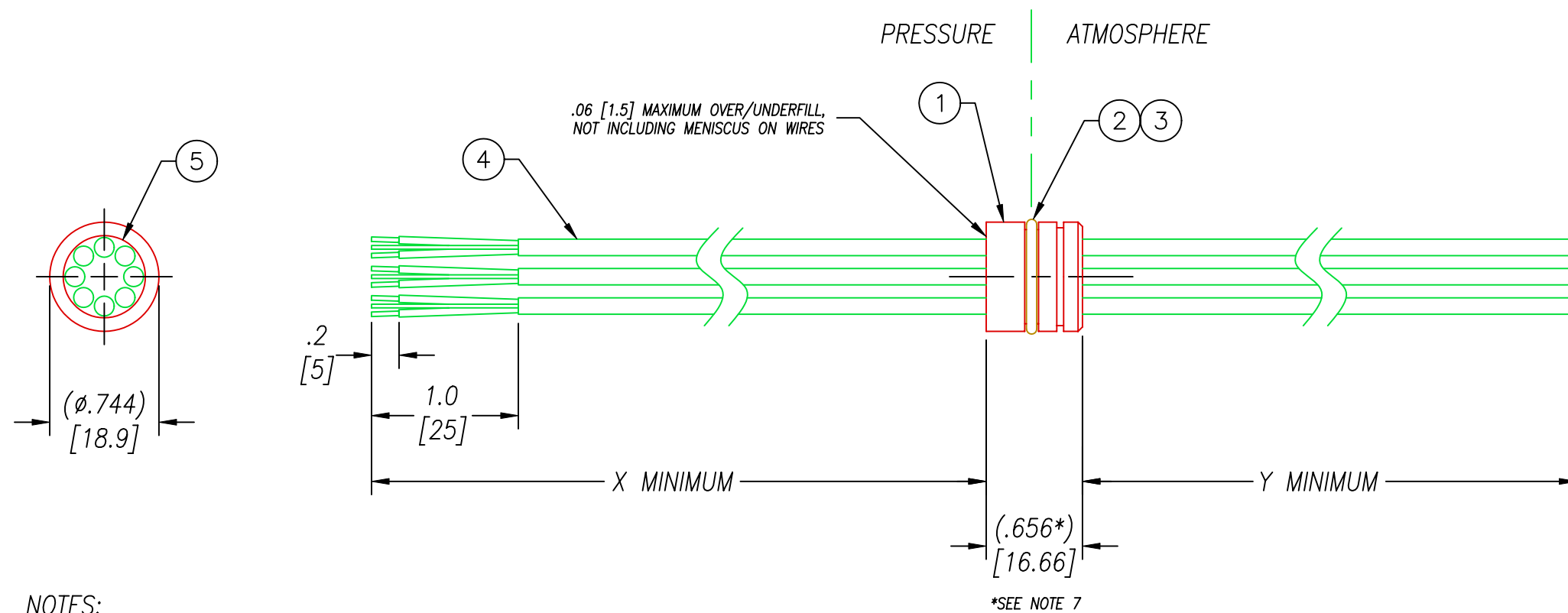

NOTES:

1. LEAK TEST: 80 PSI, NO BUBBLES "T" MINUTES MINIMUM. LEAK TEST MAY BE PERFORMED OPPOSITE DIRECTION SHOWN.
2. HYPOT 50 VDC 20 MΩ 0.01 SEC MINIMUM, WIRE TO WIRE.
3. ALL TESTS ARE PERFORMED AT ROOM TEMPERATURE.
4. ALL PARTS MUST PASS ALL TESTS.
5. WIRES ARE NOT REQUIRED TO BEND SHARPLY AT EPOXY SEAL SURFACE.
6. NO VOIDS ARE ACCEPTABLE ON O-RING SEALING SURFACES, VOIDS SMALLER THAN $\phi.035$ [0.89] ARE ACCEPTABLE ON ALL OTHER SURFACES.
7. DIMENSION IS OVERALL LENGTH EXCLUDING OVERFILL ON PRESSURE SIDE OF HOUSING.
8. REF-PARTS ARE DEFLASHED ON PARTING LINE $+.005$ [.13] MAXIMUM.
9. DIMENSIONS ARE INCHES [millimeters].

5	A/R	PAVE-Seal 150	EPOXY BLACK
4	8	BX20 CABLE	CABLE T/C 20 ANSI BX TWSH
3	A/R	PARKER O-LUBE	LUBRICANT O-RING BARIUM-BASED
2	1	-016 VITON	O-RING -016 VITON 75
1	1	0434	HOUSING SP12-E
ITEM	QTY	PART#	DESCRIPTION

PAVE technology co.
 2751 Thunderhawk Court
 Dayton, Ohio 45414-3445
 U.S.A.
 (937)890-1100
 fax (937)890-5165
 www.pavetechnologyco.com

ALL DIMENSIONS AND TOLERANCES APPLY TO FINISHED PART IN INCHES
 ALLOWABLE TOLERANCES UNLESS SPECIFIED OTHERWISE: NONE ± 0.5
 .X DECIMAL ± 0.1 .XX DECIMAL ± 0.02 .XXX DECIMAL ± 0.005
 ANGLES ± 1 DEG SURFACE FINISH 128 microinch RMS

DESCRIPTION PAVE-Seal® Cable Harnesses
 SP12-E-150-8P-BX20-X-Y SEE TABLE FOR X & Y
 PART NUMBER 0722
 REVISION LEVEL C
 PROJECTION