

LEAK TEST PORT

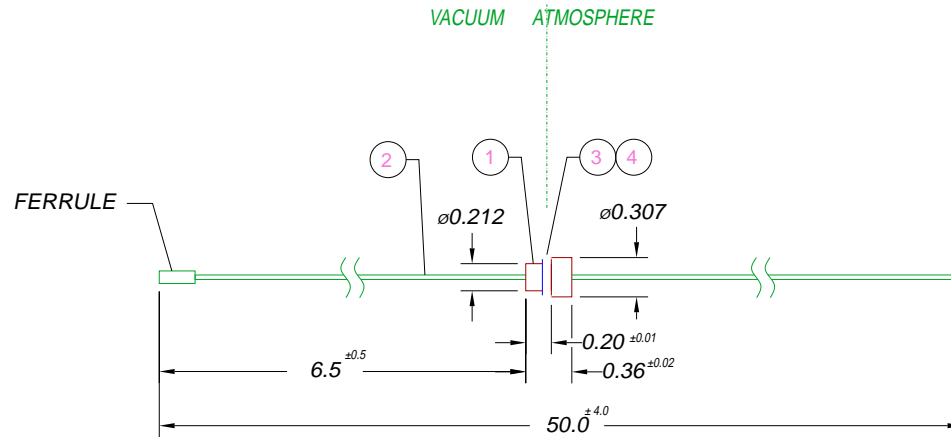
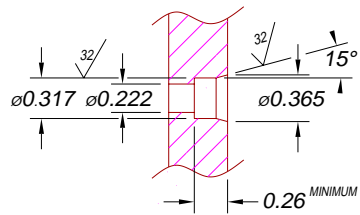

NOTES:

1. HE LEAK TEST @1 ATM.  $<10^{-7}$  CC/S.
2. ALL TESTS ARE PERFORMED AT ROOM TEMPERATURE.
3. OPTICAL CONTINUITY TEST (VISUAL).
4. ITEM 2 MAY BE SUPPLIED WITHOUT FERRULE.

4	A/R	SUPER O-LUBE	LUBRICANT O-RING SILICONE-BASED
3	1	-008 E0667	O-RING -008 ETHYLENE PROPYLENE 70
2	1	400501	FIBER OPTICAL 900um 4/125 TERMINATED W/ FERRULE
1	A/R	PAVE-Seal 150	EPOXY BLACK
ITEM	QTY	PART#	DESCRIPTION

ALL DIMENSIONS AND TOLERANCES APPLY TO FINISHED PART IN INCHES  
 ALLOWABLE TOLERANCES UNLESS SPECIFIED OTHERWISE: NONE +/- .5  
 .X DECIMAL +/- .1 .XX DECIMAL +/- .02 .XXX DECIMAL +/- .005  
 ANGLES +/- 1 DEG SURFACE FINISH 128 microinch RMS

**PAVE Technology** 2751 Thunderhawk Court  
 Dayton, Ohio 45414-3446  
 U.S.A.  
 (937)890-1100  
 fax (937)890-5165  
 www.pavetechnologyco.com

DESCRIPTION  
 PAVE-Opti SealFromans.shx; Cable Harnesses  
**SP4.9-E-150-1-SMFO-6.5-39**

PART NUMBER  
**2176**

PROJECTION