

RECOMMENDED INSTALLATION PORT DIMENSIONS

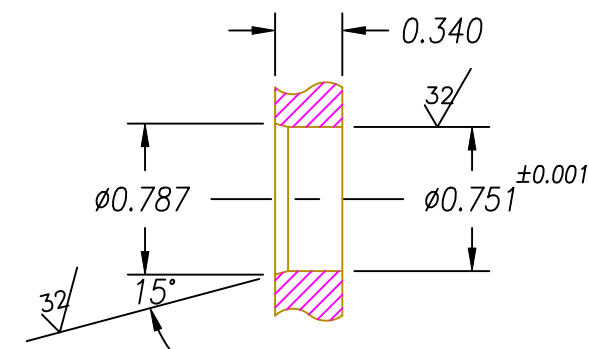

NOTES:

1. HE LEAK TEST @1 ATM. 10^{-7} CC/S. WITH O-RING CLEAN W/METHANOL BEFORE INSERTING INTO TEST PORT.
2. 30 KVDC HYPOT TEST WITH 5 μ A MAXIMUM LEAKAGE TO LEAK TEST PORT.
3. ALL TESTS ARE DONE AT ROOM TEMPERATURE & HUMIDITY.
4. PERCENTAGE OF PARTS TESTED WILL BE 100% (MAY BE A LESSER PERCENTAGE FOR LARGE PRODUCTION QUANTITIES, UNLESS OTHERWISE NOTED OR REQUIRED).
5. O-RING TO BE SHIPPED DRY, NO O-LUBE ALLOWED.
6. CONTINUOUS CONTACT OF METHANOL TO VITON O-RING WILL CAUSE O-RING TO SWELL AND NOT SEAL PROPERLY.
7. "PAVE" & "2513" MARKINGS APPROXIMATELY AS SHOWN.
8. REFERENCE- RETAINING RING WALDES TRUARC #5100-75.
9. LABEL W/ "2513 REV:(CURRENT)", DATE OF MANUFACTURE, & "PAV01-01".
10. CONTINUITY TEST: 27 m Ω MAXIMUM END TO END OF MATING CONNECTOR.

9	3/4"	FP301-3/8	3M HEATSHRINK, 3/8" BLACK
8	12"	NER72436T	WIRE 14 STRANDED BARE TINNED COPPER
7	12"	UPCSCI#1524L	TUBING FEP 1/8"ID X 3/16"OD
6	1	-016 VITON	O-RING -016 VITON 75
5	A/R	PAVE-Seal 150	EPOXY BLUE
4	1	-	PRINTABLE LABEL
3	16"	U-210015	SMALL PARTS: TBG, SILICONE RUBBER, FLEX
2	1	0130 SPF12	HOUSING SPF12-E
1	1	ALDEN #B200PA48	BELDEN #9867 W/ALDEN B200-200
ITEM	QTY	PART#	DESCRIPTION

ALL DIMENSIONS AND TOLERANCES APPLY TO FINISHED PART IN INCHES
 ALLOWABLE TOLERANCES UNLESS SPECIFIED OTHERWISE: NONE +/-0.5
 .X DECIMAL +/- 0.1 .XX DECIMAL +/- 0.02 .XXX DECIMAL +/-0.005
 ANGLES +/- 1 DEG SURFACE FINISH 128 microinch RMS



DESCRIPTION PAVE-Seal® Cable Harnesses
 SPF12-E-150-B9867/BARE14-24-11

PART NUMBER
 2513

REVISION LEVEL
 A
 PROJECTION