

SPF12 INSTALLATION PORT

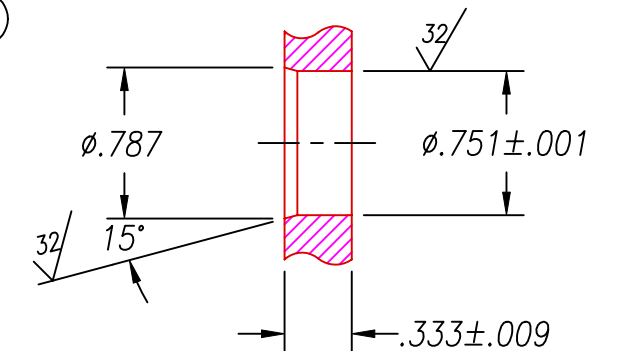

RECOMMENDED RETAINING RING
TRUARC #5100-75 OR EQUAL

NOTES:

1. HE LEAK TEST @1 ATM. 10×10^{-8} CC/S OR LESS. CLEAN O-RING WITH METHANOL BEFORE INSERTING INTO TEST PORT.
2. HYPOT 630 VDC 500 MΩ 0.01 SEC MINIMUM, CENTER CONDUCTOR TO SHIELD.
1 KVDC HYPOT TEST WITH 5 μA MAXIMUM LEAKAGE CENTER CONDUCTOR TO LEAK TEST PORT.
3. ALL TESTS ARE DONE AT ROOM TEMPERATURE & HUMIDITY.
4. ALL PARTS MUST PASS ALL TESTS.
5. O-RING TO BE SHIPPED DRY, NO O-LUBE ALLOWED.
6. CONTINUOUS CONTACT OF METHANOL TO VITON O-RING WILL CAUSE O-RING TO SWELL AND NOT SEAL PROPERLY.
7. "PAVE" & "2822" MARKINGS APPROXIMATELY AS SHOWN.
8. CONTINUITY TEST FROM END OF MATING CONNECTOR TO END OF RED WIRE TERMINAL < 0.16 Ω,
TO END OF BLACK WIRE TERMINAL < 12 mΩ.
9. LABEL W/"META SUPR (+)", "1016850/G", "PAV".
10. LABEL W/INFORMATION SPECIFIED, ALL LABELS TO BE INSTALLED SO THAT ALL INFORMATION ON LABEL IS VISIBLE.
11. PACKAGE ASSEMBLY INDIVIDUALLY IN A PLASTIC BAG AND INCLUDE "1016850 REV:G" ON BAG LABEL.
12. NO VOIDS ARE ACCEPTABLE ON O-RING SEALING SURFACES, VOIDS SMALLER THAN 0.035 ARE ACCEPTABLE ON ALL OTHER SURFACES.

WIRING CHART	
ITEM 6-COND	ITEM 4 RED
ITEM 6-SHIELD	ITEM 5 BLK
FROM	TO

ITEM	QTY	PART#	DESCRIPTION
11	2	-	CABLE TIE, NYLON
10	1	2631625102	FERRITE ROUND CABLE .312 ID 260 OHM 100 MHZ
9	1	PE4098	CONNECTOR MHV MALE RG59 CLAMP
8	2	CRS-TO-2202	TERMINAL RING #2 26-24 AWG
7	2	-	PRINTABLE LABEL
6	1	RG59/U	BELDEN 8241A OR EQUAL COAX
5	1	E20 SOLID BLK	WIRE 20E UL1213 SOLID CONDUCTOR
4	1	E20 SOLID RED	WIRE 20E UL1213 SOLID CONDUCTOR
3	1	-016 VITON	O-RING -016 VITON 75
2	A/R	PAVE-Seal 150	EPOXY BLUE
1	1	0130	HOUSING SPF12-E

ALL DIMENSIONS AND TOLERANCES APPLY TO FINISHED PART IN INCHES
ALLOWABLE TOLERANCES UNLESS SPECIFIED OTHERWISE: NONE +/-0.5
.X DECIMAL +/- 0.1 .XX DECIMAL +/- 0.02 .XXX DECIMAL +/-0.005
ANGLES +/- 1 DEG SURFACE FINISH 128 microinch RMS

2751 Thunderhawk Court
Dayton, Ohio 45414-3445
U.S.A.
(937)890-1100
fax (937)890-5165
www.pavetechnologyco.com

PAVE technology co.

DESCRIPTION PAVE-Seal Cable Harnesses
SPF12-E-150-1/2-RC59U/E20-33-4

PART NUMBER **2822**

REVISION LEVEL **D**

PROJECTION