

SP11L INSTALLATION PORT

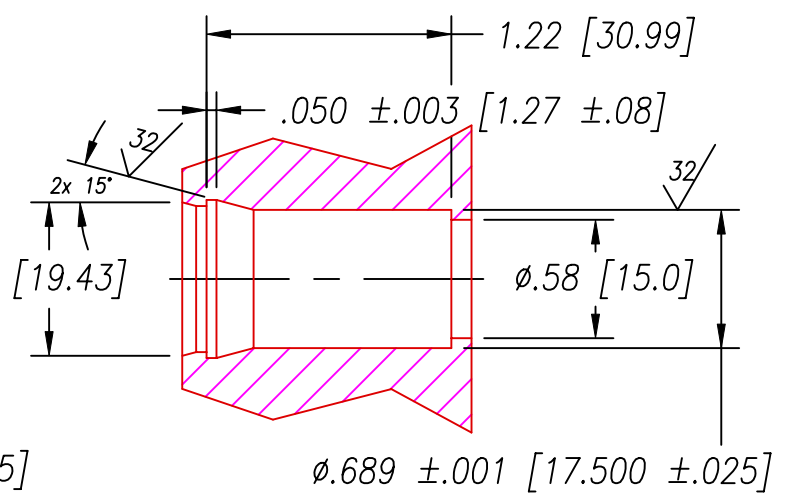

RECOMMENDED RETAINING RING
 TRUARC #N5000-77 OR EQUAL

NOTES:

- WIRES ON LOW PRESSURE SIDE & WHERE STRIPPED OF INSULATION TO HAVE 0.7mm MINIMUM SEPARATION.
- LEAK TEST, 100% OF UNITS: 80 PSI, NO VISIBLE LEAKS; 1 PER BATCH OF 100: 2175 PSI, NO VISIBLE LEAKS, 2 MINUTES MINIMUM.
- ELECTRICAL TEST: 1000 VDC, 100 MEGOHMS MIN WIRE TO WIRE.
- HE LEAK TEST 15% OF UNITS @1 ATM. 10×10^{-8} CC/SEC OR LESS.
- WIRE BENDING TEST: WIRES MUST BE FREE TO BEND 90° WITHIN 2mm OF HOUSING EXIT AT BOTH ENDS.
- IF ANY UNITS FAIL 15% TESTING, ALL UNITS IN THE BATCH MUST BE TESTED.
- OPERATING TEMPERATURE RANGE IS -50°C TO 150°C (EXCLUDING VITON O-RING).
- WIRE COLOR ARRANGEMENT CAN VARY.
- NO VOIDS ARE ACCEPTABLE ON O-RING SEALING SURFACES, VOIDS SMALLER THAN ϕ .035 [.89] ARE ACCEPTABLE ON ALL OTHER SURFACES.
- DIMENSIONS ARE IN INCHES [mm].
- REF-PARTS ARE DEFLASHED ON PARTING LINE +.005 MAXIMUM.
- THIS PART IS RoHS COMPLIANT.

14	1	SUPER O-LUBE	LUBRICANT O-RING SILICONE-BASED
13	1	-015 OBO10151	O-RING -015 HYDROGENATED NITRILE BLACK
12	1	-015 VITON	O-RING -015 VITON 70 BROWN
11	1	E26 YELLOW	WIRE 26E MIL-W-16878/4 .010 7/#34
10	1	E26 WHITE	WIRE 26E MIL-W-16878/4 .010 7/#34
9	1	E26 RED	WIRE 26E MIL-W-16878/4 .010 7/#34
8	1	E26 PURPLE	WIRE 26E MIL-W-16878/4 .010 7/#34
7	1	E26 GREEN	WIRE 26E MIL-W-16878/4 .010 7/#34
6	1	E26 BLUE	WIRE 26E MIL-W-16878/4 .010 7/#34
5	1	E26 BROWN 7STRD	WIRE 26E MIL-W-16878/4 .010 7/#34
4	1	E26 GRAY	WIRE 26E MIL-W-16878/4 .010 7/#34
3	1	E26 BLACK 7STRD	WIRE 26E MIL-W-16878/4 .010 7/#34
2	A/R	PAVE-Seal 150	EPOXY BLACK
1	1	1374L	HOUSING SP11L-E
ITEM	QTY	PART#	DESCRIPTION

2751 Thunderhawk Court
 Dayton, Ohio 45414-3445
 U.S.A.
 (937)890-1100
 fax (937)890-5165
 www.pavetechnologyco.com

PAVE technology co.

DESCRIPTION PAVE-Seal Cable Harnesses
 SP11L-E-150-9-TE26-650mm/800mm-150mm

PART NUMBER

3218

REVISION LEVEL

A

PROJECTION

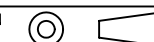

ALL DIMENSIONS AND TOLERANCES APPLY TO FINISHED PART IN INCHES
 ALLOWABLE TOLERANCES UNLESS SPECIFIED OTHERWISE: NONE +/-0.5
 .X DECIMAL +/- 0.1 .XX DECIMAL +/- 0.02 .XXX DECIMAL +/-0.005
 ANGLES +/- 1 DEG SURFACE FINISH 128 microinch RMS