

PART #	"X" LENGTH	"Y" LENGTH	"T" TIME	ITEM 4	ITEM 3	ITEM 3 DESCRIPTION
0722	240 [6096]	180 [4572]	18	BX20 CABLE	PARKER O-LUBE	LUBRICANT O-RING BARIUM-BASED
0722-1	360 [9144]	300 [7620]	28	BX20 CABLE	PARKER O-LUBE	LUBRICANT O-RING BARIUM-BASED
0722-2	472 [11989]	15 [381]	N/A	BX-20-TAT	FOMBLIN YVAC 3	LUBRICANT O-RING FOMBLIN GREASE

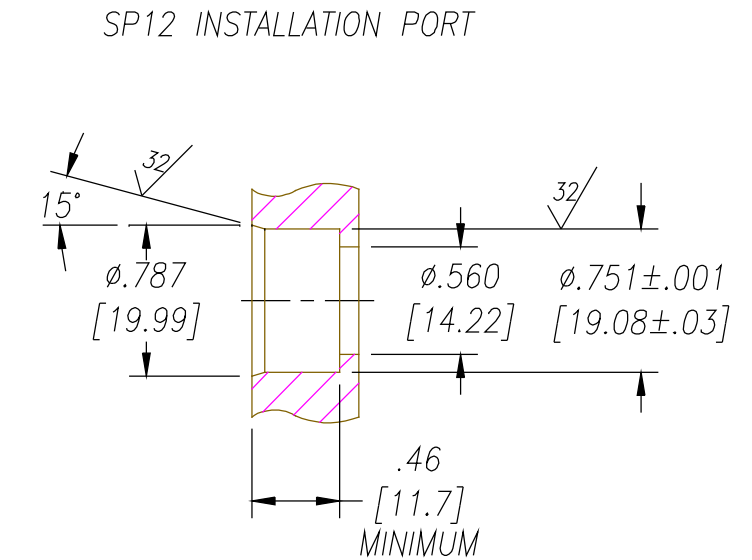
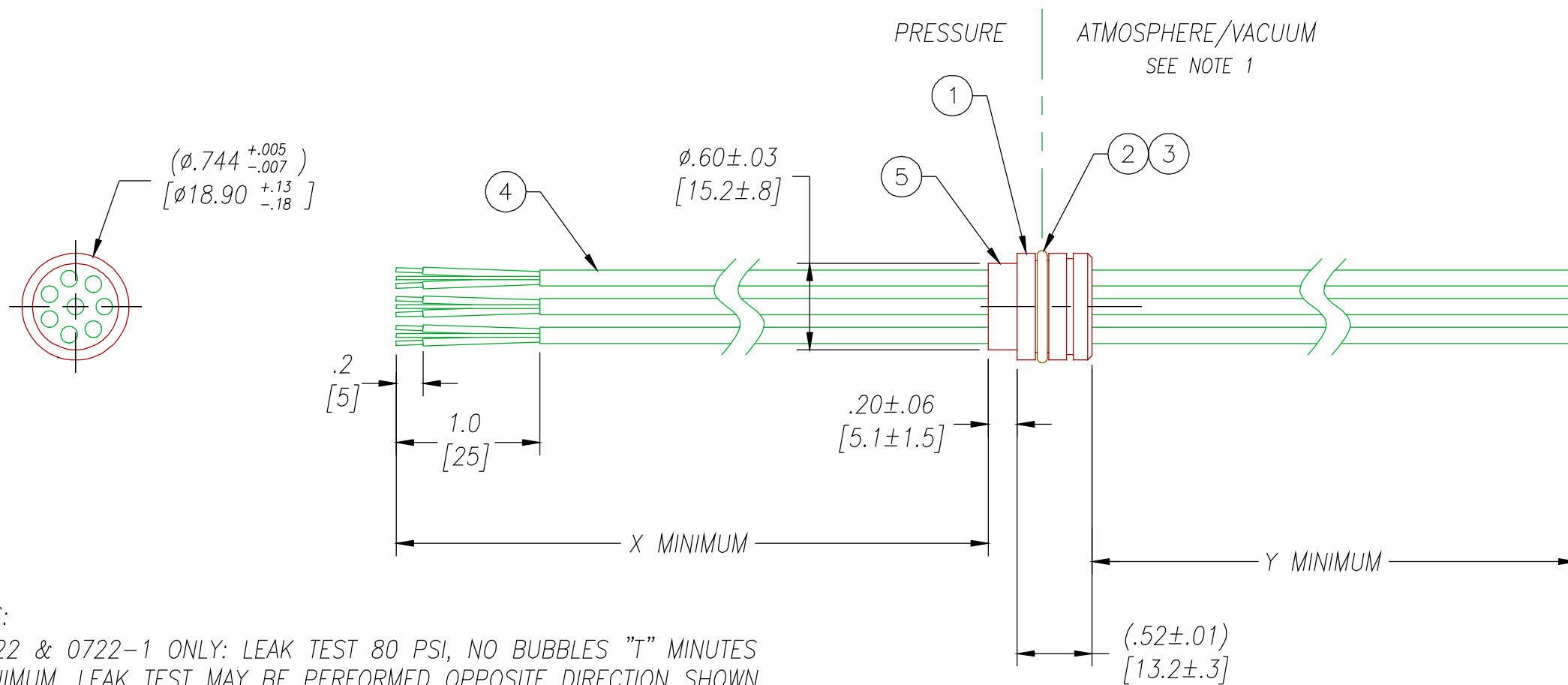

NOTES:

- 0722 & 0722-1 ONLY: LEAK TEST 80 PSI, NO BUBBLES "T" MINUTES MINIMUM. LEAK TEST MAY BE PERFORMED OPPOSITE DIRECTION SHOWN. 0722-2 ONLY: HE LEAK TEST @ 1 ATM, 1×10^{-6} CC/SEC OR LESS. A GREEN PAINT DOT INDICATES THE PART HAS PASSED THE LEAK TEST.
- HYPOT 50 VDC 20 MΩ 0.01 SEC MINIMUM, WIRE TO WIRE.
- ALL TESTS ARE PERFORMED AT ROOM TEMPERATURE.
- ALL PARTS MUST PASS ALL TESTS.
- WIRES ARE NOT REQUIRED TO BEND SHARPLY AT EPOXY SEAL SURFACE.
- COSMETIC SURFACE VOIDS NOT ON O-RING SEALING SURFACES ARE ACCEPTABLE BASED ON THE SEAL'S DIAMETER;
 $\leq .5 [12.7]$ SEAL DIAMETER: $\phi.035 [0.89]$ MAX ALLOWED VOID SIZE
 $> .5 [12.7]$ SEAL DIAMETER: $\phi.060 [1.5]$ MAX ALLOWED VOID SIZE
- REF-OPERATING TEMPERATURE RANGE -20°C TO 125°C .
- REF-PARTS ARE DEFLASHED ON PARTING LINE $+.005 [.13]$ MAXIMUM.
- DIMENSIONS ARE INCHES [millimeters].
- PAVE-SEAL CAN BE A BI-DIRECTIONAL HERMETIC SEAL FOR VACUUM AND MOST PRESSURES. FOR PRESSURES ABOVE 150 PSI (10 BAR), CHECK WITH SALES ENGINEERING.

5	A/R	PAVE-Seal 150	EPOXY BLACK
4	8	SEE TABLE	CABLE T/C 20 ANSI BX TWSH
3	A/R	SEE TABLE	SEE TABLE
2	1	-016 VITON	O-RING -016 VITON 75
1	1	4603	HOUSING SP12-E
ITEM	QTY	PART#	DESCRIPTION

ALL DIMENSIONS AND TOLERANCES APPLY TO FINISHED PART IN INCHES
ALLOWABLE TOLERANCES UNLESS SPECIFIED OTHERWISE: NONE +/-0.5
.X DECIMAL +/- 0.1 .XX DECIMAL +/- 0.02 .XXX DECIMAL +/-0.005
ANGLES +/- 1 DEG SURFACE FINISH 128 microinch RMS

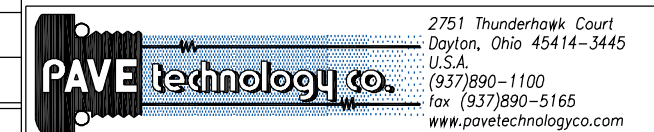

DESCRIPTION	PAVE-Seal® Cable Harnesses	*SEE TABLE
SP12-E-150-8P-BX20-X*-Y*		
PART NUMBER	*SEE TABLE	REVISION LEVEL
0722*		G
PROJECTION		