

NOTES:

1. HE LEAK TEST VACUUM  $10 \times 10^{-7}$  CC/S OR LESS. A GREEN PAINT DOT ON THE ATMOSPHERE SIDE INDICATES PART HAS PASSED THE TEST.
2. a. HYPOT 630 VDC 500 M $\Omega$  0.01 SEC MINIMUM, CENTER CONDUCTOR TO SHIELD & HOUSING (SHIELD IS FLOATING).  
b. HYPOT 2500 VAC CENTER, SHIELD, & HOUSING 0.5mA MAXIMUM LEAKAGE.
3. CONTINUITY TEST WITH MATING PLUGS <1.0  $\Omega$  MAXIMUM.
4. 50  $\Omega$  IMPEDANCE TEST  $\pm 10\%$  WITH TDR & RG-141A/U CABLE.
5. REF-TDR  $V_p=0.70$ .
6. ALL TESTS ARE PERFORMED AT ROOM TEMPERATURE.
7. ALL PARTS MUST PASS ALL TESTS.
8. PARTS ARE THERMAL CYCLED BEFORE TESTING,  $-25^\circ\text{C}$  TO  $80^\circ\text{C}$ , 3 CYCLES, 2 HOUR HOLD AT TEMPERATURE.
9. COSMETIC SURFACE VOIDS NOT ON O-RING SEALING SURFACES ARE ACCEPTABLE BASED ON THE SEAL'S DIAMETER:  
 $\leq .5$  [12.7] SEAL DIAMETER:  $\phi.035$  [.89] MAX ALLOWED VOID SIZE  
 $> .5$  [12.7] SEAL DIAMETER:  $\phi.060$  [1.5] MAX ALLOWED VOID SIZE
10. REF-OPERATING TEMPERATURE RANGE  $-20^\circ\text{C}$  TO  $150^\circ\text{C}$ .
11. DIMENSIONS ARE INCHES [millimeters].
12. PAVE-SEAL CAN BE A BI-DIRECTIONAL HERMETIC SEAL FOR VACUUM AND MOST PRESSURES. FOR PRESSURES ABOVE 150 PSI (10 BAR), CHECK WITH SALES ENGINEERING.
13. ALCOHOL OR FOMBLIN YVAC 3 MAY BE USED TO LUBRICATE O-RINGS FOR VACUUM HELIUM LEAK TESTING.

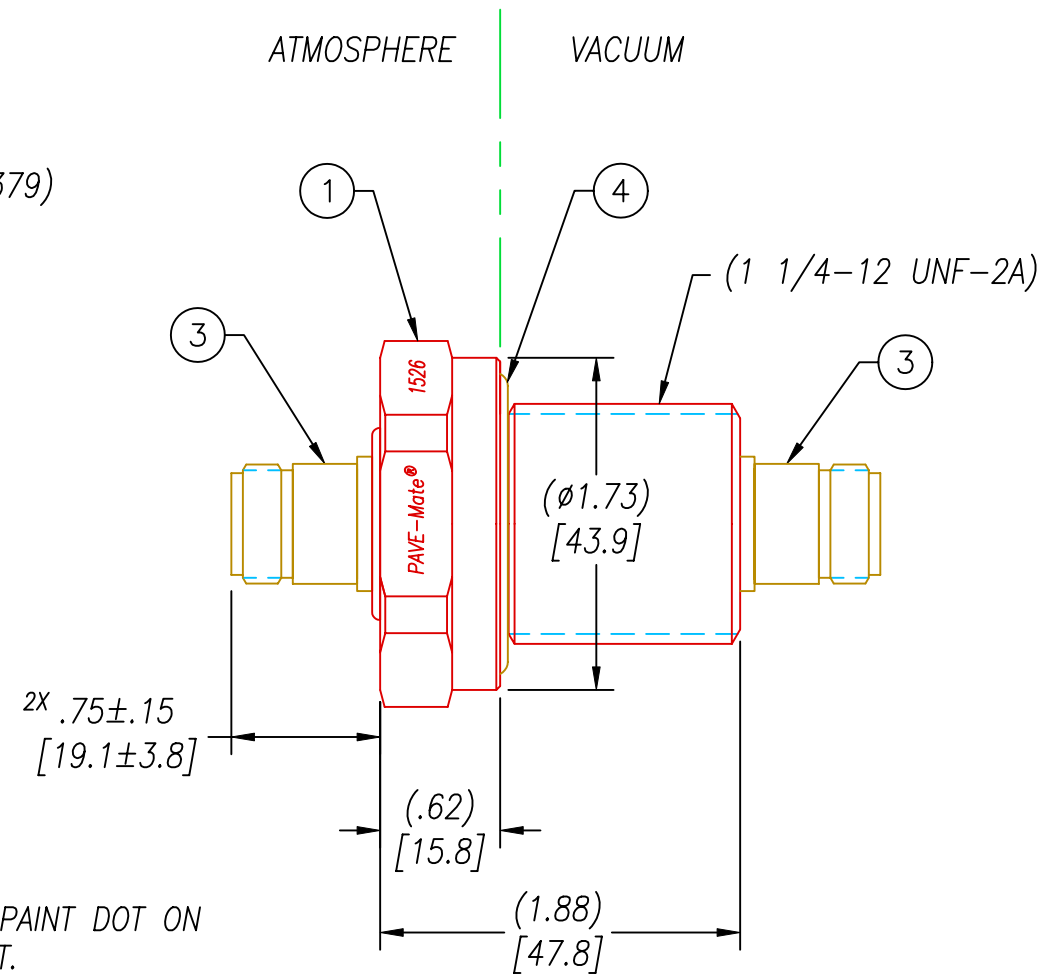

VS18 INSTALLATION PORT

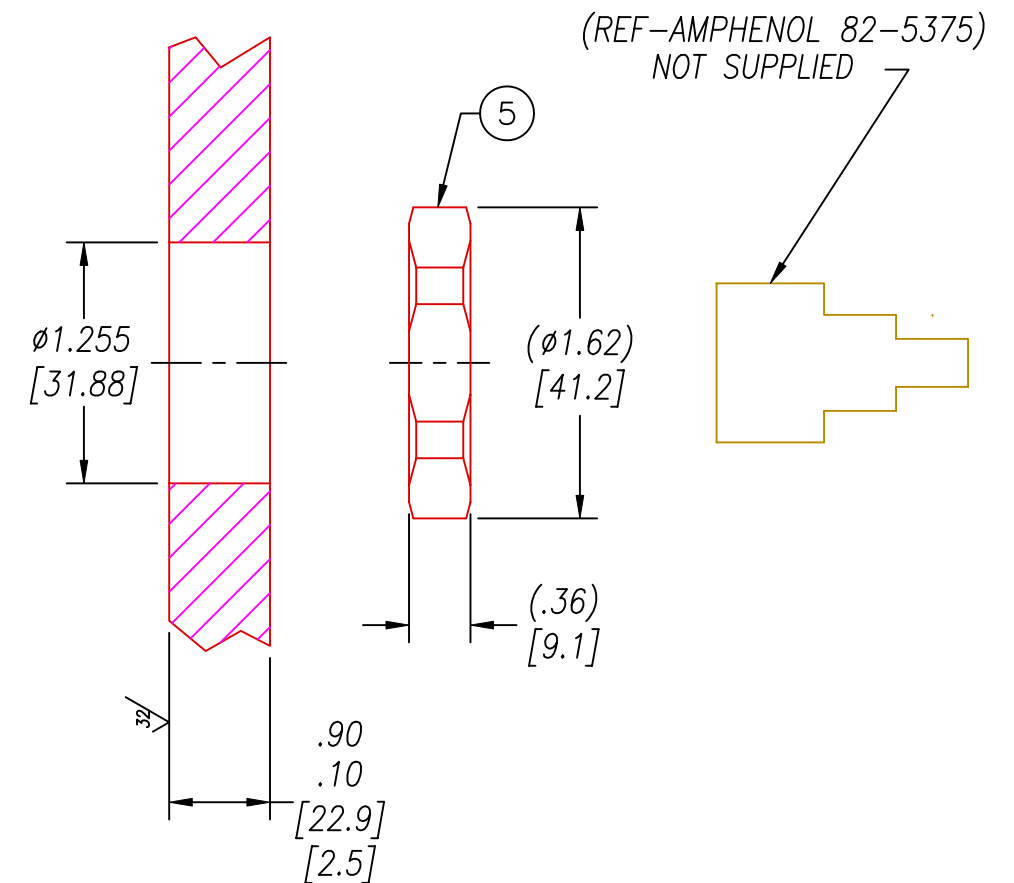

PAVE#	ITEM 1	ITEM 1 DESCRIPTION	ITEM 5	ITEM 5 DESCRIPTION	PAVE DESCRIPTION
1526	0660	HOUSING VS18-SS	1014	NUT VS18-SS	VS18-SS-200-N
1526-1	5229	HOUSING VS18-B	5231	NUT VS18-B	VS18-B-200-N

5	1	SEE TABLE	SEE TABLE
4	1	-219 VITON	O-RING -219 VITON 75
3	2	ARF1023-ND	RCPT RF TYPE N COAX
2	A/R	PAVE-Seal 200	EPOXY BLACK
1	1	SEE TABLE	SEE TABLE
ITEM	QTY	PART#	DESCRIPTION

ALL DIMENSIONS AND TOLERANCES APPLY TO FINISHED PART IN INCHES  
 ALLOWABLE TOLERANCES UNLESS SPECIFIED OTHERWISE: NONE +/-0.5  
 .X DECIMAL +/- 0.1 .XX DECIMAL +/- 0.02 .XXX DECIMAL +/-0.005  
 ANGLES +/- 1 DEG SURFACE FINISH 128 microinch RMS

2751 Thunderhawk Court  
 Dayton, Ohio 45414-3445  
 U.S.A.  
 (937)890-1100  
 fax (937)890-5165  
 www.pavetechnologyco.com

**PAVE technology co.**

DESCRIPTION PAVE-Mate® I Connectors  
**SEE TABLE (RF COAX CONN)**

PART NUMBER \*SEE TABLE  
**1526\***

REVISION LEVEL H  
 PROJECTION