

PAVE#	ITEM 11	ITEM 11 DESCRIPTION	ITEM 12	ITEM 12 DESCRIPTION
1854	-012 BUNA	O-RING -012 BUNA 75	PARKER O-LUBE	LUBRICANT O-RING BARIUM-BASED
1854-1	-012 VITON	O-RING -012 VITON 75	FOMBLIN YVAC 3	LUBRICANT O-RING FOMBLIN GREASE

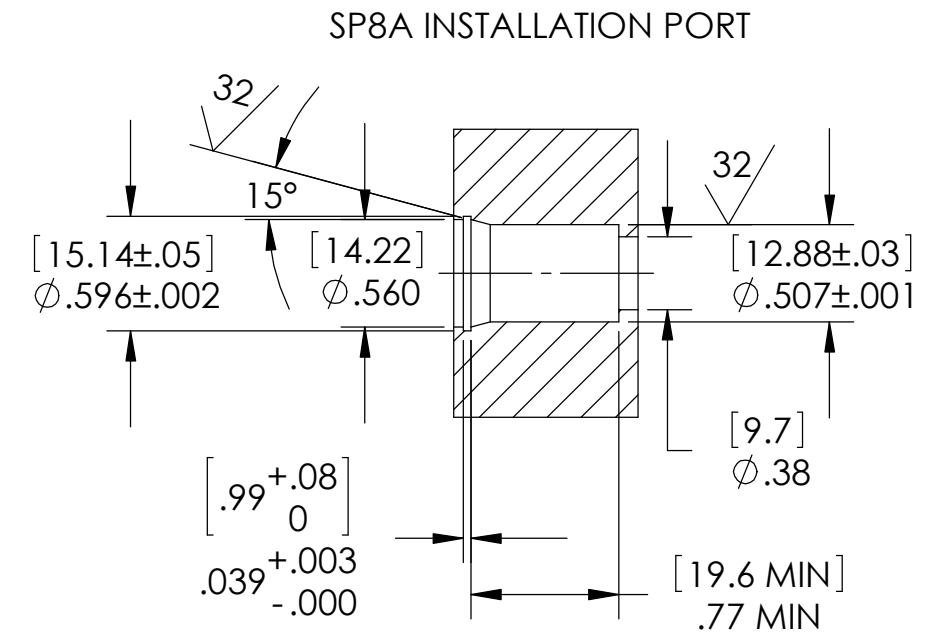
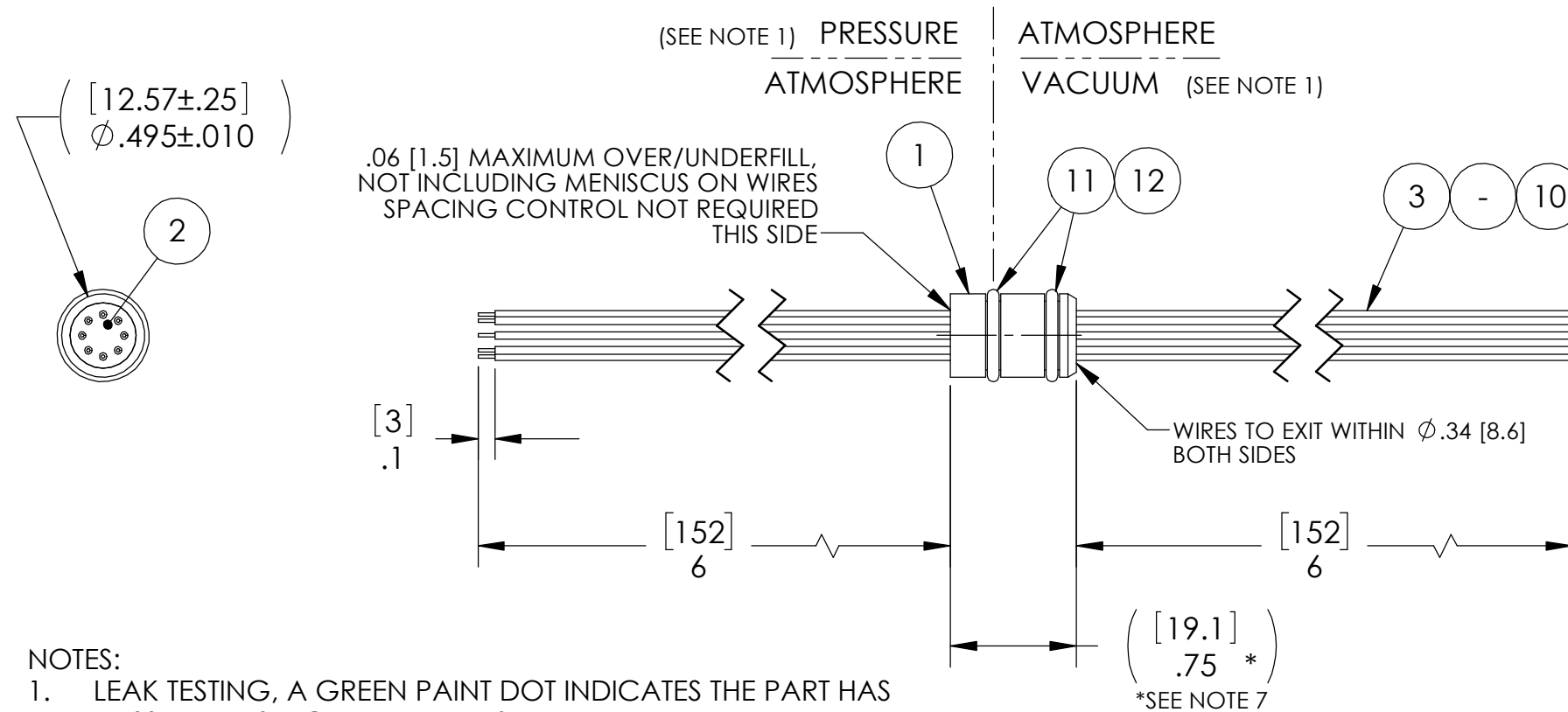

RECOMMENDED RETAINING RING
TRUARC N5000-56 OR EQUAL

NOTES:

- LEAK TESTING, A GREEN PAINT DOT INDICATES THE PART HAS PASSED THE SPECIFIED LEAK TEST.
1854 ONLY: LEAK TEST 1000 PSI, NO N2 BUBBLES 30 SECONDS MINIMUM.
1854-1 ONLY: HE LEAK TEST @ 1 ATM. 1X10⁻⁷ CC/SEC OR LESS.
- HYPOT 630 VDC 500 MEGOHMS MINIMUM 0.01 SECOND MINIMUM WIRE TO WIRE.
- ALL TESTS ARE PERFORMED AT ROOM TEMPERATURE.
- ALL PARTS MUST PASS ALL TESTS.
- WIRE POSITIONING IS APPROXIMATE & COLOR POSITIONS ARE VARIABLE.
- COSMETIC SURFACE VOIDS NOT ON O-RING SEALING SURFACES ARE ACCEPTABLE BASED ON THE SEAL'S DIAMETER:
≤ .5 [12.7] SEAL DIAMETER: ϕ .035 [.89] MAX ALLOWED VOID SIZE
> .5 [12.7] SEAL DIAMETER: ϕ .060 [1.5] MAX ALLOWED VOID SIZE
- DIMENSION IS OVER-ALL-LENGTH EXCLUDING OVERFILL ON PRESSURE SIDE OF HOUSING.
- REF-OPERATING TEMPERATURE RANGE -20 °C TO 125 °C.
- REF-PARTS ARE DEFLASHED ON PARTING LINE +0.005 [0.13] MAXIMUM.
- DIMENSIONS ARE INCHES [millimeters].
- PAVE-SEAL CAN BE A BI-DIRECTIONAL HERMETIC SEAL FOR VACUUM AND MOST PRESSURES. FOR PRESSURES ABOVE 150 PSI (10 BAR), CHECK WITH SALES ENGINEERING.

ITEM	QTY	PART NUMBER	DESCRIPTION
12	A/R	SEE TABLE	SEE TABLE
11	2	SEE TABLE	SEE TABLE
10	1	E24 YELLOW	WIRE 24E MIL-W-16878/4 7/#32
9	1	E24 VIOLET	WIRE 24E MIL-W-16878/4 7/#32
8	1	E24 ORANGE	WIRE 24E MIL-W-16878/4 7/#32
7	1	E24 GREEN	WIRE 24E MIL-W-16878/4 7/#32
6	1	E24 GRAY	WIRE 24E MIL-W-16878/4 7/#32
5	1	E24 BROWN	WIRE 24E MIL-W-16878/4 7/#32
4	1	E24 BLUE	WIRE 24E MIL-W-16878/4 7/#32
3	1	E24 BLACK	WIRE 24E MIL-W-16878/4 7/#32
2	A/R	PAVE-Seal 150	EPOXY BLACK
1	1	1226A	HOUSING SP8A-E

PAVE technology co.
2751 Thunderhawk Court
Dayton, OH 45414-3445
U.S.A.
tel (937) 890-1100
fax (937) 8905165
www.pavetechnologyco.com

DESCRIPTION
SP8A-E-150-8-TE24-6-6

PART NUMBER *SEE TABLE & NOTE 1
1854*

MATERIAL NOTED
REVISION LEVEL B

PROJECTION

ALL DIMENSIONS AND TOLERANCES APPLY TO FINISHED PART IN INCHES.
ALLOWABLE TOLERANCES UNLESS SPECIFIED OTHERWISE: NONE ±0.5
X.X DECIMAL ±0.1 X.XX DECIMAL ±0.02 X.XXX DECIMAL ±0.005
ANGLES ±1 DEGREE SURFACE FINISH 128 microinch RMS