

2X -015 O-RING GROOVE DETAIL

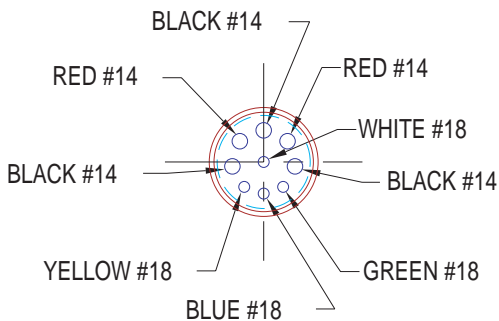

WIRE POSITIONS SHOWN  
IN APPROXIMATE LOCATION

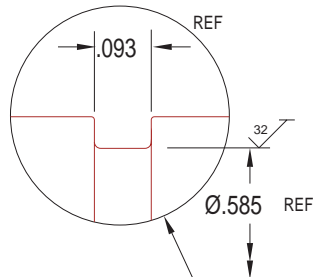
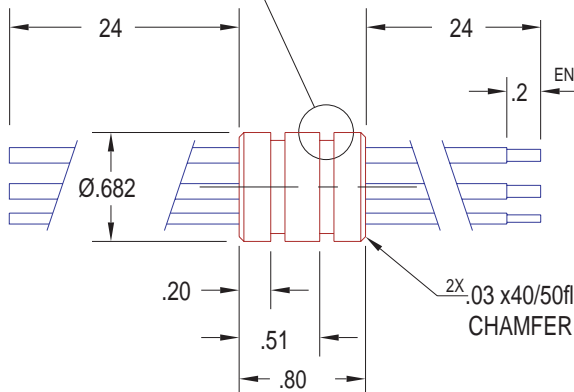

PRESSURE SIDE

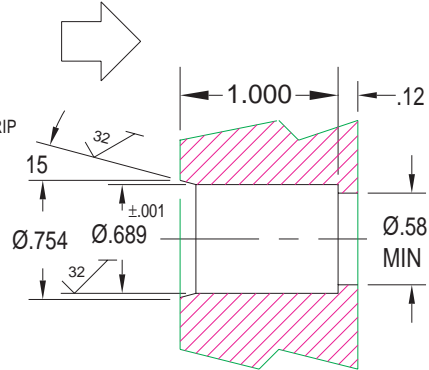

LEAK TEST PORT  
SCALE 1=1

NOTES:

1. #18= 18 AWG TEFLON TYPE E WIRE (REF- Ø=.069)
2. #14= 14 AWG TEFLON TYPE E WIRE (REF- Ø=.098)
3. (2) O-RINGS -015 NITRILE 70 DURO INSTALLED W/ PARKER O-LUBE
4. ELECTRICAL TEST @ 630 VDC FOR 500 MEGOHMS FOR .01S BETWEEN WIRES.
5. LEAK TEST @ 80 PSI AIR FOR 2 MINUTES WITH LESS THAN .0001 cc/s BUBBLING.

ALL DIMENSIONS AND TOLERANCES APPLY TO FINISHED PART IN INCHES  
ALLOWABLE TOLERANCES UNLESS SPECIFIED OTHERWISE: NONE +/- .5  
.X DECIMAL +/- .1 .XX DECIMAL +/- .02 .XXX DECIMAL +/- .005  
ANGLES +/- 1 DEG SURFACE FINISH 128 microinch RMS

PAVE technology co.

2751 Thunderhawk Court  
Dayton, Ohio 45414-3445  
U.S.A.  
(937)890-1100  
fax (937)890-5165  
www.pavetechnologyco.com

DESCRIPTION

SP11-E-4/5-TE18/14-24-24

PART NUMBER

1130

PROJECTION

