

**X31 CONNECTOR
PINOUT DIAGRAM**

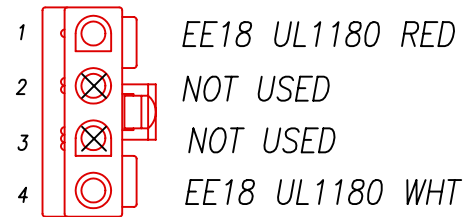

X32 CONNECTOR PINOUT DIAGRAM

- 1-TEF 2/C #20 STW (BLACK)
- 2-TEF 2/C #20 STW (WHITE)
- 3-EE18 UL1180 GRN
- 4-EE18 UL1180 BLU
- 5-TEF 2/C #20 STW (SHIELD)
- 6-9700K51-2014 (BLACK LEAD)
- 7-NOT USED
- 8-9700K51-2014 (BLACK LEAD)

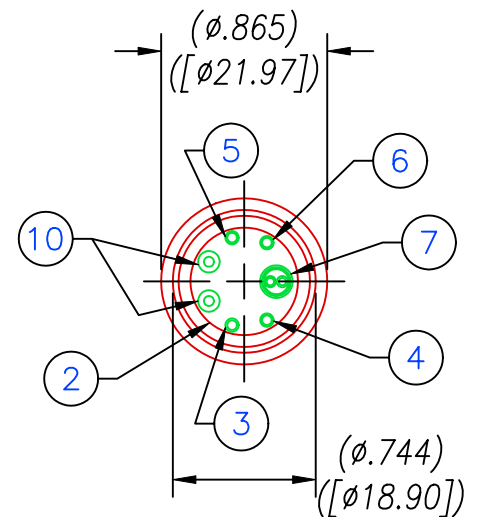
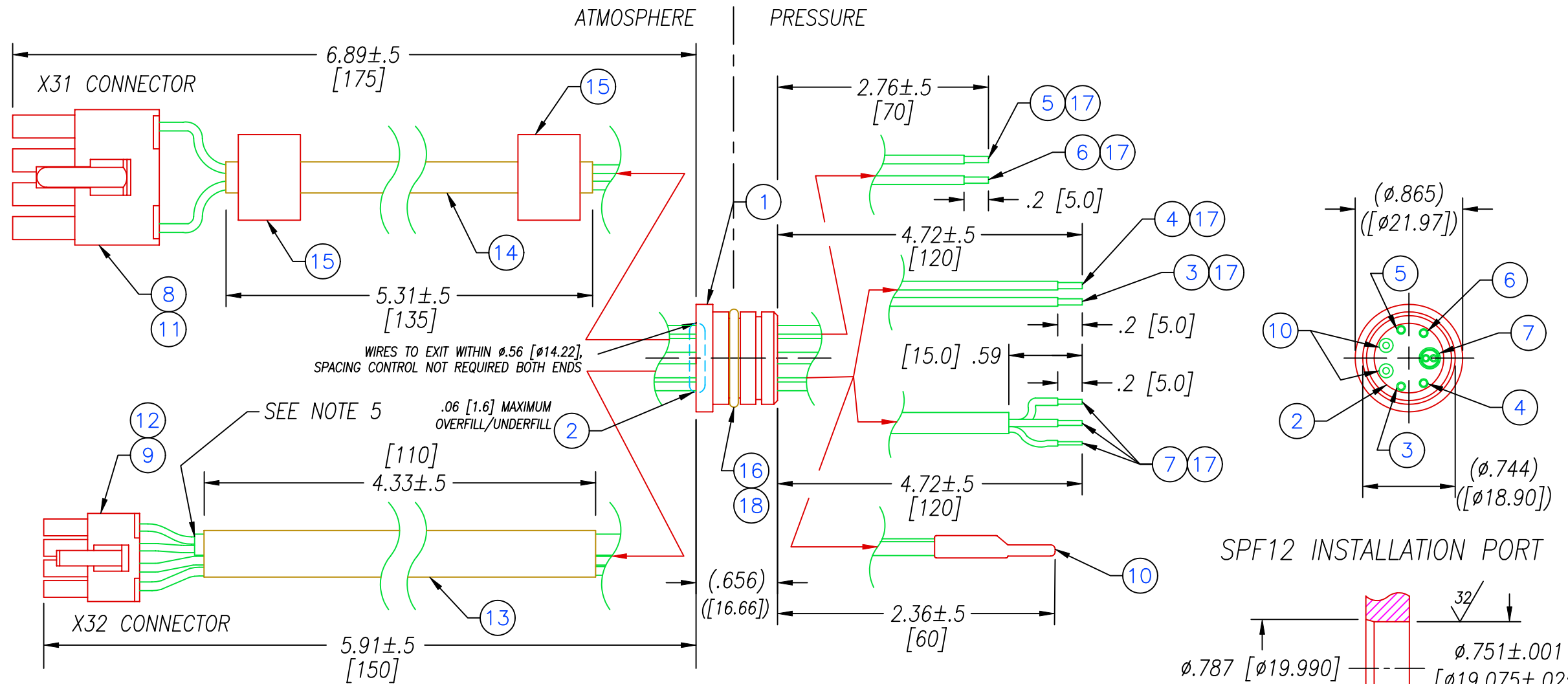
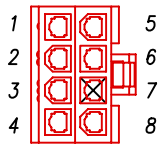

SPF12 INSTALLATION PORT

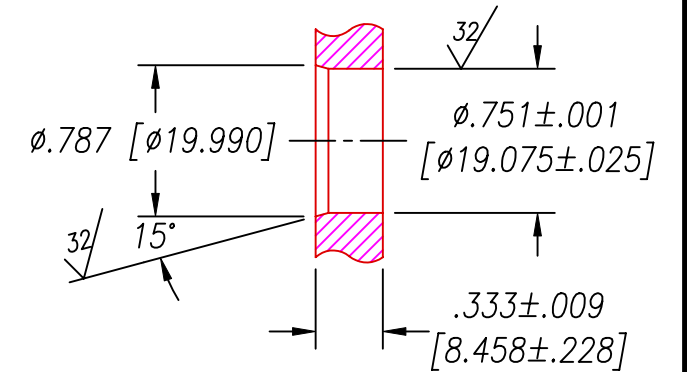

RECOMMENDED RETAINING RING
TRUARC #5100-75 OR EQUAL

18	A/R	PARKER O-LUBE	LUBRICANT O-RING BARIUM BASED
17	A/R	SAC305	SOLDER SAC305 FAST CORE
16	1	-016 VITON	O-RING -016 VITON 75
15	2	74270091	FERRITE AXIAL BEADS
14	1	MIL-I-631D 1/4"	TUBING, MIL-I-631D TYPE F, FORM U GRADE C CLASS 1 & 2, CATAGORY 1
13	1	MIL-I-631D 3/8"	TUBING, MIL-I-631D TYPE F, FORM U GRADE C CLASS 1 & 2, CATAGORY 1
12	7	MOLEX39-00-0059	TERMINAL 18-24AWG SOC
11	2	MOLEX02-09-1102	11-18-2143 TERM INST
10	1	9700K51-2014	THERMAL SWITCH INSTIMAG
9	1	MOL39-01-2080	RCPT 8 POSITION
8	1	MOL#19-09-1049	RCPT 4 POS.
7	1	TEF 2/C #20 STW	CABLE ASTRO #CNE4-02-STW-2019-011
6	1	EE18 UL1180 WHT	WIRE 18EE UL1180 .014 7/#26
5	1	EE18 UL1180 RED	WIRE 18EE UL1180 .014 7/#26
4	1	EE18 UL1180 GRN	WIRE 18EE UL1180 .014 7/#26
3	1	EE18 UL1180 BLU	WIRE 18EE UL1180 .014 7/#26
2	A/R	PAVE-Seal 150	EPOXY BLACK
1	1	0130	HOUSING SPF12-E
ITEM	QTY	PART#	DESCRIPTION

NOTES:

1. LEAK TEST: 80 PSI, NO BUBBLES 30 SECONDS MIN. A GREEN PAINT DOT INDICATES THE PART HAS PASSED THE TEST.
2. HYPOT 630 VDC 500 MΩ 0.01 SEC MINIMUM, WIRE TO WIRE WITH MATING PLUGS.
3. MEGGER TEST 4.5k VDC, 100 MΩ MIN, ALL WIRES SHORTED ON X31 TO ALL WIRES SHORTED ON X32.
4. CONTINUITY TEST: CONNECTORS TO ENDS OF WIRES, <0.5 Ω.
5. INSPECT FOR NICKED WIRE INSULATION FROM JACKET STRIP, BOTH ENDS.
6. ALL TESTS ARE PERFORMED AT ROOM TEMPERATURE.
7. ALL PARTS MUST PASS ALL TESTS.
8. WIRES ARE NOT REQUIRED TO BEND SHARPLY AT EPOXY SEAL SURFACE.
9. NO COSMETIC SURFACE VOIDS ARE ACCEPTABLE ON O-RING SEALING SURFACES, COSMETIC SURFACE VOIDS SMALLER THAN φ.035 [.89] ARE ACCEPTABLE ON ALL OTHER SURFACES.
10. DIMENSIONS ARE INCHES [millimeters].
11. REF-OPERATING TEMPERATURE -20°C TO 105°C.

ALL DIMENSIONS AND TOLERANCES APPLY TO FINISHED PART IN INCHES
ALLOWABLE TOLERANCES UNLESS SPECIFIED OTHERWISE: NONE +/-0.5
.X DECIMAL +/- 0.1 .XX DECIMAL +/- 0.02 .XXX DECIMAL +/-0.005
ANGLES +/- 1 DEG SURFACE FINISH 128 microinch RMS

2751 Thunderhawk Court
Dayton, Ohio 45414-3445
U.S.A.
(937)890-1100
fax (937)890-5165
www.pavetechnologyco.com

PAVE technology co.

DESCRIPTION PAVE-Seal Cable Harnesses
SPF12-E-150-4/1/1-TEE18/2C20/TI-*-*

PART NUMBER 1136

REVISION LEVEL S

PROJECTION