

PAVE#	"X"
1529	12 [305]
1529-1	36 [914]

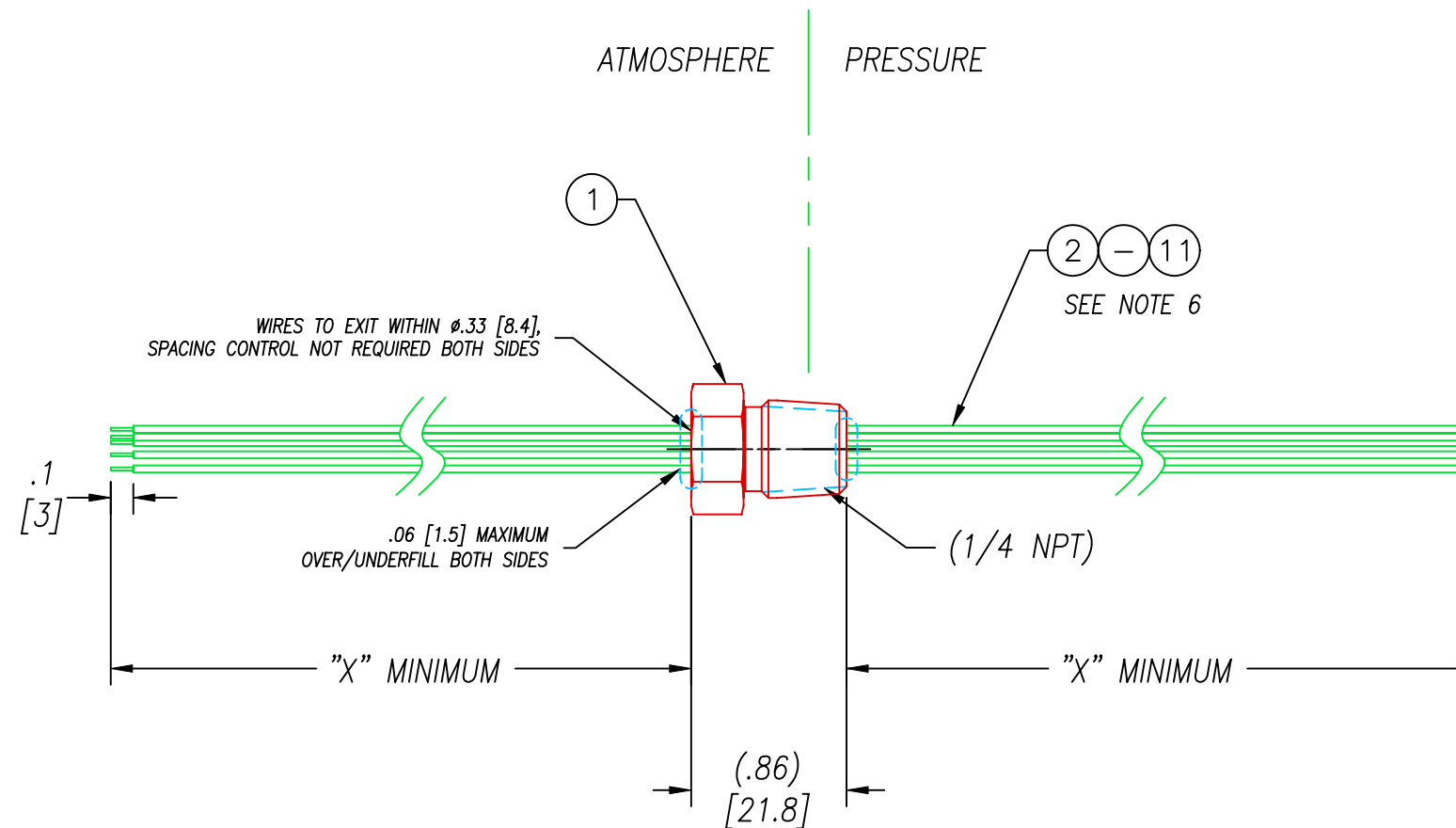
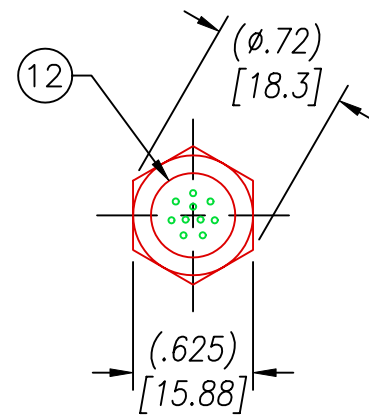

NOTES:

1. LEAK TEST: 300 PSI, NO BUBBLES 1 MINUTE MINIMUM.
2. HYPOT 630 VDC 500 MΩ 0.01 SEC MINIMUM, WIRE TO WIRE & HOUSING.
3. ALL TESTS ARE PERFORMED AT ROOM TEMPERATURE.
4. ALL PARTS MUST PASS ALL TESTS.
5. WIRES ARE NOT REQUIRED TO BEND SHARPLY AT EPOXY SEAL SURFACE.
6. WIRE COLOR POSITIONS MAY VARY.
7. VOIDS LARGER THAN $\phi.035$ [.89] ARE NOT ACCEPTABLE.
8. REF-OPERATING TEMPERATURE RANGE -20°C TO 125°C .
9. DIMENSIONS ARE INCHES [millimeters].
10. PAVE-SEAL CAN BE A BI-DIRECTIONAL HERMETIC SEAL FOR VACUUM AND MOST PRESSURES. FOR PRESSURES ABOVE 150 PSI (10 BAR), CHECK WITH SALES ENGINEERING.

12	A/R	PAVE-Seal 150	EPOXY BLACK
11	1	E26 PURPLE	WIRE 26E MIL-W-16878/4 7/#34
10	1	E26 GREEN	WIRE 26E MIL-W-16878/4 7/#34
9	1	E26 RED	WIRE 26E MIL-W-16878/4 7/#34
8	1	E26 WHITE	WIRE 26E MIL-W-16878/4 7/#34
7	1	E26 BLUE	WIRE 26E MIL-W-16878/4 7/#34
6	1	E26 YELLOW	WIRE 26E MIL-W-16878/4 7/#34
5	1	E26 GRAY	WIRE 26E MIL-W-16878/4 7/#34
4	1	E26 ORANGE	WIRE 26E MIL-W-16878/4 7/#34
3	1	E26 BROWN 7 STR	WIRE 26E MIL-W-16878/4 7/#34
2	1	E26 BLACK 7STRD	WIRE 26E MIL-W-16878/4 7/#34
1	1	3301	HOUSING PT4-SS
ITEM	QTY	PART#	DESCRIPTION



DESCRIPTION	PAVE-Seal® Cable Harnesses	
	PT4-SS-150-10-TE26-X-X	
PART NUMBER	*SEE TABLE	REVISION LEVEL
1529*		C
	PROJECTION	

ALL DIMENSIONS AND TOLERANCES APPLY TO FINISHED PART IN INCHES
ALLOWABLE TOLERANCES UNLESS SPECIFIED OTHERWISE: NONE ± 0.5
.X DECIMAL ± 0.1 .XX DECIMAL ± 0.02 .XXX DECIMAL ± 0.005
ANGLES ± 1 DEG SURFACE FINISH 128 microinch RMS