

PRESSURE | ATMOSPHERE

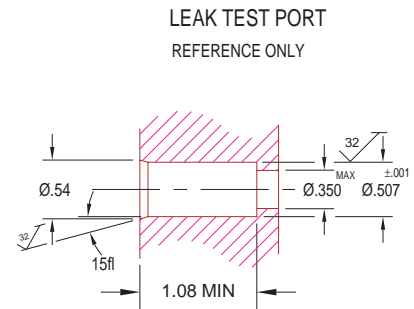
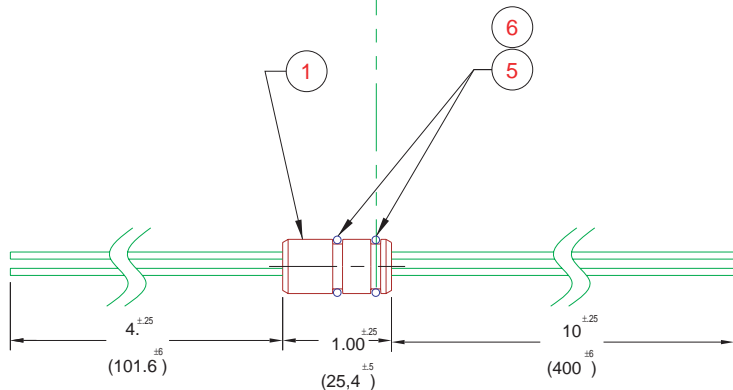
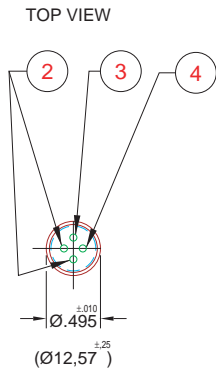

NOTES:

1. LEAK TEST: 80 PSI, NO BUBBLES 2 MINUTES MIN.
2. HYPOT 630 VDC 500 MEGOHMS .01 SEC MINIMUM, WIRE TO WIRE.
3. ALL TESTS ARE DONE AT ROOM TEMPERATURE.
4. THESE SPECIFICATIONS SUPERSEDE PAVE CATALOG.
5. WIRE POSITIONS IN TOP VIEW ARE REFERENCE ONLY.

6	A/R	SUPER-O-LUBE	LUBRICANT O-RING SILICONE BASED
5	2	-012 VITON	O-RING -012 VITON 75
4	1.25'	PC18 UL1569 RED	WIRE 18PC UL1569 .016 7/#26
3	1.25'	PC18 UL1569 BLK	WIRE 18PC UL1569 .016 7/#26
2	2.5'	PC18 UL1569W/BL	WIRE 18PC UL1569 .016 7/#26
1	1	1226 SP8L	HOUSING SP8L- E
ITEM	QTY	PART#	DESCRIPTION

ALL DIMENSIONS AND TOLERANCES APPLY TO FINISHED PART IN INCHES  
 ALLOWABLE TOLERANCES UNLESS SPECIFIED OTHERWISE: NONE +/- .5  
 .X DECIMAL +/- .1 .XX DECIMAL +/- .02 .XXX DECIMAL +/- .005  
 ANGLES +/- 1 DEG SURFACE FINISH 128 microninch RMS



DESCRIPTION  
**SP8L-E-150-4-PC18-4-10**

PART NUMBER  
**1714**

