

RECOMMENDED PANEL CUTOUT REF ONLY

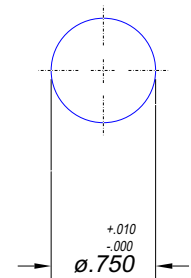

NOTES:

1. HE LEAK TEST @1 ATM. 10^{-8} CC/S AIR EQUIVALENT. (AIR EQUIVALENT LEAK RATE/2.73 = ACTUAL He LEAK RATE)
2. HYPOT 630 VDC 500 MEGOHMS .01 SEC MINIMUM, WIRE TO WIRE & HOUSING.
3. ALL HOUSING DIMENSIONS FOR REFERENCE ONLY.
4. REF - ERNEST F. FULLAM CONFIGURATION D.
5. SHIELD CONTINUITY END TO END NOT REQUIRED.

6	A/R	PAVE-Seal 150	EPOXY
5	2@14	CABLE 4/C #22	CABLE 4/C #E22
4	A/R	SUPER-O-LUBE	LUBRICANT O-RING SILICONE
3	1	-116 VITON	O-RING -116 VITON 75
2	1	8L5N-SS	NUT VS12-SS
1	1	1180	HOUSING VS12L-SS
ITEM	QTY	PART #	DESCRIPTION

ALL DIMENSIONS AND TOLERANCES APPLY TO FINISHED PART IN INCHES
 ALLOWABLE TOLERANCES UNLESS SPECIFIED OTHERWISE: NONE +/- .5
 X DECIMAL +/- .1 .XX DECIMAL +/- .02 .XXX DECIMAL +/- .005
 ANGLES +/- 1 DEG SURFACE FINISH 128 microinch RMS



DESCRIPTION
VS12L-SS-150-2-CABLE 4/#22-6-6

PART NUMBER

1800

PROJECTION

