

PAVE LEAK TEST PORT CONFIGURATION  
SEE NOTE 5 & 6

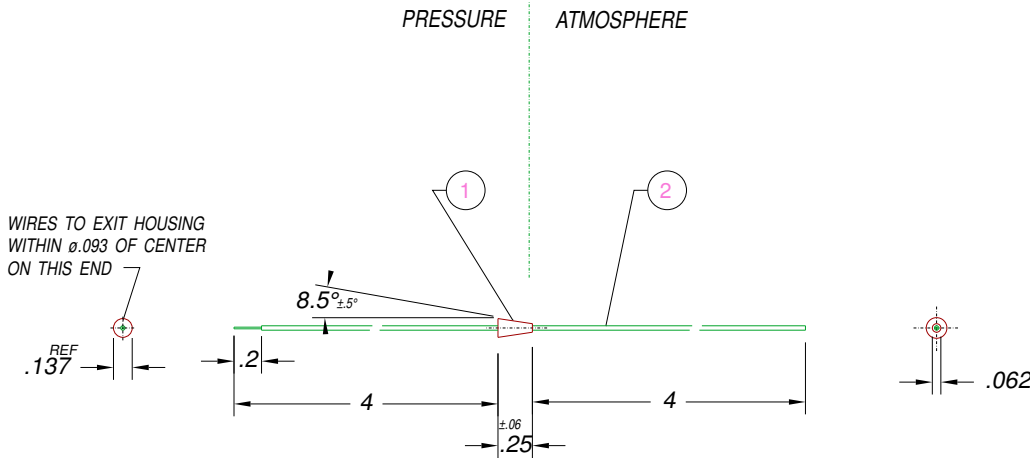

INSTALLATION BORE  
CONFIGURATION  
SHOWN FOR REF ONLY  
SEE NOTE 5, 6, 7, & 8

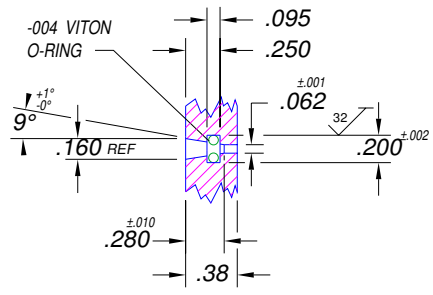
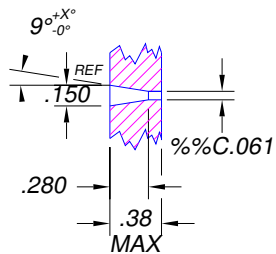

- NOTES:
1. LEAK TEST: 3000 PSI, NO BUBBLES, 2 MINUTES MIN.
  2. HYPOT 300 VDC 250 MEGOHMS .01 SEC MINIMUM, WIRE TO LEAK TEST PORT.
  3. ALL TESTS ARE DONE AT ROOM TEMPERATURE.
  4. THESE SPECIFICATIONS SUPERSEDE PAVE CATALOG.
  5. REF-TAPERED BORE MAY BE MADE USING 10° PER SIDE TAPERED BORE MAY BE MADE USING 10° PER SIDE TAPERED END MILL, 1/8" TIP, MODIFIED TO %%C.060±.001.
  6. PAVE TO GRIT BLAST & CLEAN PART AFTER LEAK TESTING FOR CUSTOMER ADHESIVE BONDING.
  7. ROUGH UP TAPERED BORE FOR ADHESIVE BOND.
  8. X° TOLERANCE BASED ON CUSTOMERS NEED TO SEAL PART IN PORT WITH ADHESIVE.

2	1@9"	N20-38B-100-2	WIRE 30PC EXTRA FLEXIBLE 7/38 BLACK
1	A/R	PAVESeal 150	EPOXY BLACK
ITEM	QTY	PART#	DESCRIPTION

ALL DIMENSIONS AND TOLERANCES APPLY TO FINISHED PART IN INCHES  
ALLOWABLE TOLERANCES UNLESS SPECIFIED OTHERWISE: NONE +/- .5  
.X DECIMAL +/- .1 .XX DECIMAL +/- .02 .XXX DECIMAL +/- .005  
ANGLES +/- 1 DEG SURFACE FINISH 128 microinch RMS

PAVE Technology CO.  
2751 Thunderhawk Court  
Dayton, Ohio 45414-3445  
U.S.A.  
(937)890-1100  
fax (937)890-5165  
www.pave technologyco.com

DESCRIPTION PAVE-Seal® Cable Harnesses  
**TP1-E-150-1-PC30-4-4**

PART NUMBER  
**2073**

PROJECTION