

INSTALLATION PORT
RECOMMEND TRUARC N5000-77

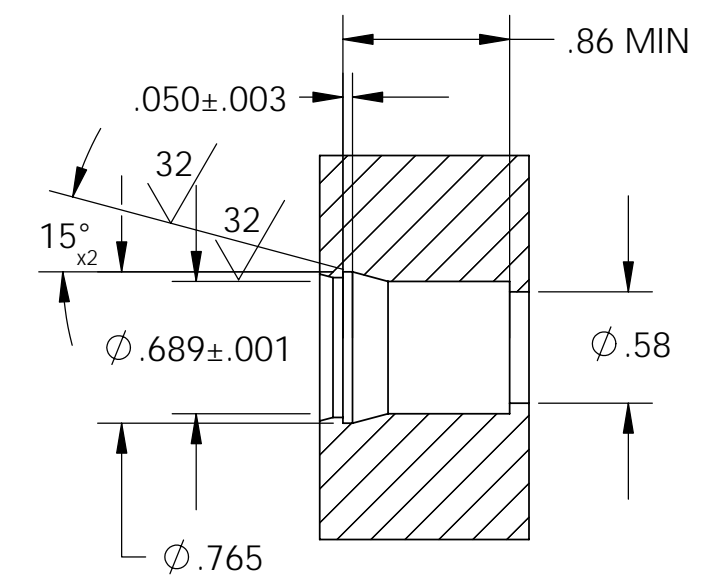

NOTES:

1. LEAK TEST: 120 PSI, NO BUBBLES 2 MINUTES MINIMUM.
2. HYPOT 630 VDC 500 MEGAOHMS MINIMUM 0.01 SECOND MINIMUM WIRE TO WIRE AND SHIELD.
3. ALL TESTS ARE PERFORMED AT ROOM TEMPERATURE.
4. PERCENTAGE OF PARTS TESTED WILL BE 100% (MAY BE A LESSER PERCENTAGE FOR LARGE PRODUCTION QUANTITIES, UNLESS OTHERWISE NOTED OR REQUIRED).
5. WIRES ARE NOT REQUIRED TO BEND SHARPLY AT EPOXY SEAL SURFACE.

5	3	TEF 2/C #20 STW	CABLE ASTRO #CME4-02-STW-2019-011
4	A/R	PAVE-Seal 150	EPOXY BLACK
3	A/R	PARKER O-LUBE	LUBRICANT O-RING BARIUM BASED
2	2	-015 VITON	O-RING -015 VITON 75
1	1	1374-M	HOUSING SP11M-E
ITEM	QTY	PART NUMBER	DESCRIPTION

ALL DIMENSIONS AND TOLERANCES APPLY TO FINISHED PART IN INCHES.
ALLOWABLE TOLERANCES UNLESS SPECIFIED OTHERWISE: NONE ±0.5
X.X DECIMAL ±0.1 X.XX DECIMAL ±0.02 X.XXX DECIMAL ±0.005
ANGLES ±1 DEGREE SURFACE FINISH 128 microinch RMS

PAVE technology co.
2751 Thunderhawk Court
Dayton, OH 45414-3445
U.S.A.
tel (937) 890-1100
fax (937) 8905165
www.pavetechnologyco.com

DESCRIPTION
SP11M-E-150-3TSP-TE20-48-96

PART NUMBER
2775

REVISION LEVEL
-

PROJECTION
⊙ ◁