

SO16 INSTALLATION PORT

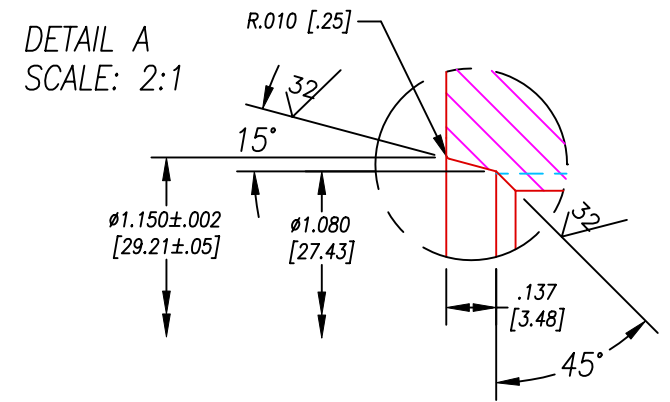
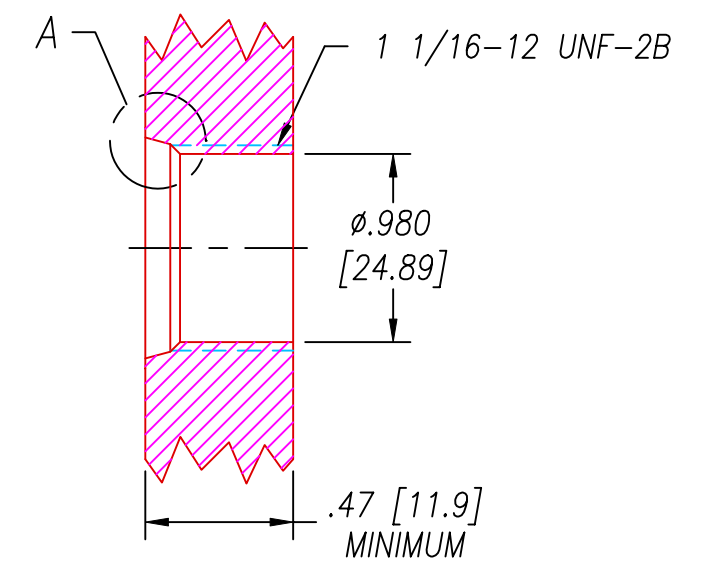

NOTES:

1. LEAK TEST: 80 PSI, NO BUBBLES 2.5 MINUTES MINIMUM.
2. HYPOT 630 VDC 500 MΩ 0.01 SEC MINIMUM, WIRE TO WIRE & HOUSING.
3. ALL TESTS ARE PERFORMED AT ROOM TEMPERATURE.
4. ALL PARTS MUST PASS ALL TESTS.
5. WIRES ARE NOT REQUIRED TO BEND SHARPLY AT EPOXY SEAL SURFACE.
6. NO VOIDS LARGER THAN $\phi.035$ [.89] ARE ACCEPTABLE.
7. DIMENSIONS ARE INCHES [millimeters].

5	2	EE8 BLACK	WIRE 8EE MIL-W-16878/5 133/#29
4	A/R	PAVE-Seal 200	EPOXY BLACK
3	A/R	PARKER-O-LUBE	LUBRICANT O-RING BARIUM-BASED
2	1	-912 VITON 75A	O-RING -912 VITON 75A
1	1	1386	HOUSING SO16-SS
ITEM	QTY	PART#	DESCRIPTION

ALL DIMENSIONS AND TOLERANCES APPLY TO FINISHED PART IN INCHES
 ALLOWABLE TOLERANCES UNLESS SPECIFIED OTHERWISE: NONE +/-0.5
 .X DECIMAL +/- 0.1 .XX DECIMAL +/- 0.02 .XXX DECIMAL +/-0.005
 ANGLES +/- 1 DEG SURFACE FINISH 128 microinch RMS

PAVE technology co.
 2751 Thunderhawk Court
 Dayton, Ohio 45414-3445
 U.S.A.
 (937)890-1100
 fax (937)890-5165
 www.pavetechnologyco.com

DESCRIPTION **PAVE-Mate® I Connectors**
S016-SS-200-2-TEE8-36-18

PART NUMBER **2782**

REVISION LEVEL **A**

PROJECTION