

NOTES:

1. LEAK TEST: 80 PSI, NO BUBBLES 2.5 MINUTES MINIMUM.
2. HYPOT 630 VDC 500 MΩ 0.01 SEC MINIMUM, WIRE TO WIRE & HOUSING.
3. ALL TESTS ARE PERFORMED AT ROOM TEMPERATURE.
4. ALL PARTS MUST PASS ALL TESTS.
5. WIRES ARE NOT REQUIRED TO BEND SHARPLY AT EPOXY SEAL SURFACE.
6. NO VOIDS LARGER THAN $\phi.035$ [.89] ARE ACCEPTABLE.
7. WIRE COLOR POSITIONS ARE APPROXIMATE & VARIABLE.
8. DIMENSIONS ARE INCHES [millimeters].

6	5	EE18 MIL WHITE	WIRE 18EE MIL-W-16878/5 .015 7/#26
5	5	EE18 MIL BLK	WIRE 18EE MIL-W-16878/5 .015 7/#26
4	A/R	PAVE-Seal 200	EPOXY BLACK
3	A/R	PARKER O-LUBE	LUBRICANT O-RING BARIUM-BASED
2	1	-912 VITON 75A	O-RING -912 VITON 75A
1	1	1386	HOUSING S016-SS
ITEM	QTY	PART#	DESCRIPTION

ALL DIMENSIONS AND TOLERANCES APPLY TO FINISHED PART IN MM
 ALLOWABLE TOLERANCES UNLESS SPECIFIED OTHERWISE: NONE +/- .13
 X.X DECIMAL +/- .25 X.XX DECIMAL +/- .050 X.XXX DECIMAL +/- .0100
 ANGLES +/- 1 DEG SURFACE FINISH 3.2 micrometers RMS

S016 INSTALLATION PORT

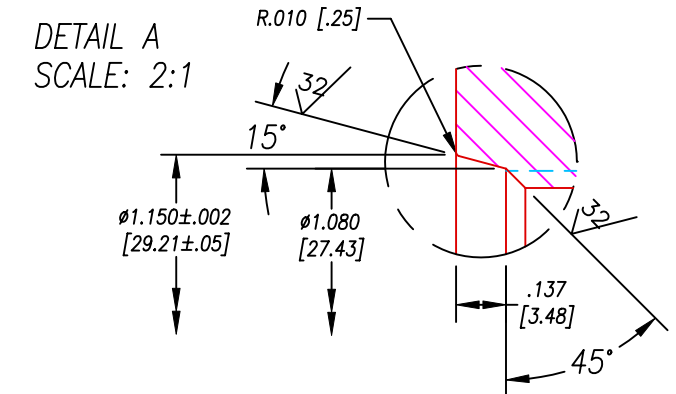
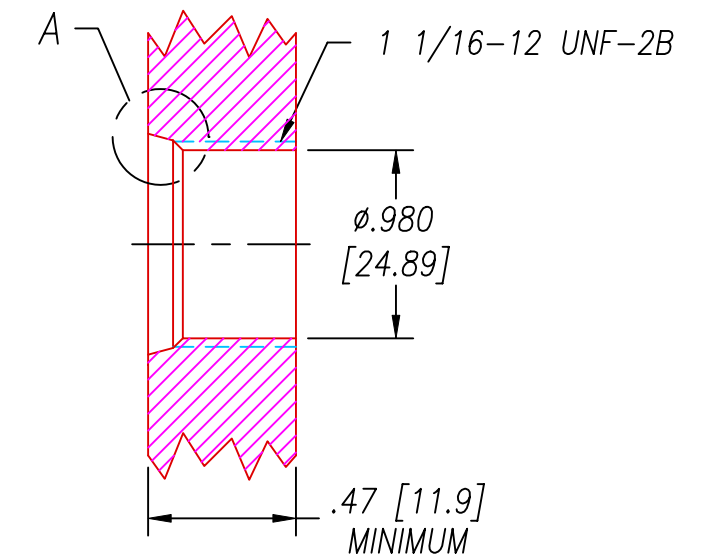

PAVE technology co.
 2751 Thunderhawk Court
 Dayton, Ohio 45414-3445
 U.S.A.
 (937)890-1100
 fax (937)890-5165
 www.pavetechnologyco.com

DESCRIPTION PAVE-Mate@I Connectors
S016-SS-200-10-TEE18-36-18

PART NUMBER
2783

REVISION LEVEL
A
 PROJECTION