

SPF12 INSTALLATION PORT

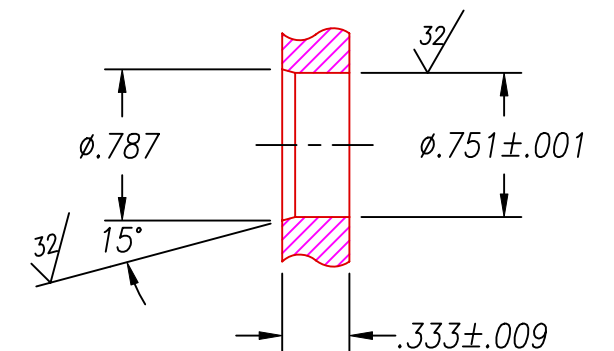

RECOMMENDED RETAINING RING  
TRUARC #5100-75 OR EQUAL

NOTES:

1. HE LEAK TEST @1 ATM.  $10 \times 10^{-8}$  CC/S OR LESS. CLEAN O-RING WITH METHANOL BEFORE INSERTING INTO TEST PORT.
2. HYPOT 630 VDC 500 MΩ 0.01 SEC MINIMUM, WIRE TO WIRE & INSTALLATION PORT.
3. ALL TESTS ARE DONE AT ROOM TEMPERATURE & HUMIDITY.
4. ALL PARTS MUST PASS ALL TESTS.
5. O-RING TO BE SHIPPED DRY, NO O-LUBE ALLOWED.
6. CONTINUOUS CONTACT OF METHANOL TO VITON O-RING WILL CAUSE O-RING TO SWELL AND NOT SEAL PROPERLY.
7. "PAVE" & "2823" MARKINGS APPROXIMATELY AS SHOWN.
8. CONTINUITY TEST < 14 mΩ END OF MATING CONNECTOR TO END OF EACH WIRE OR TERMINAL.
9. LABEL W/"BEAM STEER X4", "1016858/C", "PAV".
10. LABEL W/INFORMATION SPECIFIED, ALL LABELS TO BE INSTALLED SO THAT ALL INFORMATION ON LABEL IS VISIBLE.
11. PACKAGE ASSEMBLY INDIVIDUALLY IN A PLASTIC BAG AND INCLUDE "1016858 REV:C" ON BAG LABEL.
12. NO VOIDS ARE ACCEPTABLE ON O-RING SEALING SURFACES, VOIDS SMALLER THAN 0.035 ARE ACCEPTABLE ON ALL OTHER SURFACES.
13. WIRE COLOR POSITIONS EXITING EPOXY MAY VARY.

WIRING CHART

FROM	ITEM #/COLOR	TO	ITEM #/COLOR	SIGNAL	'X'
ITEM 14 PIN 1	ITEM 8/RED	ITEM 13	ITEM 4/RED	X4	5.00
ITEM 14 PIN 2	ITEM 9/ORANGE	ITEM 13	ITEM 5/ORANGE	X4 GND	4.00
ITEM 14 PIN 3	ITEM 10/YELLOW	ITEM 13	ITEM 6/YELLOW	Y4	3.75
ITEM 14 PIN 4	ITEM 11/GREEN	ITEM 13	ITEM 7/GREEN	Y4 GND	6.00

ITEM	QTY	PART#	DESCRIPTION
15	4	AMP #350689-1	SOCKET MATE-N-LOK
14	1	AMP #350779-1	PLUG MATE-N-LOC 4 PIN
13	4	CRS-TO-2202	TERMINAL RING #2 26-24 AWG
12	2	-	PRINTABLE LABEL
11	1	PTFE20 GRN	WIRE PTFE #20 UL1199 19 STRAND
10	1	PTFE20 YELLOW	WIRE PTFE #20 UL1199 19 STRAND
9	1	PTFE20 ORANGE	WIRE PTFE #20 UL1199 19 STRAND
8	1	PTFE20 RED	WIRE PTFE #20 UL1199 19 STRAND
7	1	E20 SOLID GRN	WIRE 20E UL1213 SOLID CONDUCTOR
6	1	E20 SOLID YLW	WIRE 20E UL1213 SOLID CONDUCTOR
5	1	E20 SOLID ORG	WIRE 20E UL1213 SOLID CONDUCTOR
4	1	E20 SOLID RED	WIRE 20E UL1213 SOLID CONDUCTOR
3	1	-016 VITON	O-RING -016 VITON 75
2	A/R	PAVE-Seal 150	EPOXY BLUE
1	1	0130	HOUSING SPF12-E

ALL DIMENSIONS AND TOLERANCES APPLY TO FINISHED PART IN INCHES  
 ALLOWABLE TOLERANCES UNLESS SPECIFIED OTHERWISE: NONE +/-0.5  
 .X DECIMAL +/- 0.1 .XX DECIMAL +/- 0.02 .XXX DECIMAL +/-0.005  
 ANGLES +/- 1 DEG SURFACE FINISH 128 microinch RMS

2751 Thunderhawk Court  
Dayton, Ohio 45414-3445  
U.S.A.  
(937)890-1100  
fax (937)890-5165  
www.pavetechnologyco.com

**PAVE technology co.**

DESCRIPTION PAVE-Seal Cable Harnesses  
SPF12-E-150-4-PTFE20/E20-8-X

PART NUMBER **2823**

REVISION LEVEL **E**

PROJECTION