

VS18 INSTALLATION PORT

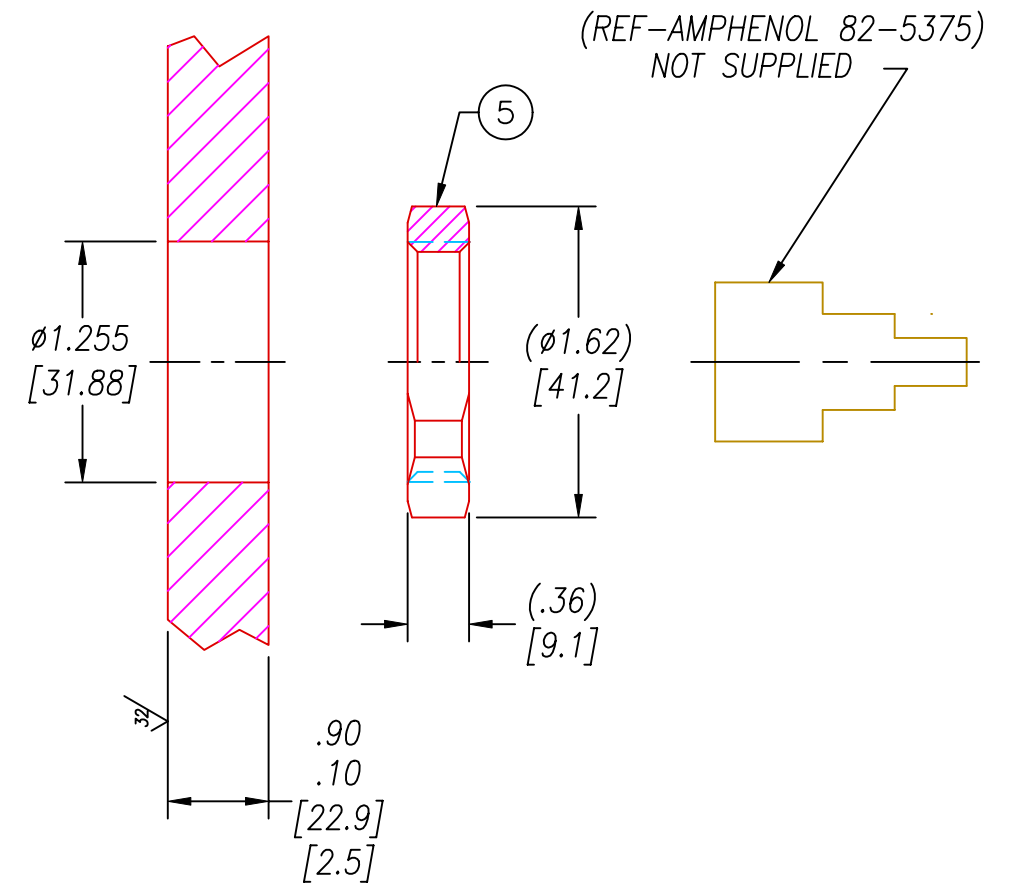

- NOTES:
1. HE LEAK TEST VACUUM  $10 \times 10^{-7}$  CC/S OR LESS. A GREEN PAINT DOT INDICATES PART HAS PASSED THE TEST.
  2. a. HYPOT 630 VDC 500 MΩ 0.01 SEC MINIMUM, CENTER CONDUCTOR TO SHIELD & HOUSING (SHIELD IS FLOATING).  
b. HYPOT 2500 VAC CENTER, SHIELD, & HOUSING 0.5mA MAXIMUM LEAKAGE.
  3. CONTINUITY TEST WITH MATING PLUGS <1.0 Ω MAXIMUM.
  4. 50 Ω IMPEDANCE TEST ±10% WITH TDR & RG-141A/U CABLE.
  5. REF-TDR  $V_p=0.70$ .
  6. ALL TESTS ARE PERFORMED AT ROOM TEMPERATURE.
  7. ALL PARTS MUST PASS ALL TESTS.
  8. PARTS ARE THERMAL CYCLED BEFORE TESTING, -25°C TO 80°C, 3 CYCLES, 2 HOUR HOLD AT TEMPERATURE.
  9. VOIDS LARGER THAN  $\phi 0.035$  [0.89] ARE NOT ACCEPTABLE.
  10. REF-OPERATING TEMPERATURE RANGE -20°C TO 150°C.
  11. DIMENSIONS ARE INCHES [millimeters].
  12. PAVE-SEAL CAN BE A BI-DIRECTIONAL HERMETIC SEAL FOR VACUUM AND MOST PRESSURES. FOR PRESSURES ABOVE 150 PSI (10 BAR), CHECK WITH SALES ENGINEERING.
  13. ALCOHOL OR FOMBLIN YVAC 3 MAY BE USED TO LUBRICATE O-RINGS FOR HELIUM TESTING.

5	1	1014	NUT VS18-SS
4	1	-219 VITON	O-RING -219 VITON 75
3	2	ARF1023-ND	RCPT RF TYPE N COAX
2	A/R	PAVE-Seal 200	EPOXY BLACK
1	1	0660	HOUSING VS18-SS
ITEM	QTY	PART#	DESCRIPTION

ALL DIMENSIONS AND TOLERANCES APPLY TO FINISHED PART IN INCHES  
 ALLOWABLE TOLERANCES UNLESS SPECIFIED OTHERWISE: NONE +/-0.5  
 .X DECIMAL +/- 0.1 .XX DECIMAL +/- 0.02 .XXX DECIMAL +/-0.005  
 ANGLES +/- 1 DEG SURFACE FINISH 128 microinch RMS

2751 Thunderhawk Court  
 Dayton, Ohio 45414-3445  
 U.S.A.  
 (937)890-1100  
 fax (937)890-5165  
 www.pavetechnologyco.com

**PAVE technology co.**

DESCRIPTION PAVE-Mate® 1 Connectors  
**VS18-SS-200-N (RF COAX CONN)**

PART NUMBER  
**1526**

REVISION LEVEL  
**G**

PROJECTION