

.06 [1.5] MAXIMUM OVER/UNDERFILL,
NOT INCLUDING MENISCUS ON WIRES,
SPACING CONTROL NOT REQUIRED
BOTH SIDES

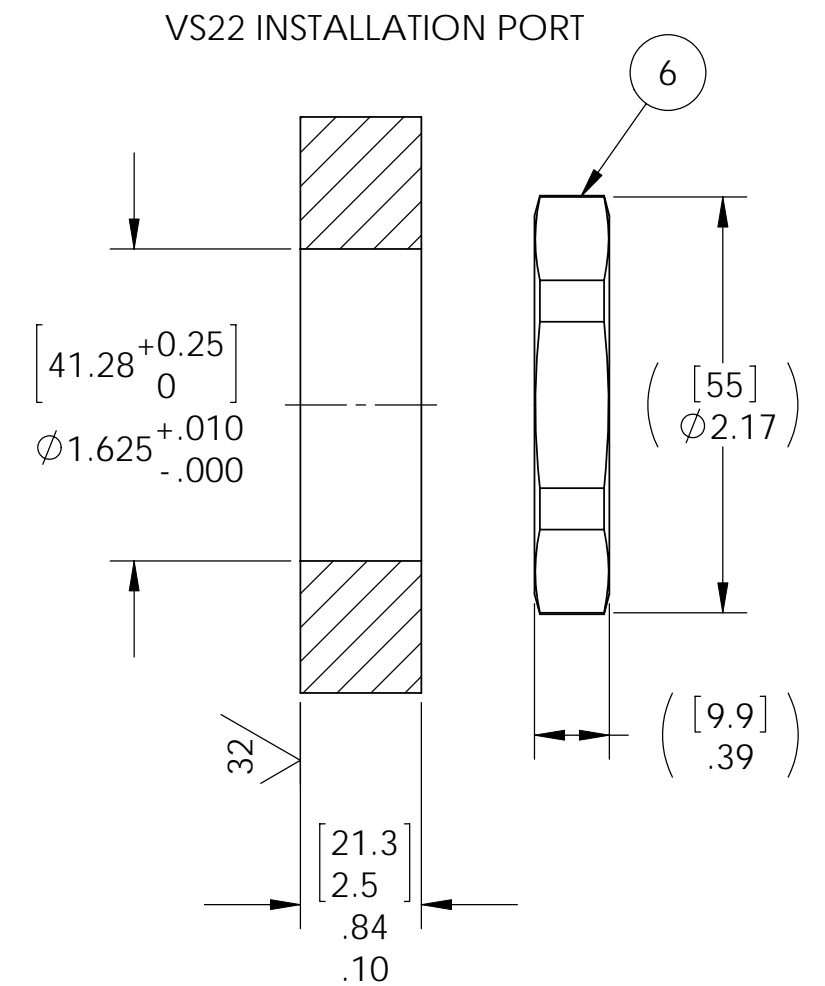
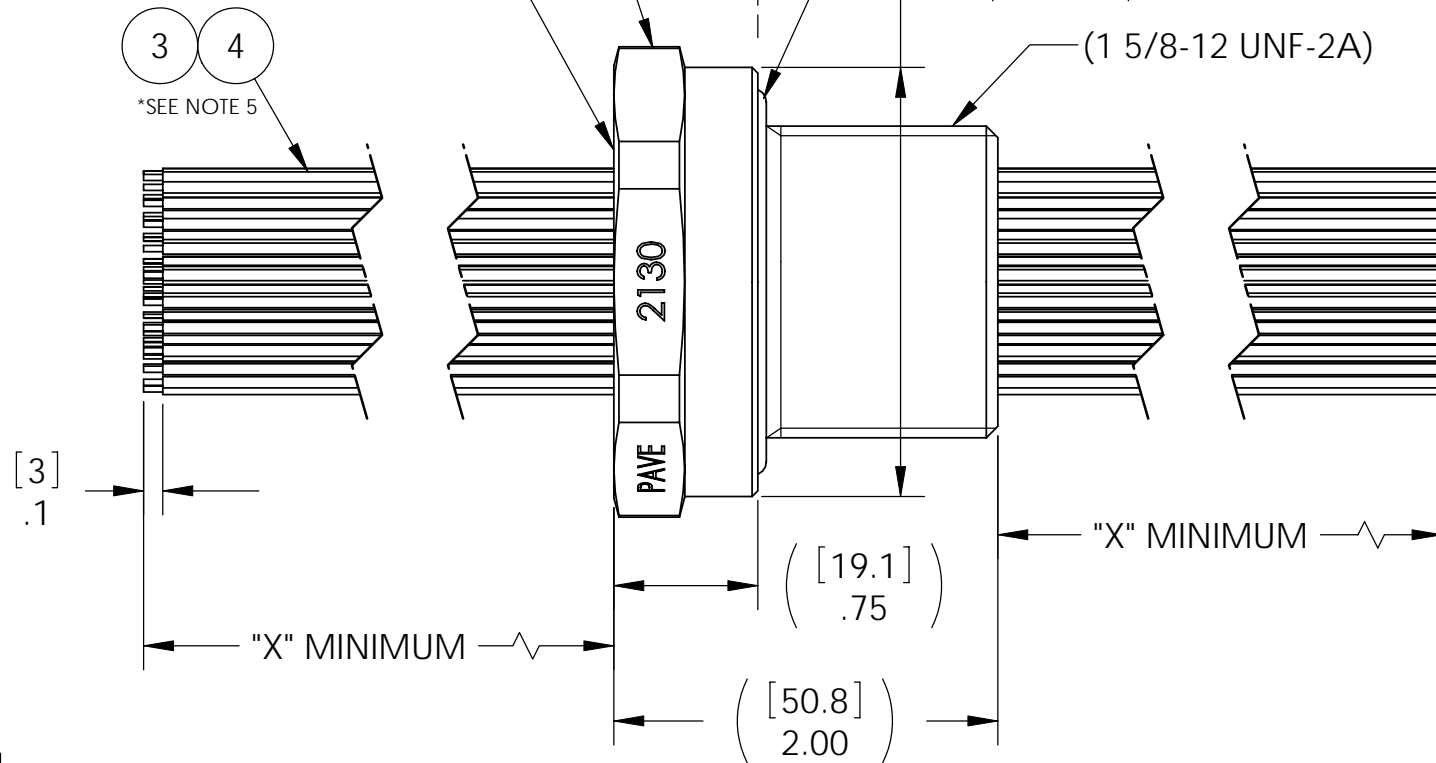

PAVE #	"X"
2130	24 [610]
2130-1	36 [914]

WIRE COLOR CHART

2	E20 YELLOW	5	E24 WHITE
2	E20 WHITE	5	E24 RED
2	E20 VIOLET	5	E24 PURPLE
2	E20 RED	5	E24 ORANGE
2	E20 ORG	5	E24 GREEN
3	E20 GREEN	5	E24 GRAY
3	E20 GRAY	5	E24 BROWN
3	E20 BROWN	5	E24 BLUE
3	E20 BLACK	5	E24 BLACK
3	E20 BLUE	5	E24 YELLOW
QTY	ITEM 3 PART NUMBER	QTY	ITEM 4 PART NUMBER

NOTES:

- HE LEAK TEST VACUUM 10X10⁻⁸ CC/SEC OR LESS.
- HYPOT 630 VDC 500 MEGOHMS MINIMUM 0.01 SECOND MINIMUM WIRE TO WIRE AND HOUSING.
- ALL TESTS ARE PERFORMED AT ROOM TEMPERATURE.
- ALL PARTS MUST PASS ALL TESTS.
- WIRE COLOR POSITIONING IS RANDOM & VARIABLE.
- VOIDS LARGER THAN ϕ .035 [.89] ARE NOT ACCEPTABLE.
- REF-OPERATING TEMPERATURE -20°C TO 125°C.
- DIMENSIONS ARE INCHES [millimeters].
- PAVE-SEAL CAN BE A BI-DIRECTIONAL HERMETIC SEAL FOR VACUUM AND MOST PRESSURES. FOR PRESSURES ABOVE 150 PSI (10 BAR), CHECK WITH SALES ENGINEERING.

6	1	0199	NUT VS22-SS
5	1	-224 VITON	O-RING -224 VITON 75
4	50	E24 *PER CHART*	WIRE 24E MIL-W-16878 .010 7/#32
3	25	E20 *PER CHART*	WIRE 20E MIL-W-16878 .010 7/#28
2	A/R	PAVE-Seal 150	EPOXY BLACK
1	1	0189/304SS	HOUSING VS22-SS
ITEM	QTY	PART NUMBER	DESCRIPTION

2751 Thunderhawk Court
Dayton, OH 45414-3445
U.S.A.
tel (937) 890-1100
fax (937) 8905165
www.pavetechnologyco.com

PAVE technology co.

DESCRIPTION
VS22-SS-150-25/50-TE20/24-X-X

PART NUMBER
2130*

MATERIAL NOTED

REVISION LEVEL
A

PROJECTION

ALL DIMENSIONS AND TOLERANCES APPLY TO FINISHED PART IN INCHES.
ALLOWABLE TOLERANCES UNLESS SPECIFIED OTHERWISE: NONE ±0.5
X.X DECIMAL ±0.1 X.XX DECIMAL ±0.02 X.XXX DECIMAL ±0.005
ANGLES ±1 DEGREE SURFACE FINISH 128 microinch RMS