

SEE NOTE 8  
WIRE COLOR LOCATIONS AS SHOWN

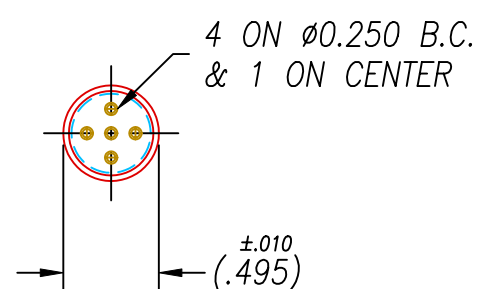

SP8S INSTALLATION PORT

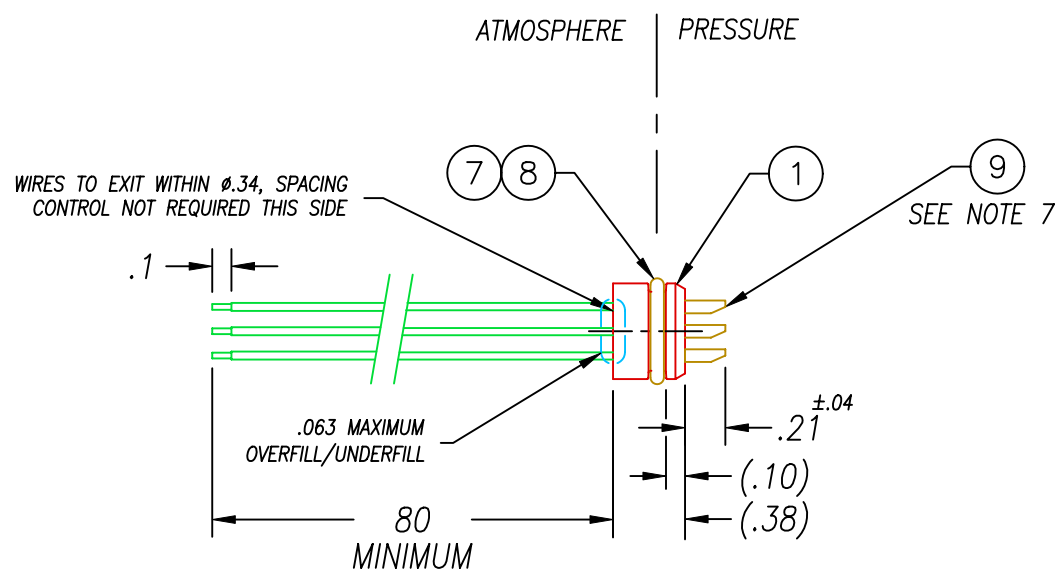
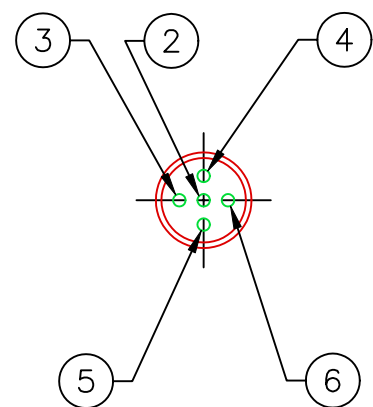
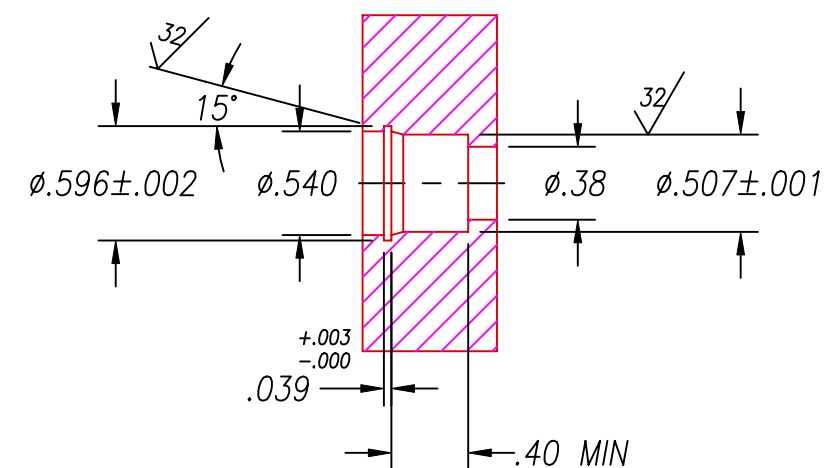

RECOMMENDED RETAINING RING  
TRUARC N5000-56 OR EQUAL

NOTES:

1. LEAK TEST: 80 PSI, NO BUBBLES 3.5 MINUTES MINIMUM.
2. HYPOT 630 VDC 500 MΩ 0.01 SEC MINIMUM, WIRE TO WIRE.
3. ALL TESTS ARE PERFORMED AT ROOM TEMPERATURE.
4. PERCENTAGE OF PARTS TESTED WILL BE 100% (MAY BE A LESSER PERCENTAGE FOR LARGE PRODUCTION QUANTITIES, UNLESS OTHERWISE NOTED OR REQUIRED).
5. CONTINUITY FROM WIRE END TO SOLDER CUP 0.12 Ω MAXIMUM.
6. REF-4 TO 5 SECONDS PER SOLDERING OPERATION W/5 SECOND DELAY BETWEEN OPERATIONS.
7. OPEN SIDE OF SOLDER CUPS (ITEM 9) MUST ALL FACE SAME DIRECTION (TOWARDS THE YELLOW WIRE) ±45°.
8. WIRE POSITIONS MAY NOT VARY FROM THAT SHOWN.

9	5	P32-1900-343	CONTACT SOLDER CUP #18
8	A/R	PARKER O-LUBE	LUBRICANT O-RING BARIUM-BASED
7	1	-012 VITON	O-RING -012 VITON 75
6	1	TZ22 ORG 19	WIRE 22TZ M22759/44A .006 19/#34
5	1	TZ22 YLW 19	WIRE 22TZ M22759/44A .006 19/#34
4	1	TZ22 BLUE MPC	WIRE 22TZ M22759/44A .006 19/#34
3	1	TZ22 RED 19	WIRE 22TZ M22759/44A .006 19/#34
2	1	TZ22 BLACK	WIRE 22TZ M22759/44A .006 19/#34
1	1	1226S	HOUSING SP8S-E
ITEM	QTY	PART NUMBER	DESCRIPTION

ALL DIMENSIONS AND TOLERANCES APPLY TO FINISHED PART IN INCHES  
ALLOWABLE TOLERANCES UNLESS SPECIFIED OTHERWISE: NONE +/-0.5  
.X DECIMAL +/- 0.1 .XX DECIMAL +/- 0.02 .XXX DECIMAL +/-0.005  
ANGLES +/- 1 DEG SURFACE FINISH 128 microinch RMS

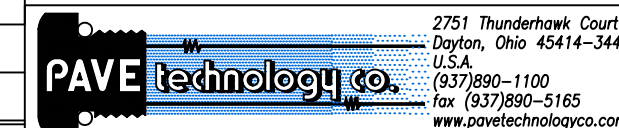

DESCRIPTION PAVE-Mate II Connectors  
SP8S-E-150-5-TZ22-80-SC

PART NUMBER  
2208

REVISION LEVEL  
D  
PROJECTION