

APPROXIMATE
WIRE LOCATIONS

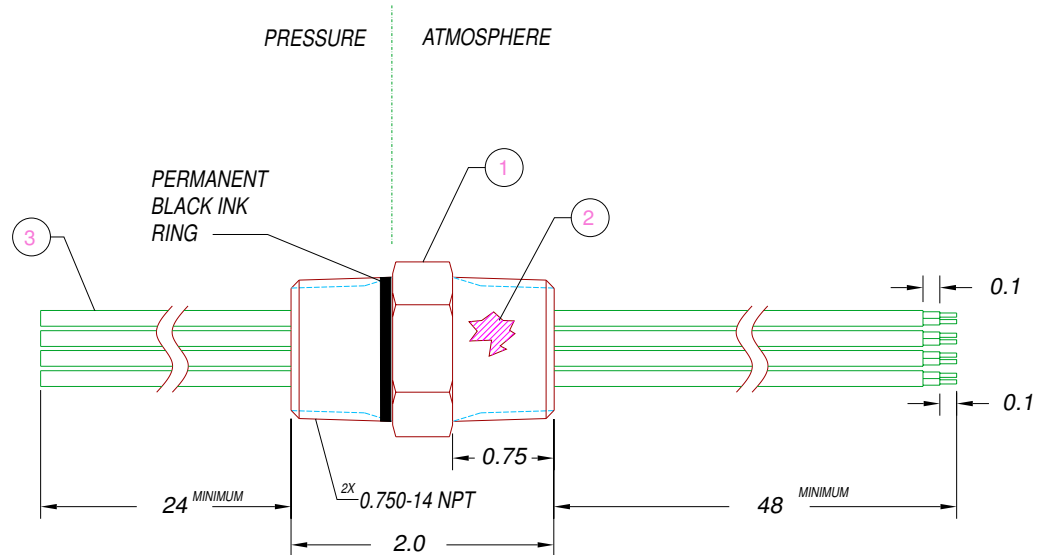
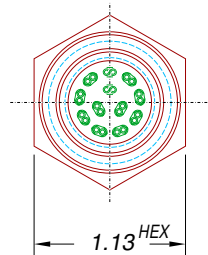

NOTES:

1. LEAK TEST: 80 PSI, NO BUBBLES 3 MINUTES MIN
2. HYPOT 630 VDC 500 MEGOHMS 0.01 SEC MINIMUM, WIRE TO WIRE & HOUSING.
3. ALL TESTS ARE PERFORMED AT ROOM TEMPERATURE.
4. RECOMMENDED PORT: 3/4-14 NPT THREAD W/TEFLON TAPE.

PAVE will meet the assembly and test specifications of the customer as documented on this assembly drawing. Any changes must be approved by PAVE.

3	12@74	JT20	CABLE T/C TYPE J 20AWG TEFLON
2	A/R	PAVE-Seal 200	EPOXY BLACK
1	1	0073	HOUSING PTN12-SS
ITEM	QTY	PART NUMBER	DESCRIPTION

ALL DIMENSIONS AND TOLERANCES APPLY TO FINISHED PART IN INCHES
 ALLOWABLE TOLERANCES UNLESS SPECIFIED OTHERWISE: NONE +/- .5
 .X DECIMAL +/- .1 .XX DECIMAL +/- .02 .XXX DECIMAL +/- .005
 ANGLES +/- 1 DEG SURFACE FINISH 128 microinch RMS

PAVE technology co. 2751 Thunderhawk Court
 Dayton, Ohio 45414-3445
 U.S.A.
 (937)890-1100
 fax (937)890-5165
 www.pave-technology.com

DESCRIPTION PAVE-Seal® Cable Harnesses
PTN12-SS-200-12P-JT20-24-48

PART NUMBER **2240** PROJECTION