

FACE VIEW OF (ITEM 1) PIN INSERTS

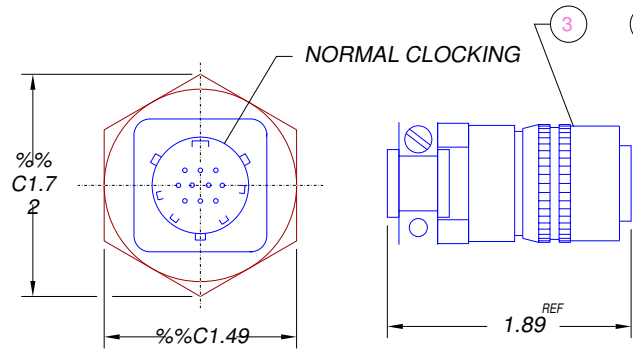

ATMOSPHERE VACUUM

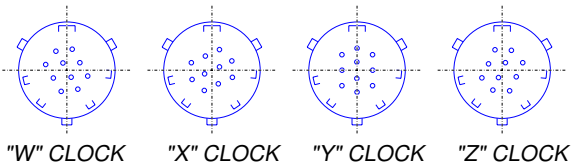
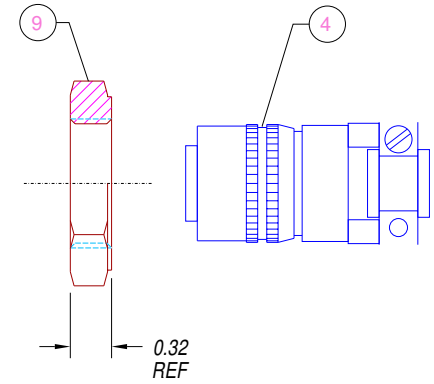
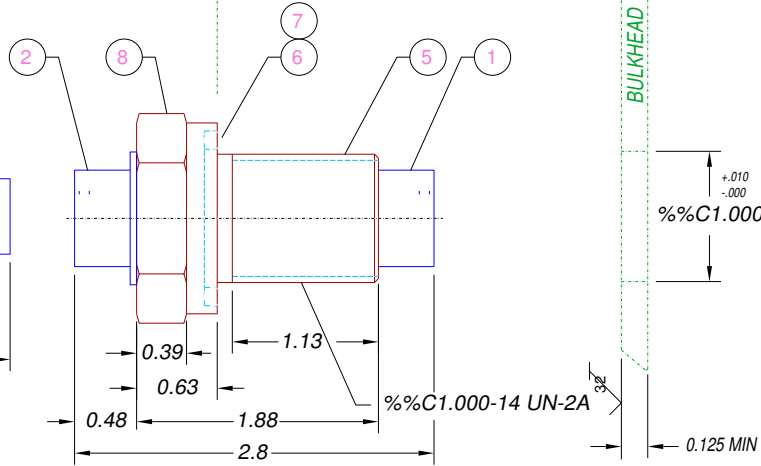

NOTES:

1. HE LEAK TEST @1 ATM. <math>10^{-7}</math> CC/S
2. HYPOT 630 VDC 500 MEGOHMS .01 SEC MINIMUM, PINS TO SOCKETS & THREADS W/MATING PLUGS.
3. ALTERNATE CLOCKING (W, X, Y OR Z) IS INDICATED BY APPENDING THE APPROPRIATE LETTER TO THE PART NUMBER AND TO THE PAVE ORDER CODE. THE SAME LETTER IS THEN ADDED TO ITEMS 1 THRU 4 (E.G., FOR AN X CLOCK 2415\* USE "2415X" & ITEM 1 IS SC3112E12-10PX.).
4. ADDING "NP" TO PART NUMBER & ORDER CODE INDICATES THAT ITEMS 3 & 4 AREN'T TO BE INCLUDED.
5. ADDING "+PT" TO PART NUMBER & ORDER CODE INDICATES A 200PSI HELIUM TEST THREAD SIDE <math>10</math>-cc/s.
6. ALL TESTS DONE AT ROOM TEMPERATURE.
7. TORQUE LABEL -PAVE (2415\*) Dayton, OH USA TIGHTEN TO 27.12 Nm MAXIMUM

9	1	0183	NUT VS15-SS
8	A/R	PAVE-Seal 150	EPOXY BLACK
7	A/R	SUPER O-LUBE	LUBRICANT O-RING SILICONE
6	1	-215 VITON	O-RING -215 VITON 75
5	1	0181	INSERT VS15L-SS
4	1	SC3126F12-10S	PLUG 10 #20 SOC
3	1	SC3126F12-10P	PLUG 10 #20 PIN
2	1	SC3112E12-10S	RCPT 10 #20 SOC
1	1	SC3112E12-10P	RCPT 10 #20 PIN

ITEM QTY PART# DESCRIPTION

ALL DIMENSIONS AND TOLERANCES APPLY TO FINISHED PART IN INCHES  
 ALLOWABLE TOLERANCES UNLESS SPECIFIED OTHERWISE: NONE +/-0.5  
 .X DECIMAL +/- 0.1 .XX DECIMAL +/- 0.02 .XXX DECIMAL +/-0.005  
 ANGLES +/- 1 DEG SURFACE FINISH 128 microinch RMS



DESCRIPTION PAVE-Mate® I Connectors  
**VS15L-E-150-10-20-3112SP**

PART NUMBER **2415**

PROJECTION