

BULKHEAD-REF ONLY

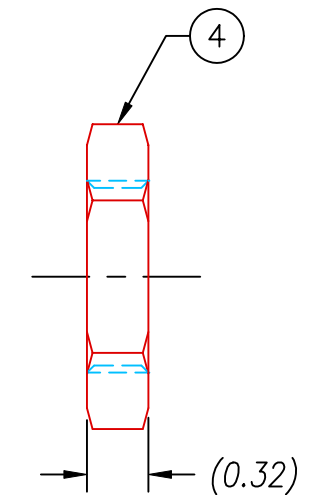
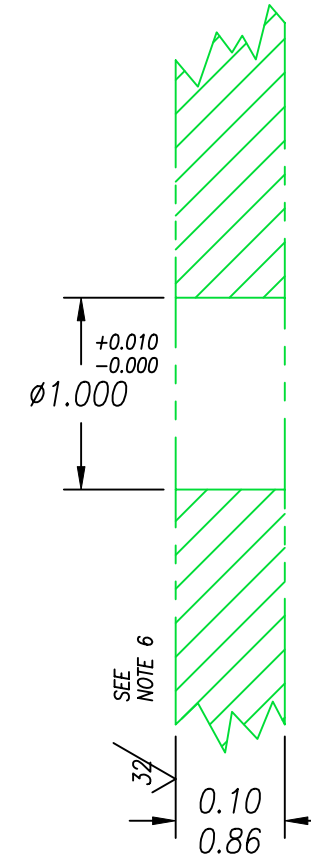

NOTES:

1. HE LEAK TEST @1 ATM. 10^{-6} CC/S.
2. HYPOT 630 VDC 500 MΩ .01 SEC MINIMUM, CENTER CONDUCTOR TO SHELL TO HOUSING.
3. CONTINUITY TEST CENTER CONDUCTOR AND SHELL <math>< 0.5 \Omega</math> W/MATING CONNECTORS.
4. ALL TESTS ARE PERFORMED AT ROOM TEMPERATURE.
5. PERCENTAGE OF PARTS TESTED WILL BE 100% (MAY BE A LESSER PERCENTAGE FOR LARGE PRODUCTION QUANTITIES, UNLESS OTHERWISE NOTED OR REQUIRED).
6. FINISH APPLIES TO SPOTFACE FOR O-RING SEAL ONLY.
7. REF- OPERATING TEMPERATURE -20° TO 150°C
8. NO VOIDS LARGER THAN Ø0.035 ARE ACCEPTABLE.

6	A/R	SUPER O-LUBE	LUBRICANT O-RING SILICONE-BASED
5	A/R	PAVE-Seal 150	EPOXY BLACK
4	1	0183	NUT VS15-SS
3	1	-215 VITON	O-RING -215 VITON 75A
2	1	0161	HOUSING VS15L-SS
1	2	AMPH# 27000	RCPT MHV UG-931 5 AMP
ITEM	QTY	PART NUMBER	DESCRIPTION

ALL DIMENSIONS AND TOLERANCES APPLY TO FINISHED PART IN INCHES
 ALLOWABLE TOLERANCES UNLESS SPECIFIED OTHERWISE: NONE +/-0.5
 .X DECIMAL +/- 0.1 .XX DECIMAL +/- 0.02 .XXX DECIMAL +/-0.005
 ANGLES +/- 1 DEG SURFACE FINISH 128 microinch RMS

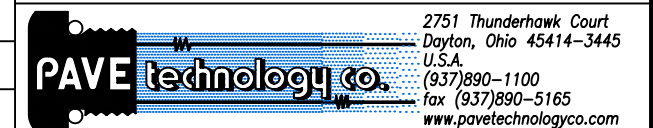

DESCRIPTION PAVE-Seal® Cable Harnesses
 VS15L-SS-150-MHV-MHV

PART NUMBER
 2954

REVISION LEVEL -
 PROJECTION