

VS8 INSTALLATION PORT

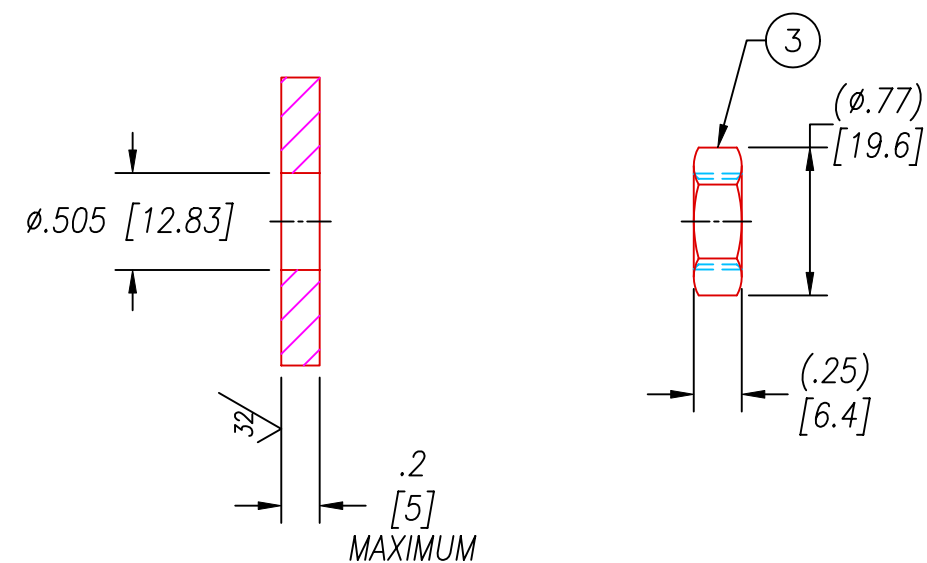

NOTES:

1. HE LEAK TEST @1 ATM. 10×10^{-8} CC/S OR LESS. QUALIFICATION ONLY: LEAK TEST 725 PSI (50 BAR) THREAD SIDE, NO BUBBLES 2 MINUTES MINIMUM.
2. OPTICAL CONTINUITY: <3.0 dB ATTENUATION @ 850nm, SOURCE TO METER.
3. ALL TESTS ARE PERFORMED AT ROOM TEMPERATURE.
4. ALL PARTS MUST PASS ALL TESTS.
5. SHIP ASSEMBLY WITH ADAPTERS CAPPED TO PROTECT AGAINST DAMAGE & OR CONTAMINATION.
6. NO VOIDS LARGER THAN $\phi 0.035$ [0.89] ARE ACCEPTABLE.
7. DIMENSIONS ARE INCHES [millimeters].
8. PAVE-SEAL CAN BE A BI-DIRECTIONAL HERMETIC SEAL FOR VACUUM AND MOST PRESSURES. FOR PRESSURES ABOVE 150 PSI (10 BAR), CHECK WITH SALES ENGINEERING.

7	1	SOREQ FIBER BLK	FIBER 600/900u 1100u ACRYLATE
6	2	905-150-5080	FERRULE SMA 905 SS 1100um (COMPONENT)
5	1	0892	HOUSING VS8-SS
4	1	-112 VITON	O-RING -112 VITON 75
3	1	0894	NUT VS8-SS
2	A/R	PAVE-Seal 150	EPOXY BLACK
1	2	THOR#ADASMA	ADAPTOR SMA STYLE SS
ITEM	QTY	PART#	DESCRIPTION



DESCRIPTION PAVE-Opti Seal™ Cable Harnesses
VS8-SS-150-1-600-SMA-SMA

PART NUMBER

3328

REVISION LEVEL

B

PROJECTION

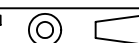

ALL DIMENSIONS AND TOLERANCES APPLY TO FINISHED PART IN INCHES
ALLOWABLE TOLERANCES UNLESS SPECIFIED OTHERWISE: NONE +/-0.5
.X DECIMAL +/- 0.1 .XX DECIMAL +/- 0.02 .XXX DECIMAL +/-0.005
ANGLES +/- 1 DEG SURFACE FINISH 128 microinch RMS