

ATMOSPHERE | VACUUM

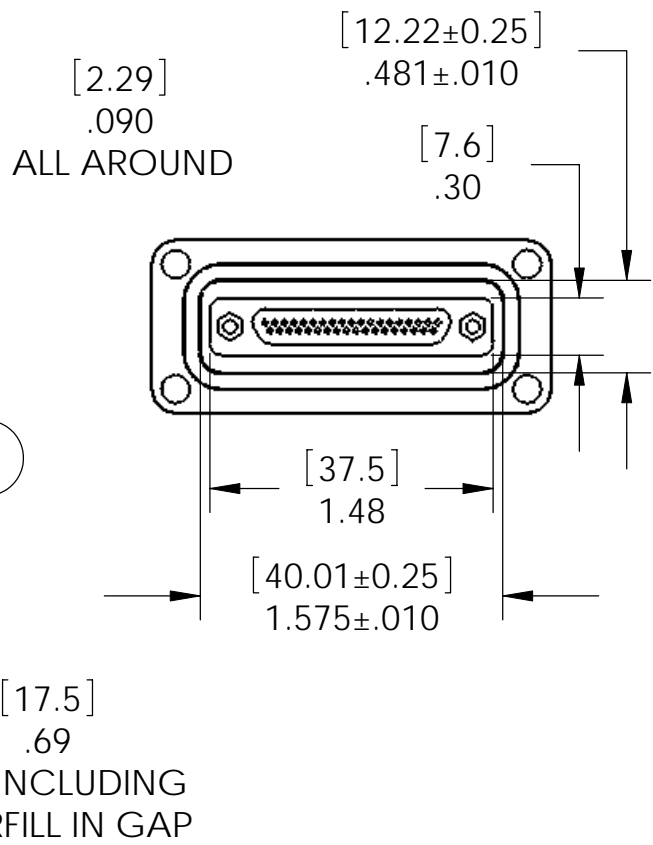

SP33/14 INSTALLATION PORT

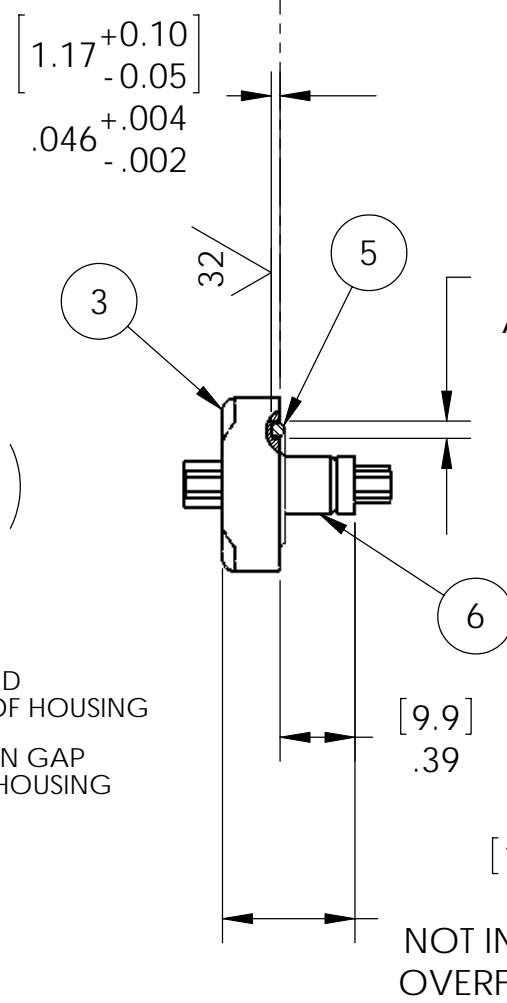
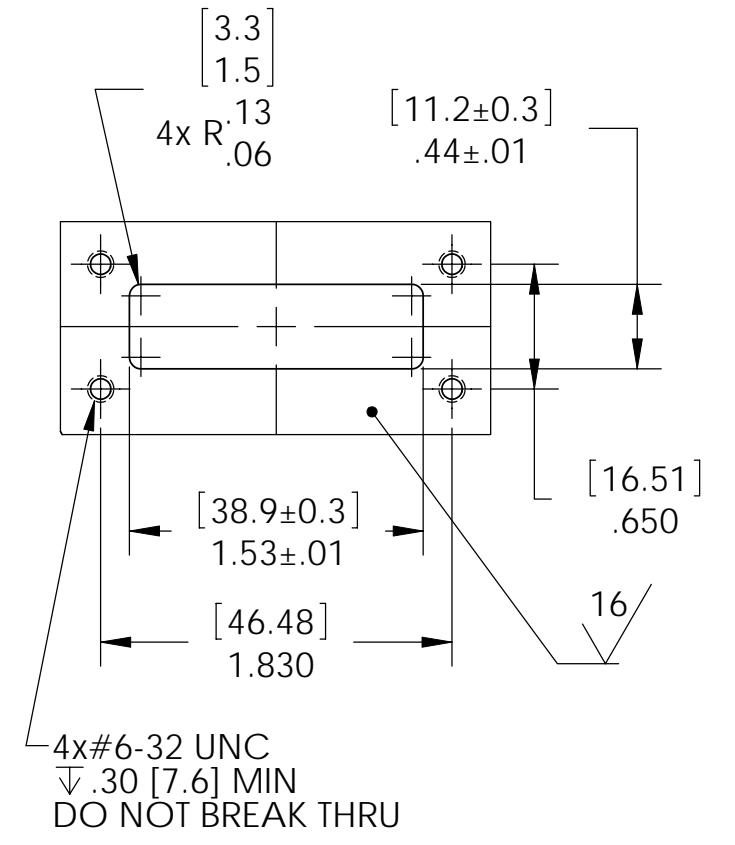

NOTES:

- HE LEAK TEST @ 1 ATM 10x10<sup>-8</sup> CC/SEC OR LESS.
- HYPOT 500 VDC 200 MEGOHMS MINIMUM 0.01 SECOND MINIMUM WIRE TO WIRE AND HOUSING.
- CONTINUITY TEST 0.5 OHMS MAXIMUM MATING CONNECTOR TO MATING CONNECTOR.
- ALL TESTS ARE PERFORMED AT ROOM TEMPERATURE.
- ALL PARTS MUST PASS ALL TESTS.
- NO VOIDS ARE ACCEPTABLE ON O-RING SEALING SURFACES, VOIDS SMALLER THAN  $\phi$ 0.035 [.89] ARE ACCEPTABLE ON ALL OTHER SURFACES.
- REF-OPERATING TEMPERATURE -20 °C TO 125 °C.
- DIMENSIONS ARE INCHES [millimeters].
- PAVE# 3338R IS REVERSED WITH SOCKETS ON THE VACUUM SIDE AND PINS ON THE ATMOSPHERE SIDE.

ITEM	QTY	PART NUMBER	DESCRIPTION
6	A/R	PAVE-Seal 150	EPOXY BLACK
5	1	-026 VITON	O-RING -026 VITON 75
4	4	JACKPOST 2-56	"P" STYLE 2-56 UNC
3	1	3174	HOUSING SP33/14-AL 6061 ELECTROLESS NICKEL PLATED
2	1	MICROD 37P	CONNECTOR 37PIN MIL-C-83513
1	1	MICROD 37S	CONNECTOR 37SOC MIL-C-83513

**PAVE technology co.**  
 2751 Thunderhawk Court  
 Dayton, OH 45414-3445  
 U.S.A.  
 tel (937) 890-1100  
 fax (937) 8905165  
 www.pavetechnologyco.com

DESCRIPTION  
 SP33/14-AL-150-37-25-M83513

PART NUMBER  
**3338\***

MATERIAL NOTED  
 REVISION LEVEL B  
 PROJECTION

ALL DIMENSIONS AND TOLERANCES APPLY TO FINISHED PART IN INCHES.  
 ALLOWABLE TOLERANCES UNLESS SPECIFIED OTHERWISE: NONE  $\pm$ 0.5  
 X.X DECIMAL  $\pm$ 0.1 X.XX DECIMAL  $\pm$ 0.02 X.XXX DECIMAL  $\pm$ 0.005  
 ANGLES  $\pm$ 1 DEGREE SURFACE FINISH 128 microinch RMS