

DETAIL A
SCALE 4 : 1

RECEPTACLE PIN-OUT		
PIN	COLOR	FUNCTION
1	RED	VBUS
2	WHITE	D-
3	GREEN	D+
4	N/A	N/A
5	BLACK	GROUND
SHELL	DRAIN	SHIELD

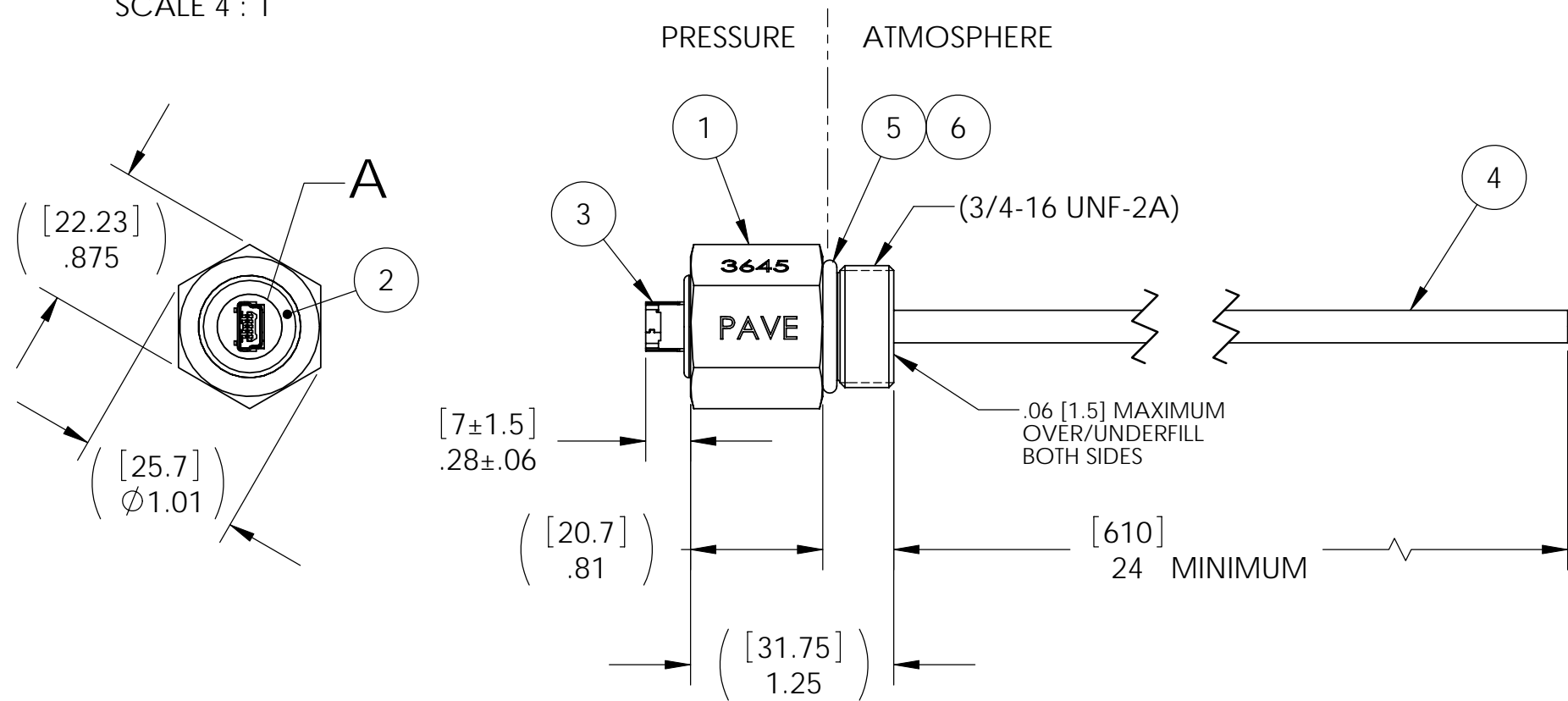

SO12 INSTALLATION PORT

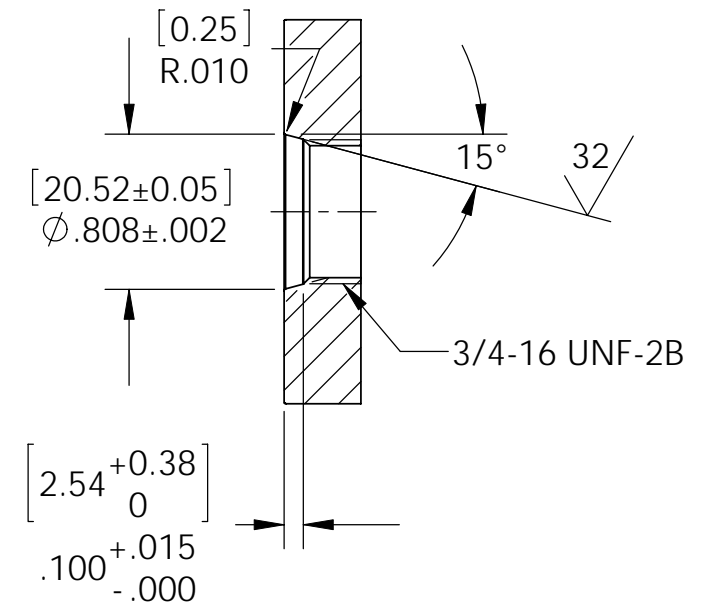

NOTES:

1. LEAK TEST: 5000 PSI, NO BUBBLES 30 SECONDS MINIMUM.
2. HYPOT 630 VDC 500 MEGOHMS MINIMUM 0.01 SECOND MINIMUM PIN TO PIN AND HOUSING WITH MATING CONNECTOR.
3. CONTINUITY TEST: $<.5\Omega$ MATING CONNECTOR TO WIRE ENDS.
4. ALL TESTS ARE PERFORMED AT ROOM TEMPERATURE.
5. ALL PARTS MUST PASS ALL TESTS.
6. VOIDS SMALLER THAN $\phi 0.035$ [.89] ARE ACCEPTABLE.
7. REF-OPERATING TEMPERATURE -20°C TO 75°C .
8. DIMENSIONS ARE INCHES [millimeters].

6	A/R	PARKER O-LUBE	LUBRICANT O-RING BARIUM-BASED
5	1	-908 VITON	O-RING -908 VITON 75
4	1	70505	CABLE USB 2.0
3	1	MOL #5000751517	RCPT USB Mini-B VERT/PCB
2	A/R	PAVE-Seal 150	EPOXY BLACK
1	1	3648	HOUSING SO12L-SS
ITEM	QTY	PART NUMBER	DESCRIPTION

PAVE technology co.
 2751 Thunderhawk Court
 Dayton, OH 45414-3445
 U.S.A.
 tel (937) 890-1100
 fax (937) 8905165
 www.pavetechnologyco.com

DESCRIPTION SO12L-SS-150-1-miniBF-USBcable-24	
PART NUMBER 3645	MATERIAL NOTED
REVISION LEVEL -	PROJECTION ☉ ◻

ALL DIMENSIONS AND TOLERANCES APPLY TO FINISHED PART IN INCHES.
 ALLOWABLE TOLERANCES UNLESS SPECIFIED OTHERWISE: NONE ± 0.5
 X.X DECIMAL ± 0.1 X.XX DECIMAL ± 0.02 X.XXX DECIMAL ± 0.005
 ANGLES ± 1 DEGREE SURFACE FINISH 128 microinch RMS