

PIN	COLOR
A	WHITE
B	GREEN

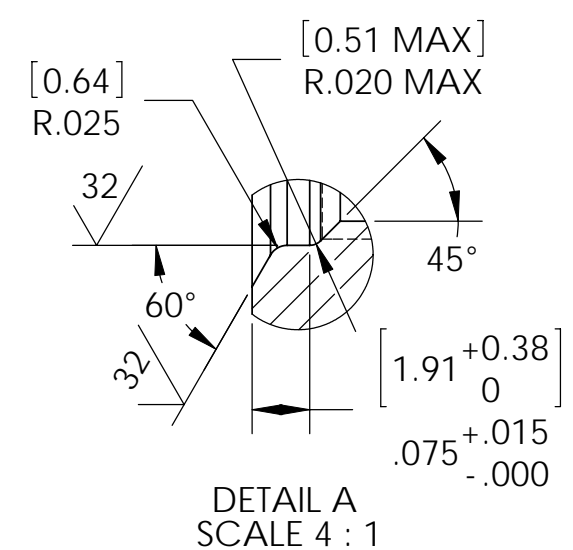
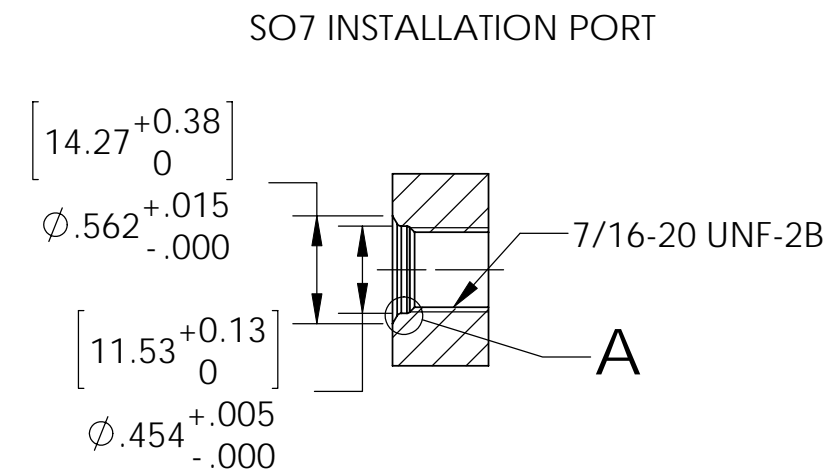

NOTES:

1. LEAK TEST: 1800 PSI N2, NO BUBBLES 30 SECONDS MINIMUM.
2. HYPOT 630 VDC 500 MEGOHMS MINIMUM 0.01 SECOND MINIMUM WIRE TO WIRE AND HOUSING WITH MATING PLUG.
3. ALL TESTS ARE PERFORMED AT ROOM TEMPERATURE.
4. ALL PARTS MUST PASS ALL TESTS.
5. VOIDS LARGER THAN  $\phi 0.035$  [.89] ARE NOT ACCEPTABLE.
6. ITEM 8 (MATING PLUG) IS INCLUDED BUT NOT SHOWN.
7. REF-OPERATING TEMPERATURE -65 °C TO 125 °C.
8. PAVE-SEAL CAN BE A BI-DIRECTIONAL HERMETIC SEAL FOR VACUUM AND MOST PRESSURES. FOR PRESSURES ABOVE 150 PSI (10 BAR), CHECK WITH SALES ENGINEERING.

8	1	SC3126F8-2S	PLUG 2#20 SOC 26482 SERIES I
7	A/R	PARKER O-LUBE	LUBRICANT O-RING BARIUM-BASED
6	1	3-904 FLUORO	O-RING 3-904 FLUOROSILICONE 70
5	1	TZ22 GRN 19	WIRE 22TZ MILW22759/44A .006 19/#34
4	1	TZ22 WHT 19	WIRE 22TZ MILW22759/44A .006 19/#34
3	1	SC3112E8-2P	RCPT 2#20 PIN BLACK ANODIZED OR ELECTROLESS NICKEL
2	A/R	PAVE-Seal 150	EPOXY BLACK
1	1	4055	HOUSING SO7L-SS
ITEM	QTY	PART NUMBER	DESCRIPTION

**PAVE technology co.**  
 2751 Thunderhawk Court  
 Dayton, OH 45414-3445  
 U.S.A.  
 tel (937) 890-1100  
 fax (937) 8905165  
 www.pavetechnologyco.com

DESCRIPTION  
 SO7L-SS-150-2-TZ20-3112P-48

PART NUMBER  
**4005**

MATERIAL NOTED

REVISION LEVEL -

PROJECTION

ALL DIMENSIONS AND TOLERANCES APPLY TO FINISHED PART IN INCHES.  
 ALLOWABLE TOLERANCES UNLESS SPECIFIED OTHERWISE: NONE  $\pm 0.5$   
 X.X DECIMAL  $\pm 0.1$  X.XX DECIMAL  $\pm 0.02$  X.XXX DECIMAL  $\pm 0.005$   
 ANGLES  $\pm 1$  DEGREE SURFACE FINISH 128 microinch RMS