

- PINS & ATTACHED WIRE COLORS:**
- 1 BLUE
 - 2 BLACK
 - 3 BROWN
 - 4 GREEN
 - 5 ORANGE
 - 6 RED

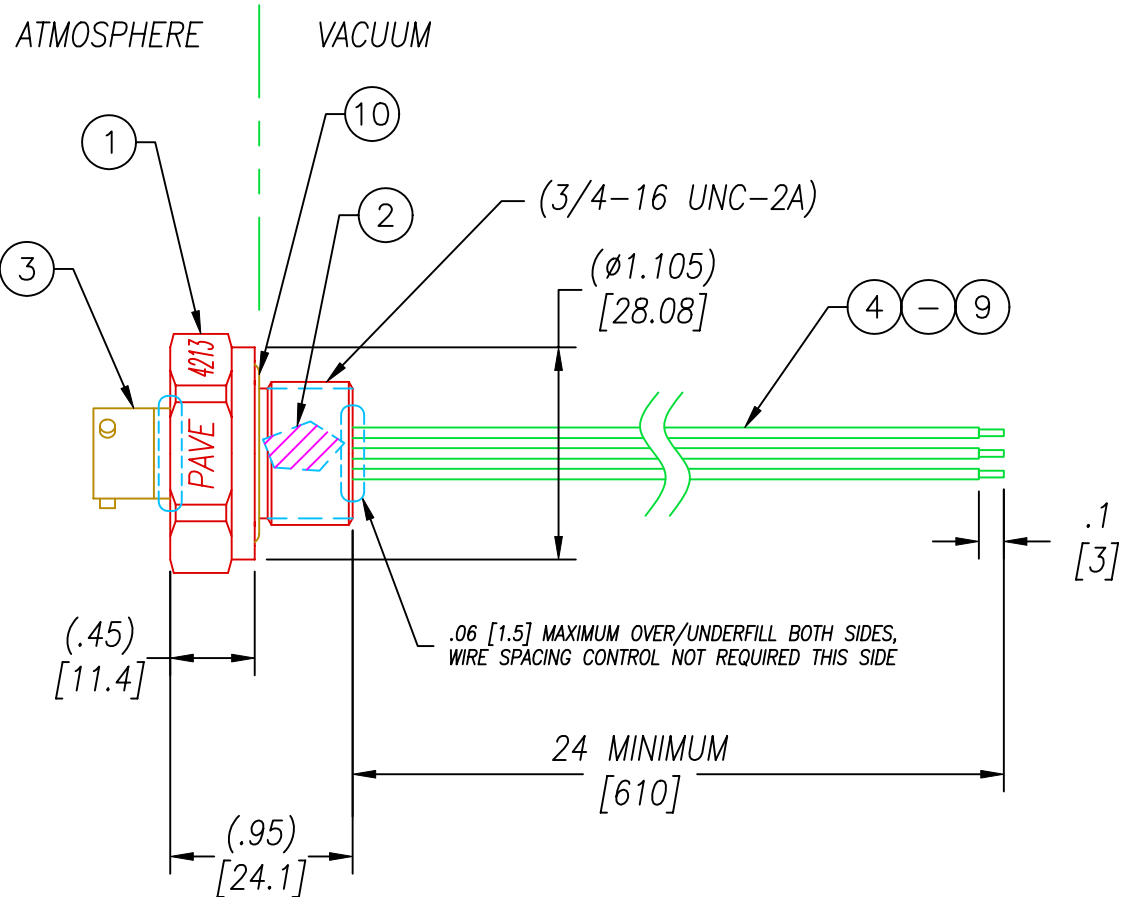

VS12 INSTALLATION PORT

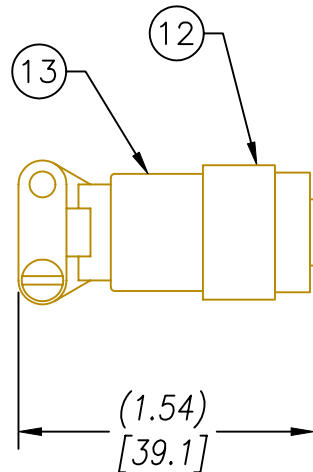
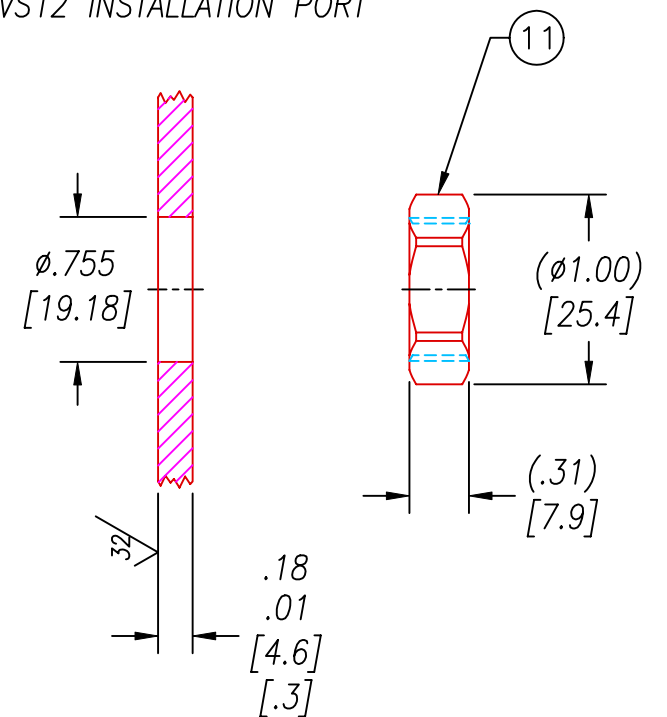

NOTES:

1. HE LEAK TEST @1 ATM. 10×10^{-8} CC/S OR LESS.
2. HYPOT 630 VDC 500 MΩ 0.01 SEC MINIMUM, WIRE TO WIRE & HOUSING WITH MATING CONNECTOR.
3. CONTINUITY TEST WIRE ENDS TO MATING PLUG <0.5 Ω.
4. ALL TESTS ARE PERFORMED AT ROOM TEMPERATURE.
5. ALL PARTS MUST PASS ALL TESTS.
6. WIRES ARE NOT REQUIRED TO BEND SHARPLY AT EPOXY SEAL SURFACE.
7. COSMETIC SURFACE VOIDS LARGER THAN $\phi.035$ [0.89] ARE NOT ACCEPTABLE.
8. REF-OPERATING TEMPERATURE RANGE -20°C TO 155°C.
9. DIMENSIONS ARE INCHES [millimeters].
10. PAVE-SEAL CAN BE A BI-DIRECTIONAL HERMETIC SEAL FOR VACUUM AND MOST PRESSURES. FOR PRESSURES ABOVE 150 PSI (10 BAR), CHECK WITH SALES ENGINEERING.
11. ALCOHOL OR FOMBLIN YVAC 3 MAY BE USED TO LUBE O-RINGS FOR VACUUM HELIUM LEAK TESTING.

13	1	M85049/49-2-8N	S/R FOR MS27473E8F35S STRAIGHT
12	1	MS27473E8F35S	PLUG 6 #22 SOC
11	1	8L5N-SS NUT	NUT VS12-SS
10	1	-116 VITON	O-RING -116 VITON 75
9	1	E22 RED	WIRE 22E MIL-W-16878/4 .010 7/#30
8	1	E22 ORANGE	WIRE 22E MIL-W-16878/4 .010 7/#30
7	1	E22 GREEN	WIRE 22E MIL-W-16878/4 .010 7/#30
6	1	E22 BROWN	WIRE 22E MIL-W-16878/4 .010 7/#30
5	1	E22 BLK	WIRE 22E MIL-W-16878/4 .010 7/#30
4	1	E22 BLUE 7 STR	WIRE 22E MIL-W-16878/4 .010 7/#30
3	1	MS27508E8F35P	RCPT 6 #22 PIN
2	A/R	PAVE-Seal 200	EPOXY BLACK
1	1	0394	HOUSING VS12-SS
ITEM	QTY	PART #	DESCRIPTION

ALL DIMENSIONS AND TOLERANCES APPLY TO FINISHED PART IN INCHES
 ALLOWABLE TOLERANCES UNLESS SPECIFIED OTHERWISE: NONE +/-0.5
 .X DECIMAL +/- 0.1 .XX DECIMAL +/- 0.02 .XXX DECIMAL +/-0.005
 ANGLES +/- 1 DEG SURFACE FINISH 128 microinch RMS

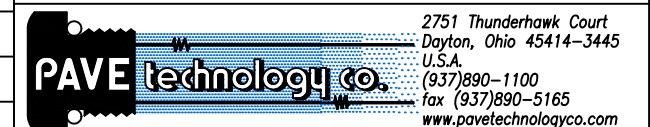

DESCRIPTION PAVE-Mate II Connectors
VS12-SS-200-6-TE22-27508P-24

PART NUMBER
4213

REVISION LEVEL
A
 PROJECTION