

INSTALLATION PORT

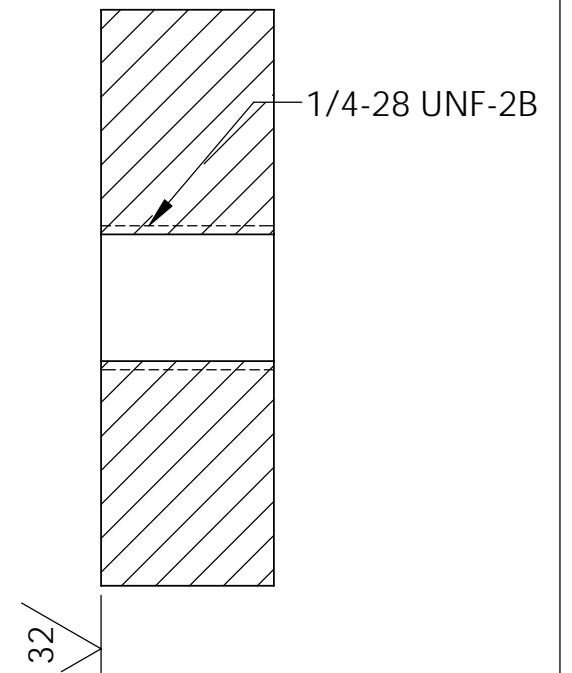

NOTES:

1. LEAK TEST: 1000 PSI, NO BUBBLES 10 SECONDS MINIMUM.
2. HYPOT 630 VDC 500 MEGOHMS MINIMUM 0.01 SECOND MINIMUM PIN AND HOUSING.
3. ALL TESTS ARE PERFORMED AT ROOM TEMPERATURE.
4. ALL PARTS MUST PASS ALL TESTS.
5. WIRE POSITIONING IS APPROXIMATE & VARIABLE.
6. COSMETIC SURFACE VOIDS SMALLER THAN $\phi 0.035$ [.89] ARE ACCEPTABLE.
7. REF-OPERATING TEMPERATURE -20°C TO 125°C .
8. PAVE-SEAL CAN BE A BI-DIRECTIONAL HERMETIC SEAL FOR VACUUM AND MOST PRESSURES. FOR PRESSURES ABOVE 150 PSI (10 BAR), CHECK WITH SALES ENGINEERING.
9. DIMENSIONS ARE INCHES [millimeters].
10. ATMOSPHERE CONNECTION DESIGNED AS RP-SMA JACK CONNECTOR.
11. 443246-2 IS TAKEN FROM 5447647-1.

5	1	BARE COPPER #22	WIRE 22 BARE COPPER SOLID
4	1	443246-2	SMA PIN CONTACT GOLD PLATED BRASS
3	1	-011 VITON	O-RING -011 VITON 75
2	A/R	PAVE-Seal 150	EPOXY BLACK
1	1	4584	HOUSING VS4N-SS
ITEM	QTY	PART NUMBER	DESCRIPTION

PAVE technology co.
 2751 Thunderhawk Court
 Dayton, OH 45414-3445
 U.S.A.
 tel (937) 890-1100
 fax (937) 8905165
 www.pavetechnologyco.com

DESCRIPTION
 VS4N-SS-150-1-22-RPSMA-2

ALL DIMENSIONS AND TOLERANCES APPLY TO FINISHED PART IN INCHES.
 ALLOWABLE TOLERANCES UNLESS SPECIFIED OTHERWISE: NONE ± 0.5
 X.X DECIMAL ± 0.1 X.XX DECIMAL ± 0.02 X.XXX DECIMAL ± 0.005
 ANGLES ± 1 DEGREE SURFACE FINISH 128 microinch RMS

PART NUMBER 4546	MATERIAL NOTED	REVISION LEVEL B	PROJECTION
----------------------------	----------------	---------------------	----------------