

ITEM 2 POS	CONNECTION
A1	ITEM 4/ITEM 5
A2	ITEM 4/ITEM 5
A3	ITEM 6/ITEM 7
A4	ITEM 6/ITEM 7
1	ITEM 3/PAIR 1: RED
2	ITEM 3/PAIR 1: BLK
3	ITEM 3/PAIR 2: WHT
4	ITEM 3/PAIR 2: BLK
5	NOT USED

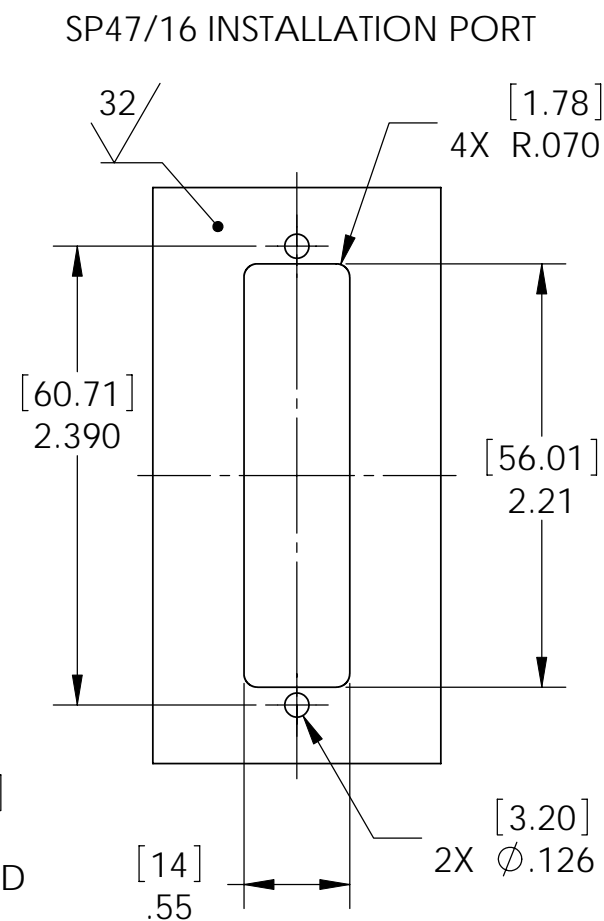
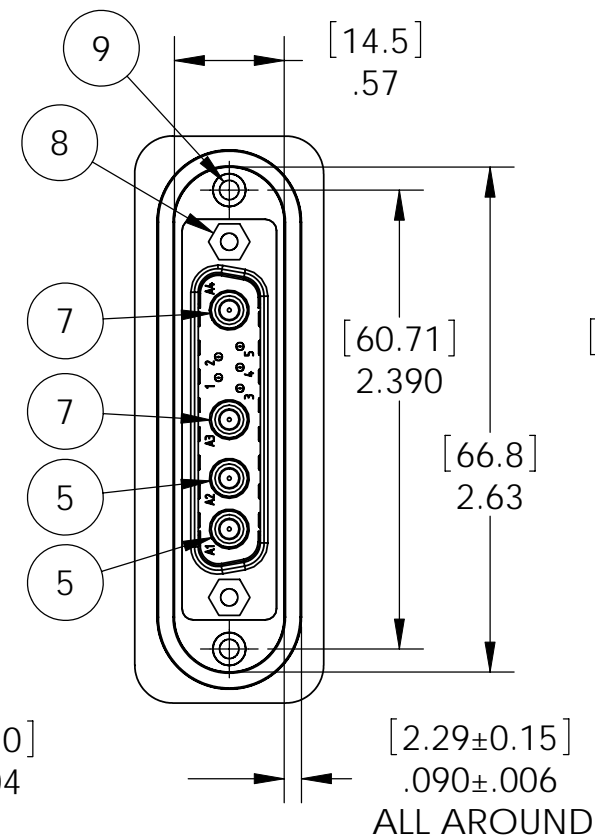
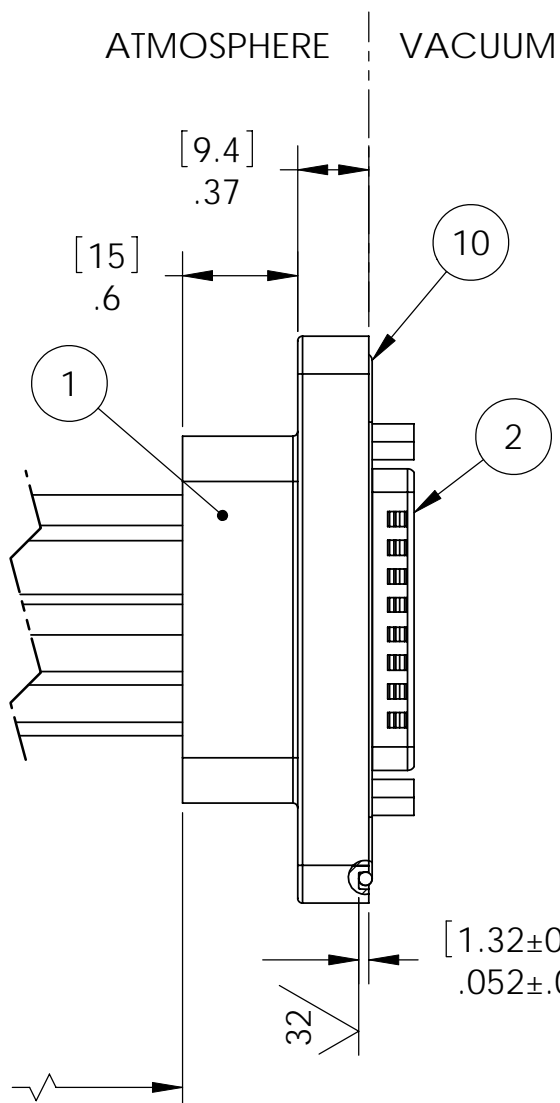
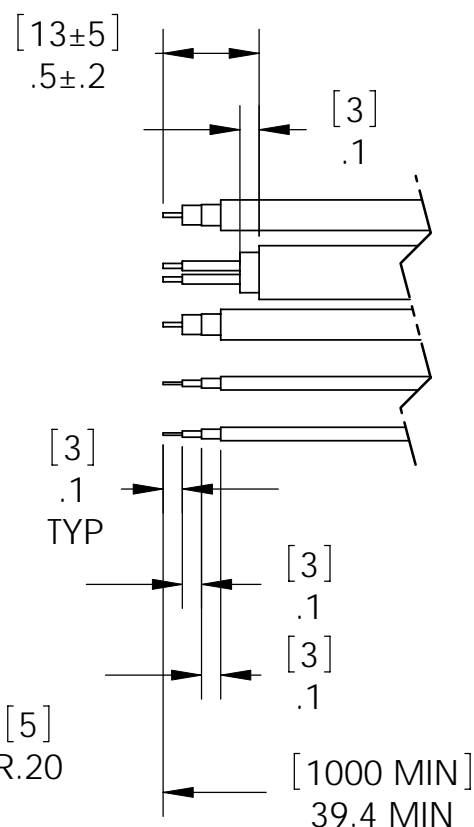
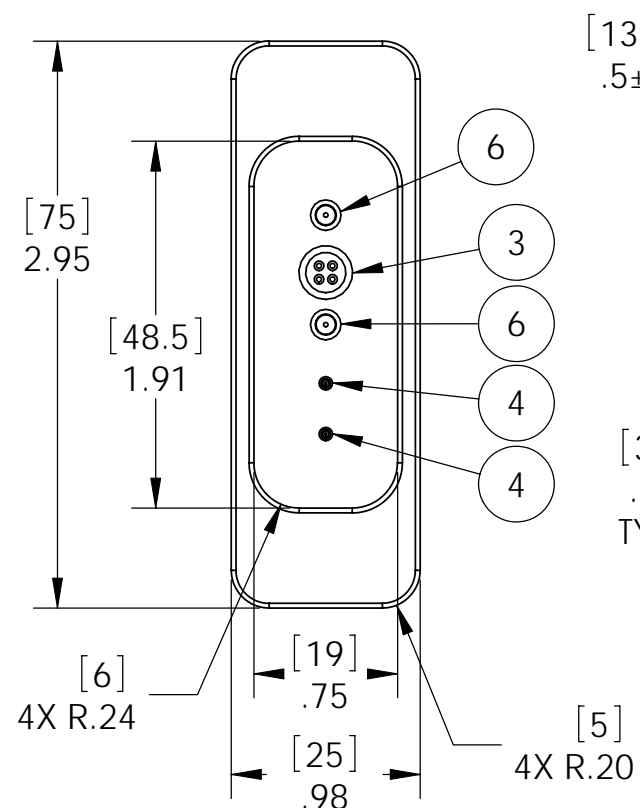

REF-USES (2X) M3x.5 SCREWS FOR INSTALLATION

NOTES:

- HE LEAK TEST @ 1 ATM 10X10⁻⁷ CC/SEC OR LESS.
- ALCOHOL OR FOMBLIN YVAC 3 MAY BE USED TO LUBRICATE O-RINGS FOR VACUUM HELIUM LEAK TESTING.
- HYPOT 630 VDC 500 MEGOHMS MINIMUM 0.01 SECOND MINIMUM WIRE TO WIRE AND SHIELDS WITH MATING CONNECTOR.
- CONTINUITY TEST < 0.5 OHMS MATING CONNECTOR TO WIRE ENDS.
- ALL TESTS ARE PERFORMED AT ROOM TEMPERATURE.
- ALL PARTS MUST PASS ALL TESTS.
- WIRE EXIT POSITIONING IS APPROXIMATE & VARIABLE.
- NO COSMETIC SURFACE VOIDS ARE ACCEPTABLE ON O-RING SEALING SURFACES, COSMETIC SURFACE VOIDS SMALLER THAN Ø0.035 [0.89] ARE ACCEPTABLE ON ALL OTHER SURFACES.
- DIMENSIONS ARE INCHES [millimeters].
- REF-OPERATING TEMPERATURE -20°C TO 80°C.
- PAVE-SEAL CAN BE A BI-DIRECTIONAL HERMETIC SEAL FOR VACUUM AND MOST PRESSURES. FOR PRESSURES ABOVE 150 PSI (10 BAR), CHECK WITH SALES ENGINEERING.

ITEM	QTY	PART NUMBER	DESCRIPTION
10	1	-032 VITON	O-RING -032 VITON 75
9	2	YARDLEY3005A5-8	THREAD INSERT SS M3X.5
8	2	JACKPOST 4-40	"P" STYLE 4-40 UNC
7	2	1600800670C	CONTACT #8 COAX 75 OHM STRAIGHT
6	2	RG179 M17/094	WIRE COAX M17/094 B83264
5	2	DM53740-5	CONTACT #8 COAX 50 OHM STRAIGHT
4	2	RG178	WIRE COAX M17/93 RG178 7#38 SPCCS TFE INSULATION OVERALL SPC BRAID/FEP JACKET
3	1	BELDEN #8302	CABLE 4/C 2/TP PC22 7#30 TIN PLATED Cu OVERALL FOIL/TC BRAID/PVC JACKET
2	1	DBM9W4PK87	CONNECTOR DSUB COMBO 9W4 PLUG 5#20 Au/Ni PLATED Cu PINS, 4#8 CAVITIES, TIN PLATED STEEL SHELL
1	A/R	PAVE-Seal 150	EPOXY BLACK

ALL DIMENSIONS AND TOLERANCES APPLY TO FINISHED PART IN INCHES.
ALLOWABLE TOLERANCES UNLESS SPECIFIED OTHERWISE: NONE ±0.5
X.X DECIMAL ±0.1 X.XX DECIMAL ±0.02 X.XXX DECIMAL ±0.005
ANGLES ±1 DEGREE SURFACE FINISH 128 microinch RMS

PAVE technology co.
2751 Thunderhawk Court
Dayton, OH 45414-3445
U.S.A.
tel (937) 890-1100
fax (937) 8905165
www.pavetechnologyco.com

DESCRIPTION
SP47/16-E-150-2/2/1-RG178/RG179/BELDEN8302/39-DSUB

PART NUMBER
4623

MATERIAL NOTED

REVISION LEVEL
A

PROJECTION