

NO EPOXY OR DAMAGE ALLOWED ON KNIFE EDGE

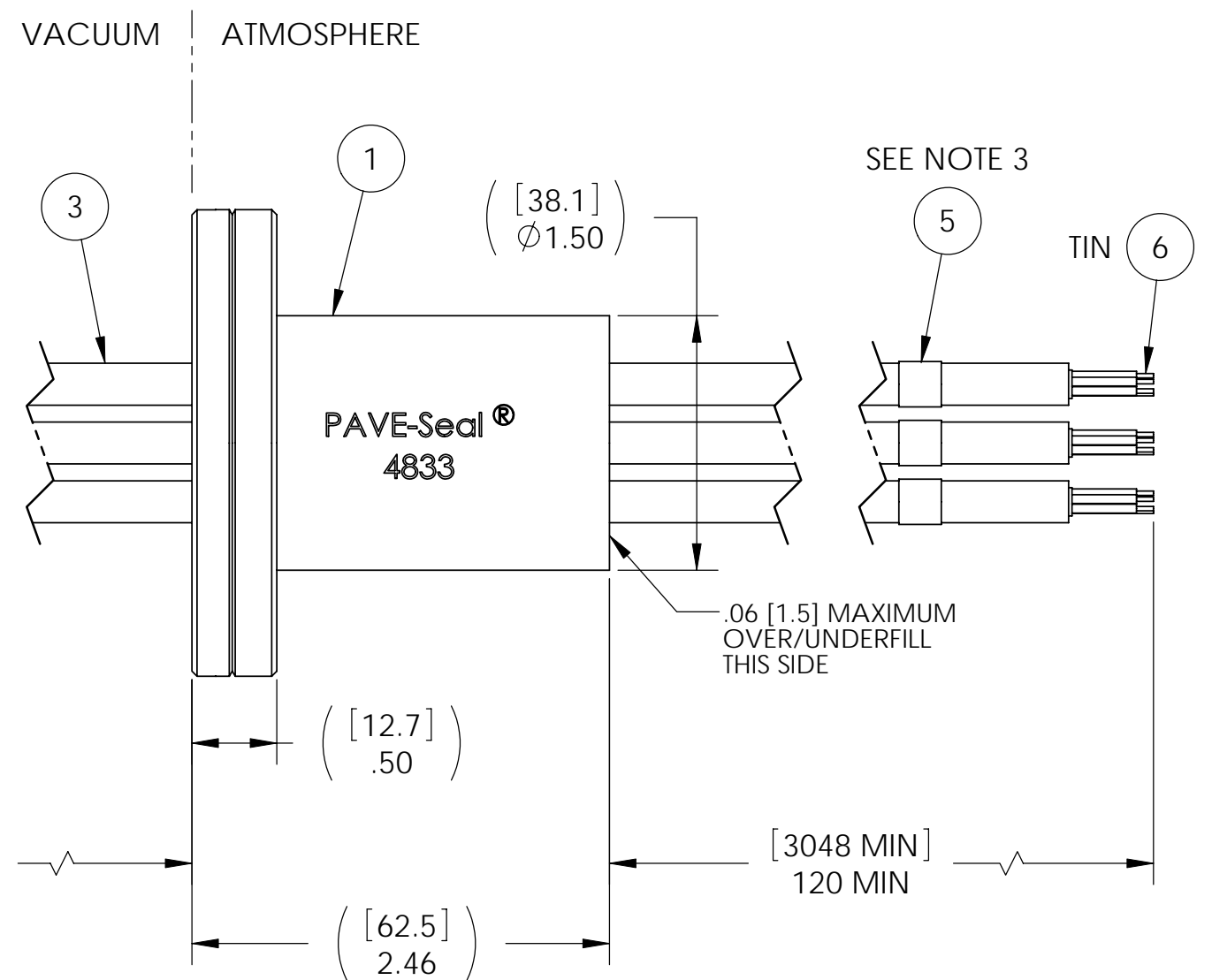
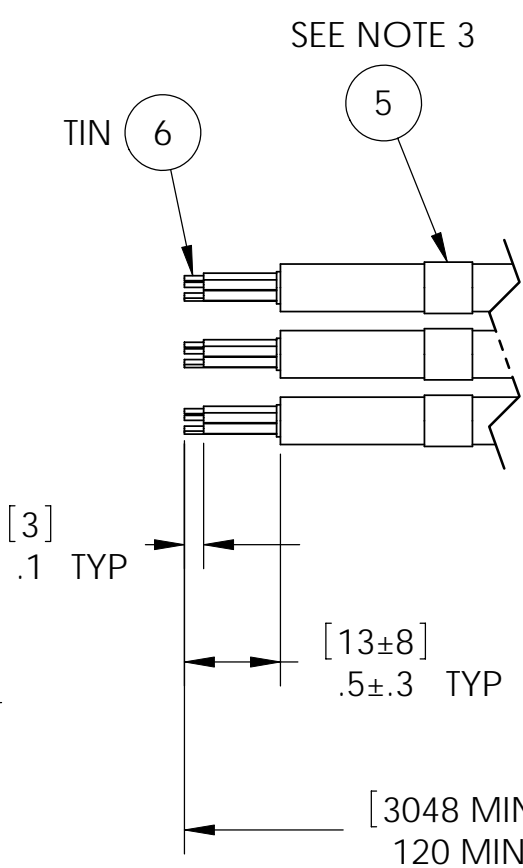
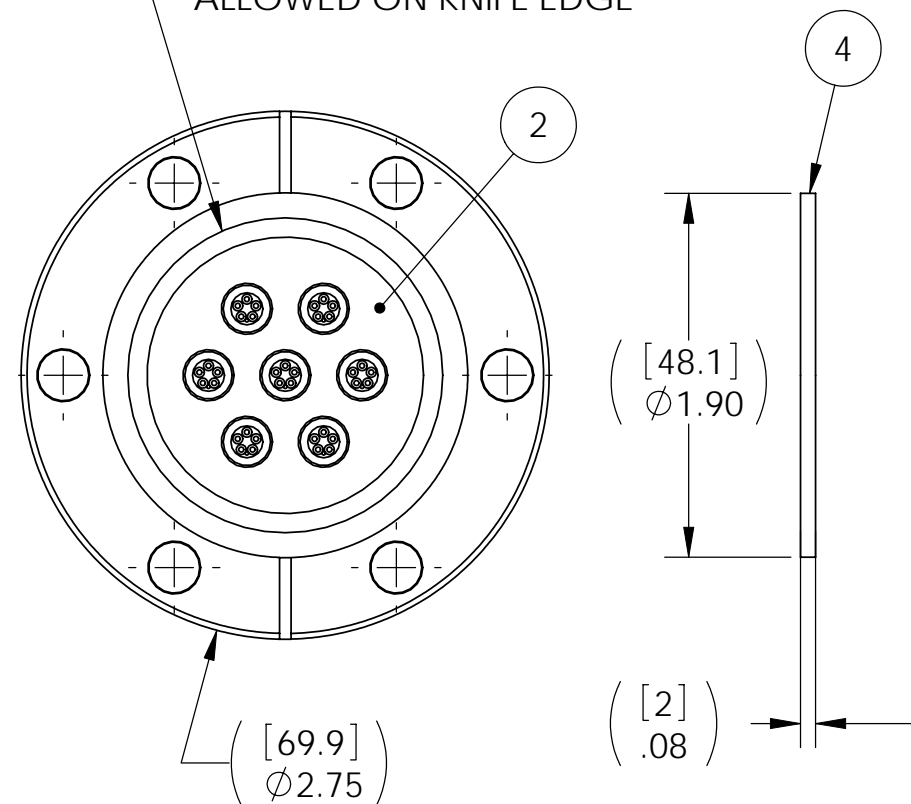

NOTES:

1. HE LEAK TEST @ 1ATM 1X10<sup>-6</sup> CC/SEC OR LESS. LEAK TEST IS PERFORMED USING A G-275 VITON GASKET, A GREEN PAINT DOT INDICATES THE PART HAS PASSED THE TEST.
2. HYPOT 300 VDC 50 MEGOHMS MINIMUM 0.01 SECOND MINIMUM WIRE TO WIRE AND HOUSING.
3. BOTH SIDES OF ITEM 3 WILL BE MARKED WITH CORRESPONDING NUMBERS OR LETTERS.
4. ALL TESTS ARE PERFORMED AT ROOM TEMPERATURE.
5. ALL PARTS MUST PASS ALL TESTS.
6. WIRE POSITIONING IS APPROXIMATE & VARIABLE.
7. COSMETIC SURFACE VOIDS SMALLER THAN Ø0.035 [0.89] ARE ACCEPTABLE.
8. DIMENSIONS ARE INCHES [millimeters].
9. REF-OPERATING TEMPERATURE RANGE -20 °C TO 105 °C.
10. PAVE-SEAL CAN BE A BI-DIRECTIONAL HERMETIC SEAL FOR VACUUM AND MOST PRESSURES. FOR PRESSURES ABOVE 150 PSI (10 BAR), CHECK WITH SALES ENGINEERING.

6	A/R	SAC305	SOLDER SAC305 FAST CORE
5	A/R	-	BRADY WIRE MARKERS
4	1	GASKET G-275 C	GASKET COPPER
3	7	86305CY	CABLE 5#22 TWISTED SHIELDED PVC ALPHA XTRAGUARD CONTINUOUS FLEX
2	A/R	PAVE-Seal 150	EPOXY BLACK
1	1	1473	HOUSING CF275-SS
ITEM	QTY	PART NUMBER	DESCRIPTION

**PAVE technology co.**  
 2751 Thunderhawk Court  
 Dayton, OH 45414-3445  
 U.S.A.  
 tel (937) 890-1100  
 fax (937) 8905165  
 www.pavetechnologyco.com

DESCRIPTION  
 CF275-SS-150-7C-5PC22-120-120

PART NUMBER  
**4833**

MATERIAL NOTED

REVISION LEVEL  
 A

PROJECTION

ALL DIMENSIONS AND TOLERANCES APPLY TO FINISHED PART IN INCHES.  
 ALLOWABLE TOLERANCES UNLESS SPECIFIED OTHERWISE: NONE ±0.5  
 X.X DECIMAL ±0.1 X.XX DECIMAL ±0.02 X.XXX DECIMAL ±0.005  
 ANGLES ±1 DEGREE SURFACE FINISH 128 microinch RMS