

(ASSEMBLED)  
SCALE: 1:2

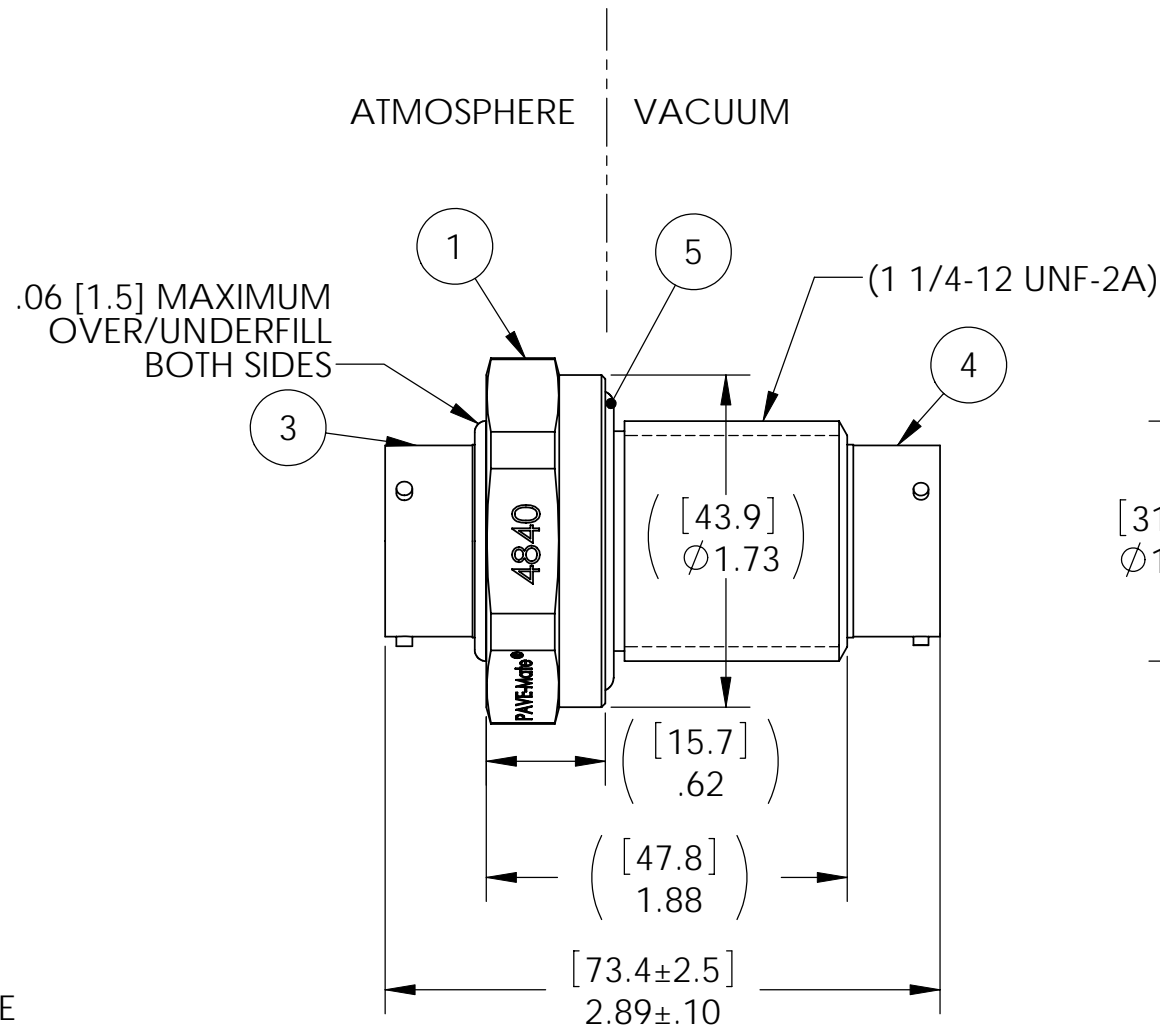

VS18 INSTALLATION PORT

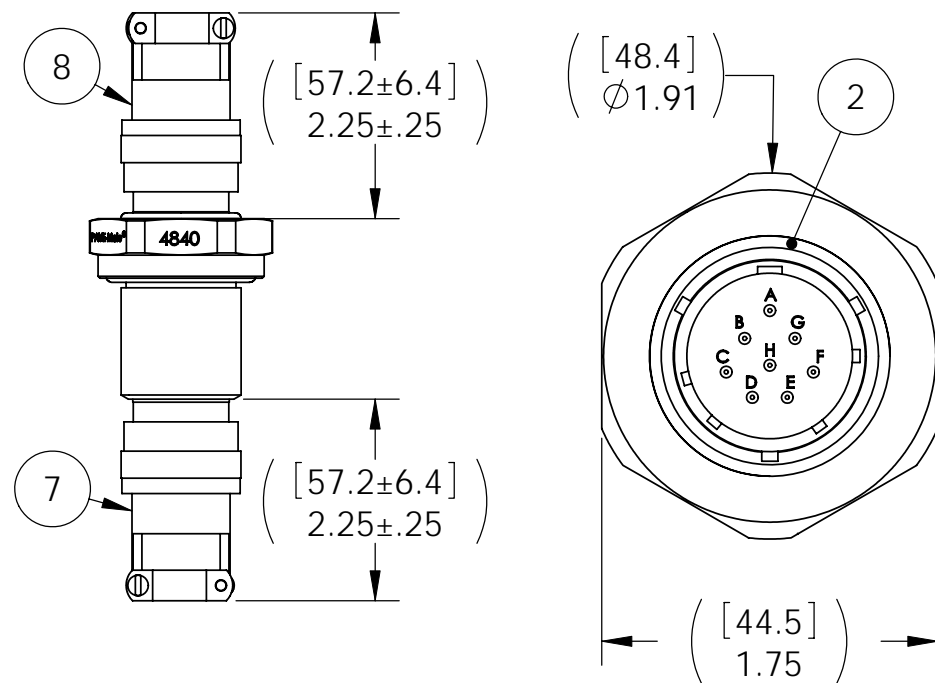
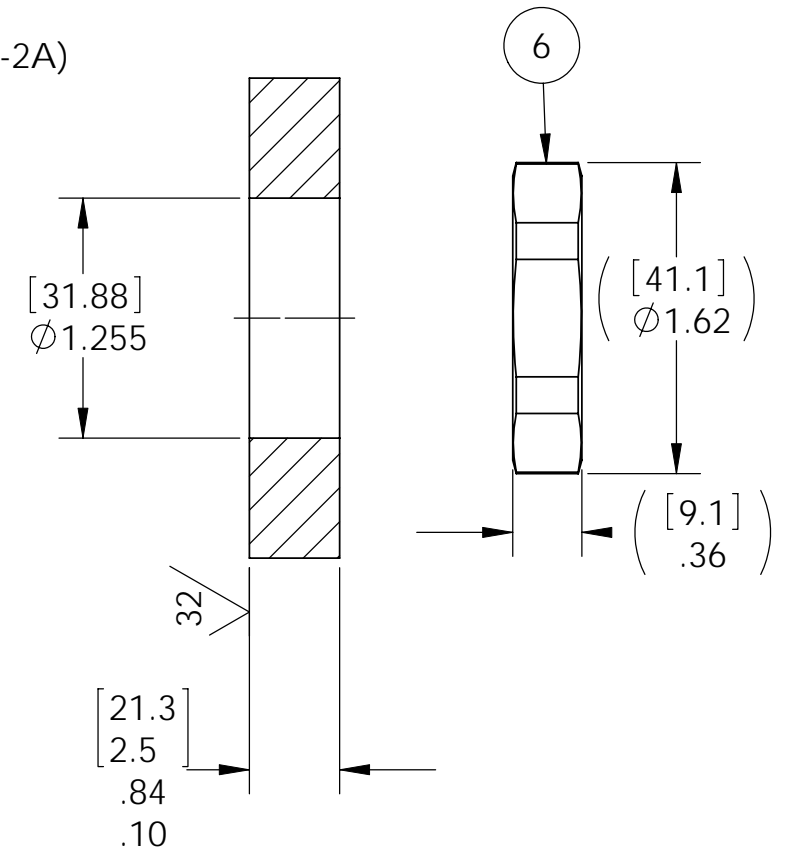

NOTES:

1. HE LEAK TEST @ 1 ATM. 1X10<sup>-7</sup> CC/SEC OR LESS. A GREEN PAINT DOT INDICATES THE PART HAS PASSED THE TEST.
2. HYPOT 1000 VDC 500 MEGOHMS MINIMUM 0.01 SECOND MINIMUM PIN TO PIN AND HOUSING WITH MATING CONNECTORS.
3. CONTINUITY TEST <0.5OHM PIN TO SOCKET WITH MATING CONNECTORS.
4. ALCOHOL OR FOMBLIN YVAC 3 MAY BE USED TO LUBRICATE O-RINGS FOR VACUUM HELIUM LEAK TESTING.
5. ALL TESTS ARE PERFORMED AT ROOM TEMPERATURE.
6. ALL PARTS MUST PASS ALL TESTS.
7. COSMETIC SURFACE VOIDS SMALLER THAN Ø0.035 [0.89] ARE ACCEPTABLE.
8. REF-OPERATING TEMPERATURE -20°C TO 125°C.
9. DIMENSIONS ARE INCHES [millimeters].
10. PAVE-SEAL CAN BE A BI-DIRECTIONAL HERMETIC SEAL FOR VACUUM AND MOST PRESSURES. FOR PRESSURES ABOVE 150 PSI (10 BAR), CHECK WITH SALES ENGINEERING.

ITEM	QTY	PART NUMBER	DESCRIPTION
8	1	SC3116F16-8S	PLUG 8#16 ELECTROLESS NICKEL PLATED SOCKET SOLDER CUP, W/ STRAIN RELIEF
7	1	SC3116F16-8P	PLUG 8#16 ELECTROLESS NICKEL PLATED PIN SOLDER CUP, W/ STRAIN RELIEF
6	1	1014	NUT VS18-SS
5	1	-219 VITON	O-RING -219 VITON 75
4	1	AE771L16-8S460	RCPT 8#16 EPOXY INSERT SOCKET
3	1	SC3112E16-8P	RCPT 8#16 PIN ELECTROLESS NICKEL PLATED
2	A/R	PAVE-Seal 150	EPOXY BLACK
1	1	3207	HOUSING VS18-SS

**PAVE technology co.**  
2751 Thunderhawk Court  
Dayton, OH 45414-3445  
U.S.A.  
tel (937) 890-1100  
fax (937) 8905165  
www.pavetechnologyco.com

DESCRIPTION  
VS18-SS-150-8-16-3112PS

PART NUMBER  
**4840**

MATERIAL NOTED

REVISION LEVEL -

PROJECTION

ALL DIMENSIONS AND TOLERANCES APPLY TO FINISHED PART IN INCHES.  
ALLOWABLE TOLERANCES UNLESS SPECIFIED OTHERWISE: NONE ±0.5  
X.X DECIMAL ±0.1 X.XX DECIMAL ±0.02 X.XXX DECIMAL ±0.005  
ANGLES ±1 DEGREE SURFACE FINISH 128 microinch RMS