

# PART INSTALLATION

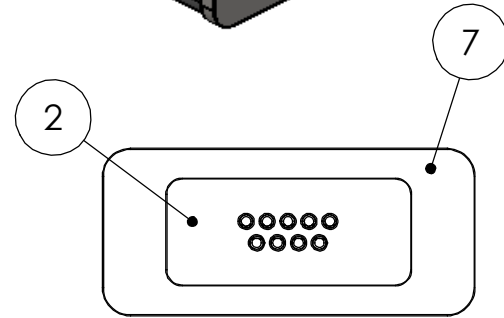

.06 [1.5] MAXIMUM OVER/UNDERFILL, NOT INCLUDING MENISCUS ON SOLDER CUPS THIS SIDE

PAVE#	ITEM 1	ITEM 1 DESCRIPTION
4696	171-009-203L001	RCPT D-SUB 9 SOCKET PBT INSULATOR, NICKEL PLATED STEEL SHELL, GOLD PLATED BRASS SOCKETS
4696-1	171-009-103L001	PLUG D-SUB 9 PIN PBT INSULATOR, NICKEL PLATED STEEL SHELL, GOLD PLATED BRASS PINS

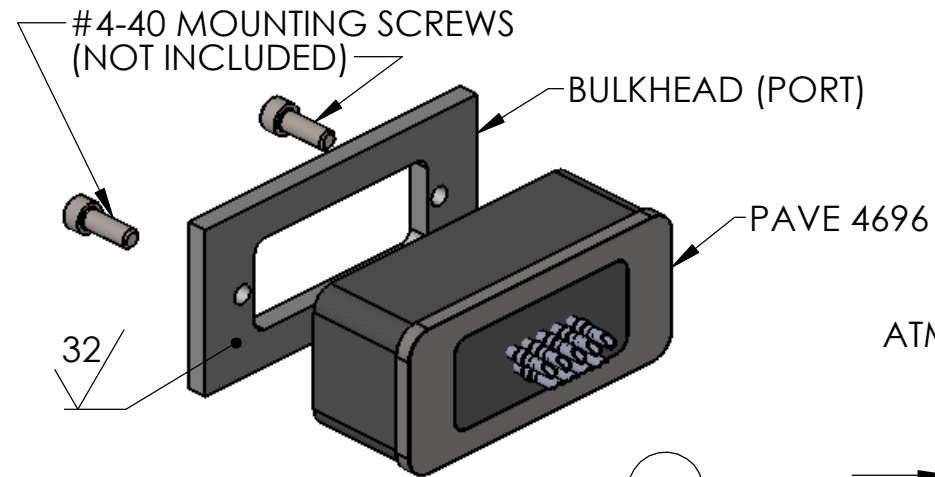
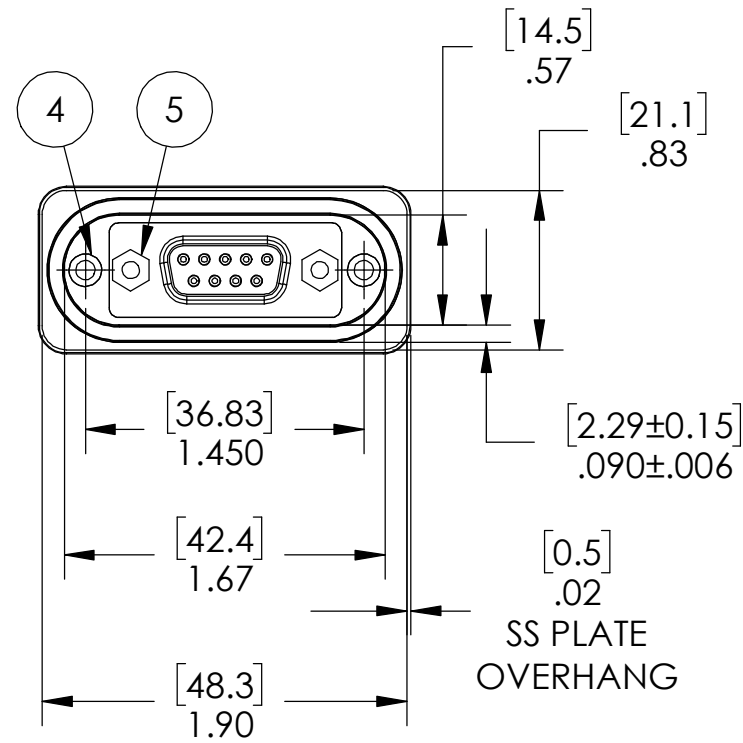
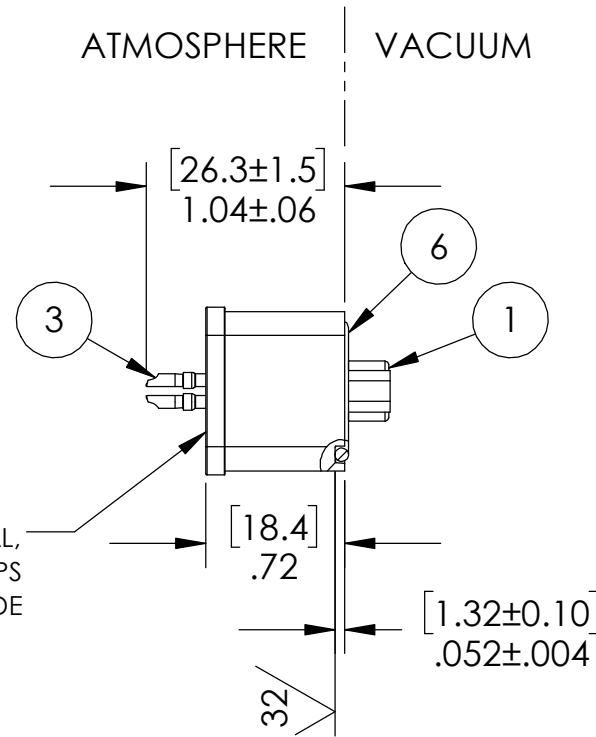

## SP30/13 INSTALLATION PORT

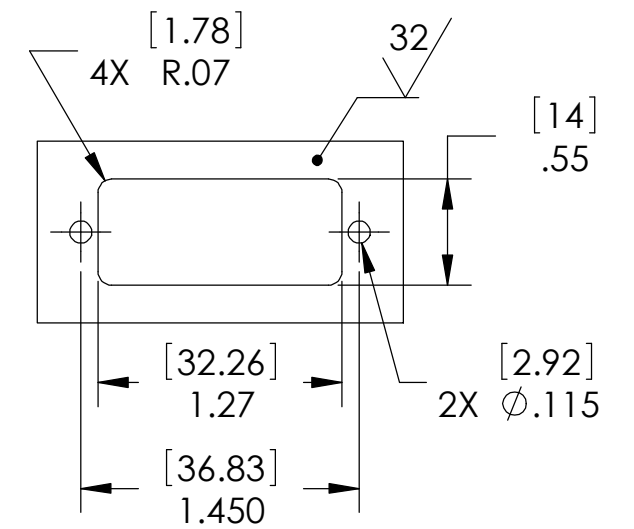

### NOTES:

1. HE LEAK TEST @ 1 ATM.  $1 \times 10^{-6}$  CC/SEC OR LESS. A GREEN PAINT DOT INDICATES THE PART HAS PASSED THE TEST.
2. HYPOT 630 VDC 500 MEGOHMS MINIMUM 0.01 SECOND MINIMUM CONDUCTOR TO CONDUCTOR AND CONNECTOR FLANGE.
3. CONTINUITY TEST <0.5 OHM MATING CONNECTOR TO SOLDER CUPS.
4. ALCOHOL OR FOMBLIN YVAC 3 MAY BE USED TO LUBRICATE O-RINGS FOR VACUUM HELIUM LEAK TESTING.
5. ALL TESTS ARE PERFORMED AT ROOM TEMPERATURE.
6. ALL PARTS MUST PASS ALL TESTS.
7. SOLDER CUP POSITIONING IS APPROXIMATE & VARIABLE.
8. NO COSMETIC SURFACE VOIDS ARE ACCEPTABLE ON O-RING SEALING SURFACES, COSMETIC SURFACE VOIDS SMALLER THAN  $\phi 0.035$  [0.89] ARE ACCEPTABLE ON ALL OTHER SURFACES.
9. REF-OPERATING TEMPERATURE  $-20^{\circ}\text{C}$  TO  $105^{\circ}\text{C}$ .
10. DIMENSIONS ARE INCHES [millimeters].
11. PAVE-SEAL CAN BE A BI-DIRECTIONAL HERMETIC SEAL FOR VACUUM AND MOST PRESSURES. FOR PRESSURES ABOVE 150 PSI (10 BAR), CHECK WITH SALES ENGINEERING.

7	1	3461	PLATE TOP SS 9 PIN DSUB
6	1	-026 VITON	O-RING -026 VITON 75
5	2	JACKPOST 4-40	"P" STYLE 4-40 UNC
4	2	YARDLEY #440A5-8	THREADED INSERT SS 4-40 X .12
3	9	AMP #66569	CONTACT SOLDER CUP #20 Sn/Ni PLATED BRONZE
2	A/R	PAVE-Seal 150	EPOXY BLACK
1	1	SEE TABLE	SEE TABLE
ITEM	QTY	PART NUMBER	DESCRIPTION

2751 Thunderhawk Court  
 Dayton, OH 45414-3445  
 U.S.A.  
 tel (937) 890-1100  
 fax (937) 8905165  
 www.pavetechnologyco.com

DESCRIPTION  
 SP30/13-E-150-9-20-DSUB-SC

PART NUMBER \*SEE TABLE MATERIAL NOTED  
**4696\***

REVISION LEVEL - PROJECTION

ALL DIMENSIONS AND TOLERANCES APPLY TO FINISHED PART IN INCHES.  
 ALLOWABLE TOLERANCES UNLESS SPECIFIED OTHERWISE: NONE  $\pm 0.5$   
 X.X DECIMAL  $\pm 0.1$  X.XX DECIMAL  $\pm 0.02$  X.XXX DECIMAL  $\pm 0.005$   
 ANGLES  $\pm 1$  DEGREE SURFACE FINISH 128 microinch RMS