

| PAVE# | ITEM 3 | ITEM 3 DESCRIPTION | TEMPERATURE RANGE |
|--------|---------------|-------------------------------|-------------------|
| 4765 | -116 VITON | O-RING -116 VITON 75 | -20°C TO 125°C |
| 4765-1 | -116 VITON LT | O-RING -116 VITON LOW-TEMP 75 | -40°C TO 125°C |

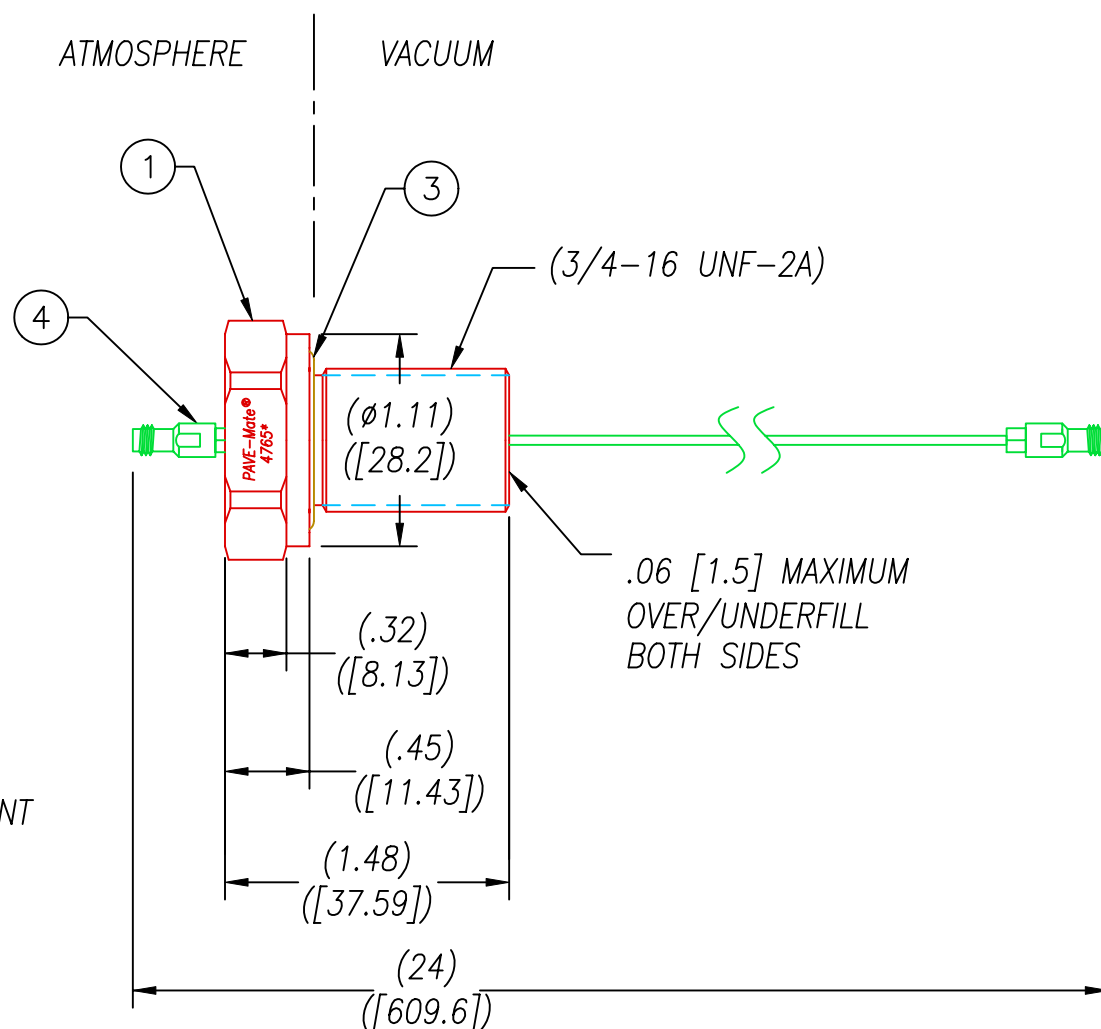

VS12L INSTALLATION PORT

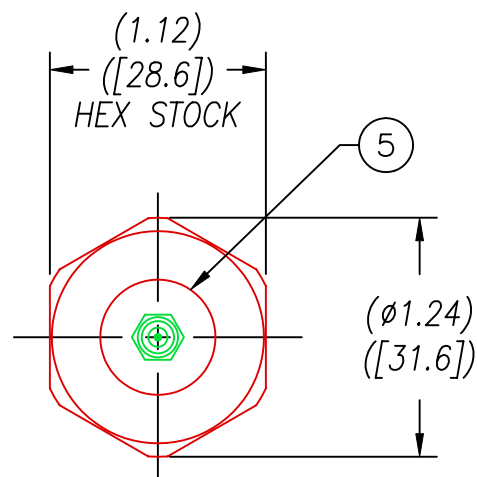
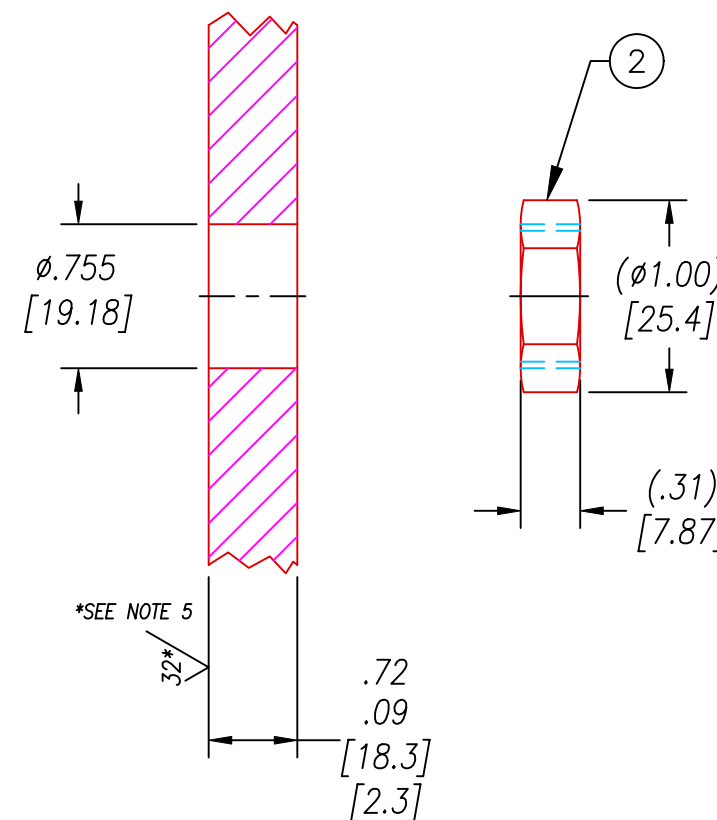

NOTES:

- HE LEAK TEST @1 ATM. 1×10^{-7} CC/S OR LESS. A GREEN PAINT DOT INDICATES THE PART HAS PASSED THE TEST.
- ALL TESTS ARE PERFORMED AT ROOM TEMPERATURE.
- ALCOHOL OR FOMBLIN YVAC 3 MAY BE USED TO LUBRICATE O-RINGS FOR VACUUM HELIUM TESTING.
- ALL PARTS MUST PASS ALL TESTS.
- FINISH APPLIES TO SPOTFACE FOR O-RING SEAL ONLY.
- DIMENSIONS ARE INCHES [millimeters].
- NO VOIDS LARGER THAN $\phi 0.035$ [0.89] ARE ACCEPTABLE.
- REF-OPERATING TEMPERTURE RANGE PER TABLE.
- PAVE-SEAL CAN BE A BI-DIRECTIONAL HERMETIC SEAL FOR VACUUM AND MOST PRESSURES. FOR PRESSURES ABOVE 150 PSI (10 BAR), CHECK WITH SALES ENGINEERING.
- FREQUENCY RESPONSE-
RETURN LOSS: >14 dB TO 48 GHz, >12dB TO 65 GHz, FUNCTIONAL TO 110 GHz (VERIFIED TO 65 GHz).
INSERTION LOSS (TO ABOVE FREQUENCY LIMIT): <1.7 dB/ft @18 GHz, <2.1 dB/ft @27 GHz, <2.6 dB/ft @40 GHz, <3.2 dB/ft @65 GHz, <5.0 dB/ft @110 GHz (TYPICAL), +0.3 dB PER CONNECTOR.

| 5 | A/R | PAVE-Seal 150 | EPOXY BLACK |
|------|-----|---------------|---|
| 4 | 1 | W047FF-24D | CABLE COAX 1.0mm FEMALE TO 1.0mm FEMALE |
| 3 | 1 | SEE TABLE | SEE TABLE |
| 2 | 1 | 8L5N-SS | NUT VS12-SS |
| 1 | 1 | 1180 | HOUSING VS12L-SS |
| ITEM | QTY | PART # | DESCRIPTION |

ALL DIMENSIONS AND TOLERANCES APPLY TO FINISHED PART IN INCHES
ALLOWABLE TOLERANCES UNLESS SPECIFIED OTHERWISE: NONE +/-0.5
.X DECIMAL +/- 0.1 .XX DECIMAL +/- 0.02 .XXX DECIMAL +/-0.005
ANGLES +/- 1 DEG SURFACE FINISH 128 microinch RMS



DESCRIPTION PAVE-Mate® II Connectors
VS12L-SS-150-1-100GHZCOAX-F-24F

PART NUMBER *SEE TABLE
4765*

REVISION LEVEL B
PROJECTION