

PART INSTALLATION, SCALE: 2:3

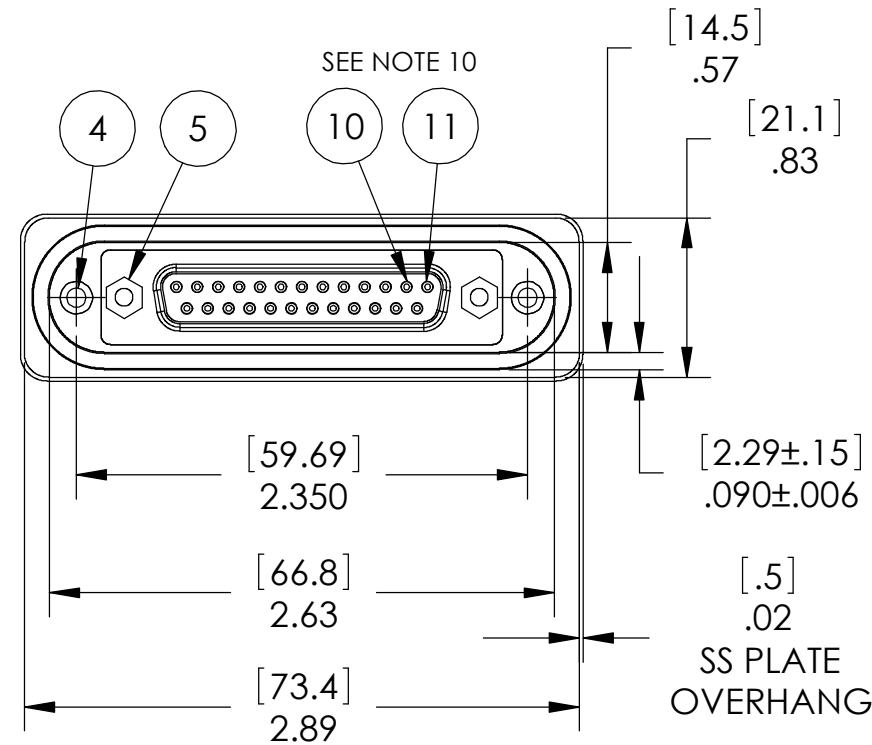

SP46/13 INSTALLATION PORT

SECURE PART WITH APPROPRIATE LENGTH #4-40 SCREWS

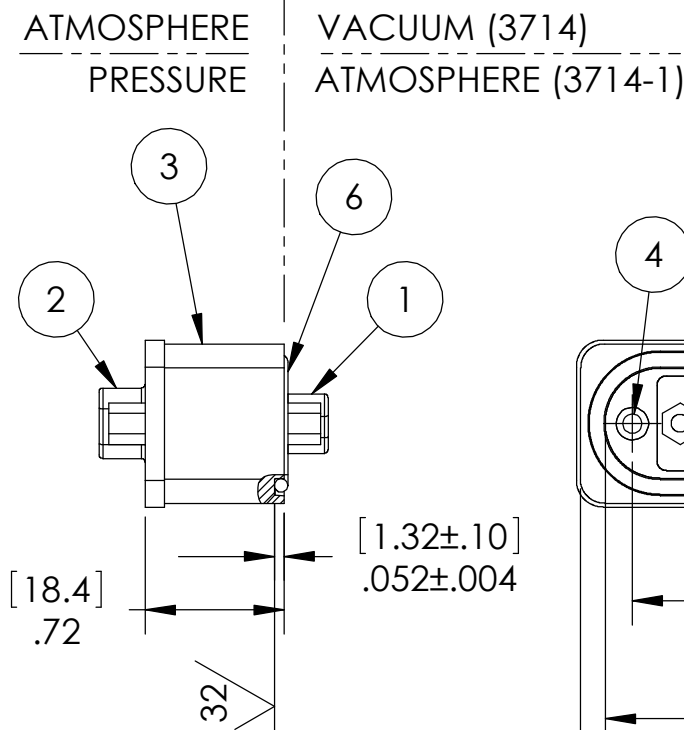
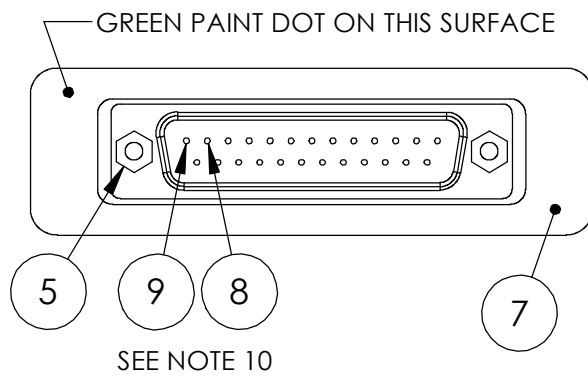
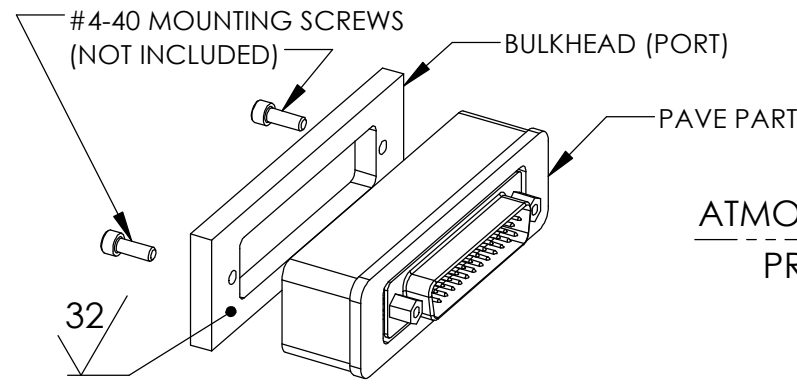
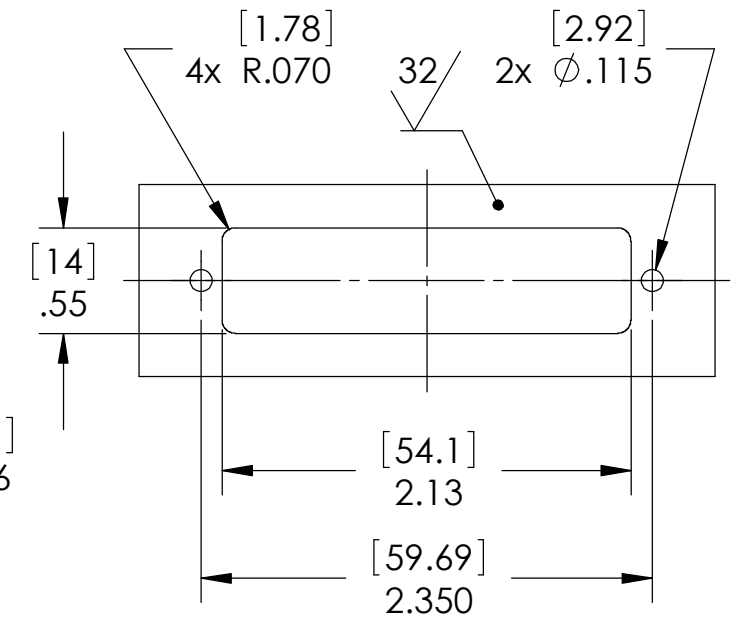

NOTES:

1. LEAK TESTING, A GREEN PAINT DOT WHERE NOTED INDICATES THE PART HAS PASSED THE TEST:
3714 ONLY: HE LEAK TEST @ 1 ATM. 1X10⁻⁶ CC/SEC OR LESS.
3714-1 ONLY: LEAK TEST 350 PSI, NO BUBBLES 30 SECONDS MINIMUM.
2. HYPOT 630 VDC 500 MEGOHMS MINIMUM 0.01 SECOND MINIMUM PIN TO PIN AND CONNECTOR FLANGES WITH MATING CONNECTORS.
3. ALL TESTS ARE PERFORMED AT ROOM TEMPERATURE.
4. ALL PARTS MUST PASS ALL TESTS.
5. COSMETIC SURFACE VOIDS NOT ON O-RING SEALING SURFACES ARE ACCEPTABLE BASED ON THE SEAL'S DIAMETER:
<= .5 [12.7] SEAL DIAMETER: Ø.035 [.89] MAX ALLOWED VOID SIZE
> .5 [12.7] SEAL DIAMETER: Ø.060 [1.5] MAX ALLOWED VOID SIZE
6. CONTINUITY TEST <0.5 Ohm PINS TO SOCKETS WITH MATING CONNECTORS.
7. REF-OPERATING TEMPERATURE RANGE -20 °C TO 105 °C.
8. DIMENSIONS ARE INCHES [millimeters].
9. PAVE-Mate CAN BE A BI-DIRECTIONAL HERMETIC SEAL FOR VACUUM AND MOST PRESSURES. FOR PRESSURES ABOVE 150 PSI (10 BAR), CHECK WITH SALES ENGINEERING.
10. EVEN NUMBER CONTACTS ARE ALUMEL(-) AND ODD NUMBER CONTACTS ARE CHROMEL(+).
11. ASSEMBLY SHIPS WITH MATING CONNECTORS (ITEMS 1 & 2) & CRIMP CONTACTS (ITEMS 8, 9, 10 & 11) LOOSE.

11	26	SMTC-CH-S	CONTACT #20 CRIMP TYPE K CHROMEL SOC
10	24	SMTC-AL-S	CONTACT #20 CRIMP TYPE K ALUMEL SOC
9	26	SMTC-CH-P	CONTACT #20 CRIMP TYPE K CHROMEL PIN
8	24	SMTC-AL-P	CONTACT #20 CRIMP TYPE K ALUMEL PIN
7	1	3420PG2C	PLATE TOP SS
6	1	-032 VITON	O-RING -032 VITON 75
5	4	JACKPOST 4-40	"P" STYLE 4-40 UNC
4	2	YARDLEY#440A5-8	THREADED INSERT SS 4-40 X .12
3	A/R	PAVE-Seal 150	EPOXY BLACK
2	2	170-025-173L000	PLUG D-SUB 25 POS PIN PBT INSULATOR, NICKEL PLATED STEEL SHELL
1	2	170-025-273L000	RCPT D-SUB 25 POS SOC PBT INSULATOR, NICKEL PLATED STEEL SHELL
ITEM	QTY	PART NUMBER	DESCRIPTION

2751 Thunderhawk Court
Dayton, OH 45414-3445
U.S.A.
tel (937) 890-1100
fax (937) 8905165
www.pavetechnologyco.com

PAVE technology co.

DESCRIPTION
SP46/13-E-150-25-20-DSUB-DSUB TYPE K CONTACTS

PART NUMBER *SEE NOTE 1
3714*

MATERIAL NOTED

REVISION LEVEL C

PROJECTION

ALL DIMENSIONS AND TOLERANCES APPLY TO FINISHED PART IN INCHES.
ALLOWABLE TOLERANCES UNLESS SPECIFIED OTHERWISE: NONE ±0.5
X.X DECIMAL ±0.1 X.XX DECIMAL ±0.02 X.XXX DECIMAL ±0.005
ANGLES ±1 DEGREE SURFACE FINISH 128 microinch RMS