

PAVE#	ITEM 3	ITEM 3 DESCRIPTION	TEMPERATURE RANGE
4765	-116 VITON	O-RING -116 VITON 75	-20°C TO 125°C
4765-1	-116 VITON LT	O-RING -116 VITON LOW-TEMP 75	-40°C TO 125°C

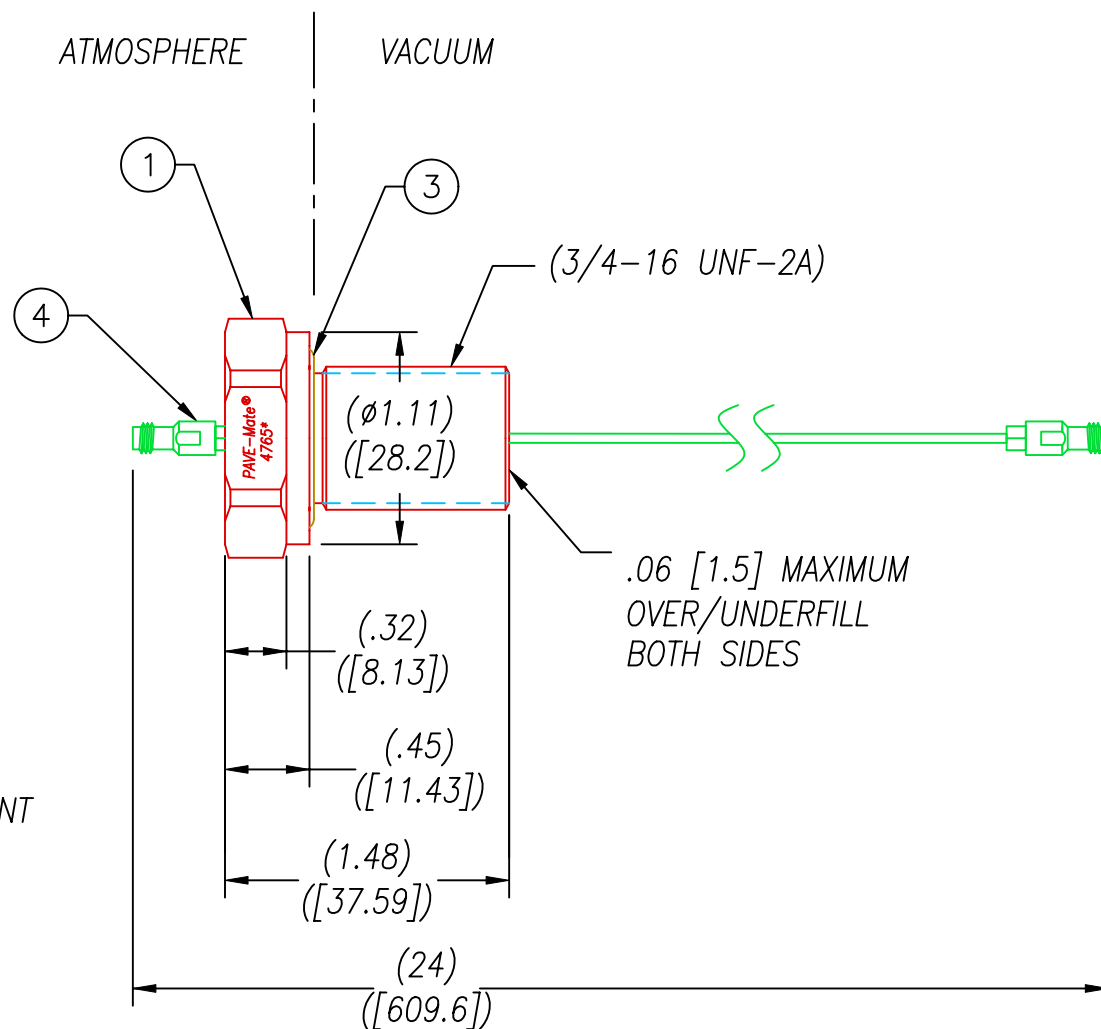

VS12L INSTALLATION PORT

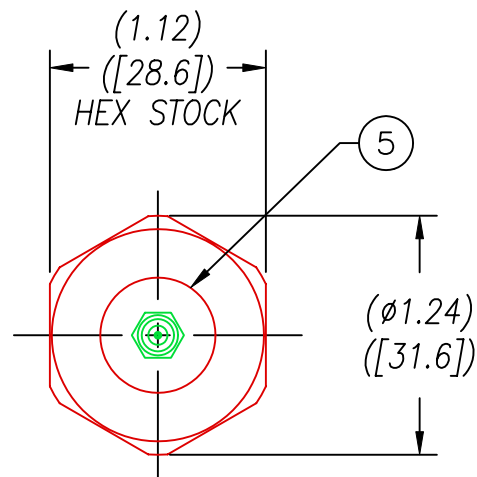
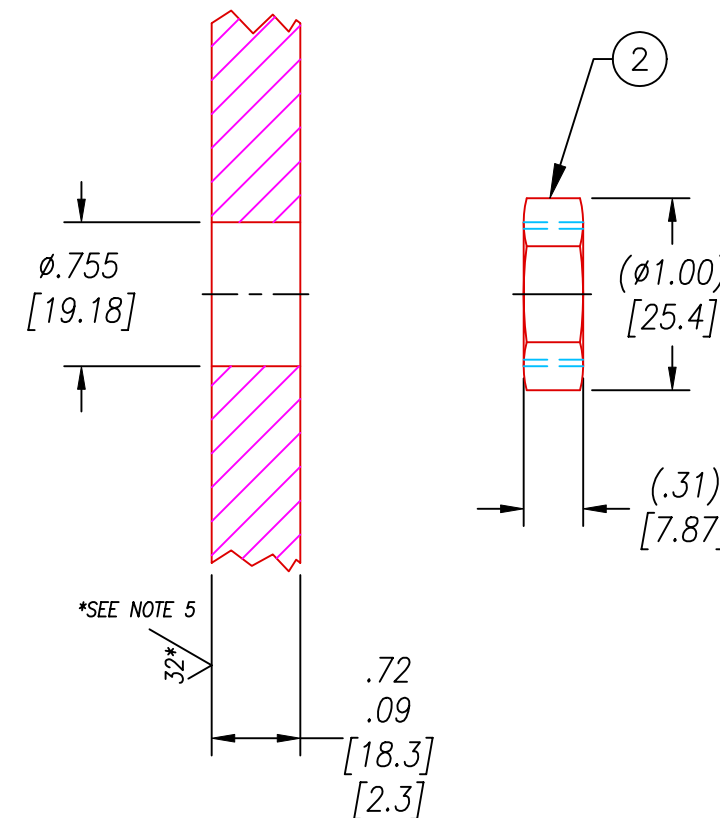

NOTES:

- HE LEAK TEST @1 ATM. 1×10^{-7} CC/S OR LESS. A GREEN PAINT DOT INDICATES THE PART HAS PASSED THE TEST.
- ALL TESTS ARE PERFORMED AT ROOM TEMPERATURE.
- ALCOHOL OR FOMBLIN YVAC 3 MAY BE USED TO LUBRICATE O-RINGS FOR VACUUM HELIUM TESTING.
- ALL PARTS MUST PASS ALL TESTS.
- FINISH APPLIES TO SPOTFACE FOR O-RING SEAL ONLY.
- DIMENSIONS ARE INCHES [millimeters].
- NO VOIDS LARGER THAN $\phi 0.035$ [0.89] ARE ACCEPTABLE.
- REF-OPERATING TEMPERTURE RANGE PER TABLE.
- PAVE-SEAL CAN BE A BI-DIRECTIONAL HERMETIC SEAL FOR VACUUM AND MOST PRESSURES. FOR PRESSURES ABOVE 150 PSI (10 BAR), CHECK WITH SALES ENGINEERING.
- FREQUENCY RESPONSE-
RETURN LOSS: >14 dB TO 48 GHz, >12dB TO 65 GHz, FUNCTIONAL TO 110 GHz (VERIFIED TO 65 GHz).
INSERTION LOSS (TO ABOVE FREQUENCY LIMIT): <1.7 dB/ft @18 GHz, <2.1 dB/ft @27 GHz, <2.6 dB/ft @40 GHz, <3.2 dB/ft @65 GHz, <5.0 dB/ft @110 GHz (TYPICAL), +0.3 dB PER CONNECTOR.

5	A/R	PAVE-Seal 150	EPOXY BLACK
4	1	W047FF-24D	CABLE COAX 1.0mm FEMALE TO 1.0mm FEMALE
3	1	SEE TABLE	SEE TABLE
2	1	8L5N-SS	NUT VS12-SS
1	1	1180	HOUSING VS12L-SS
ITEM	QTY	PART #	DESCRIPTION

ALL DIMENSIONS AND TOLERANCES APPLY TO FINISHED PART IN INCHES
ALLOWABLE TOLERANCES UNLESS SPECIFIED OTHERWISE: NONE +/-0.5
.X DECIMAL +/- 0.1 .XX DECIMAL +/- 0.02 .XXX DECIMAL +/-0.005
ANGLES +/- 1 DEG SURFACE FINISH 128 microinch RMS



DESCRIPTION PAVE-Mate® II Connectors
VS12L-SS-150-1-100GHZCOAX-F-24F

PART NUMBER *SEE TABLE

4765*

REVISION LEVEL B

PROJECTION