

REF-PART INSTALLATION

SCALE: 2:3

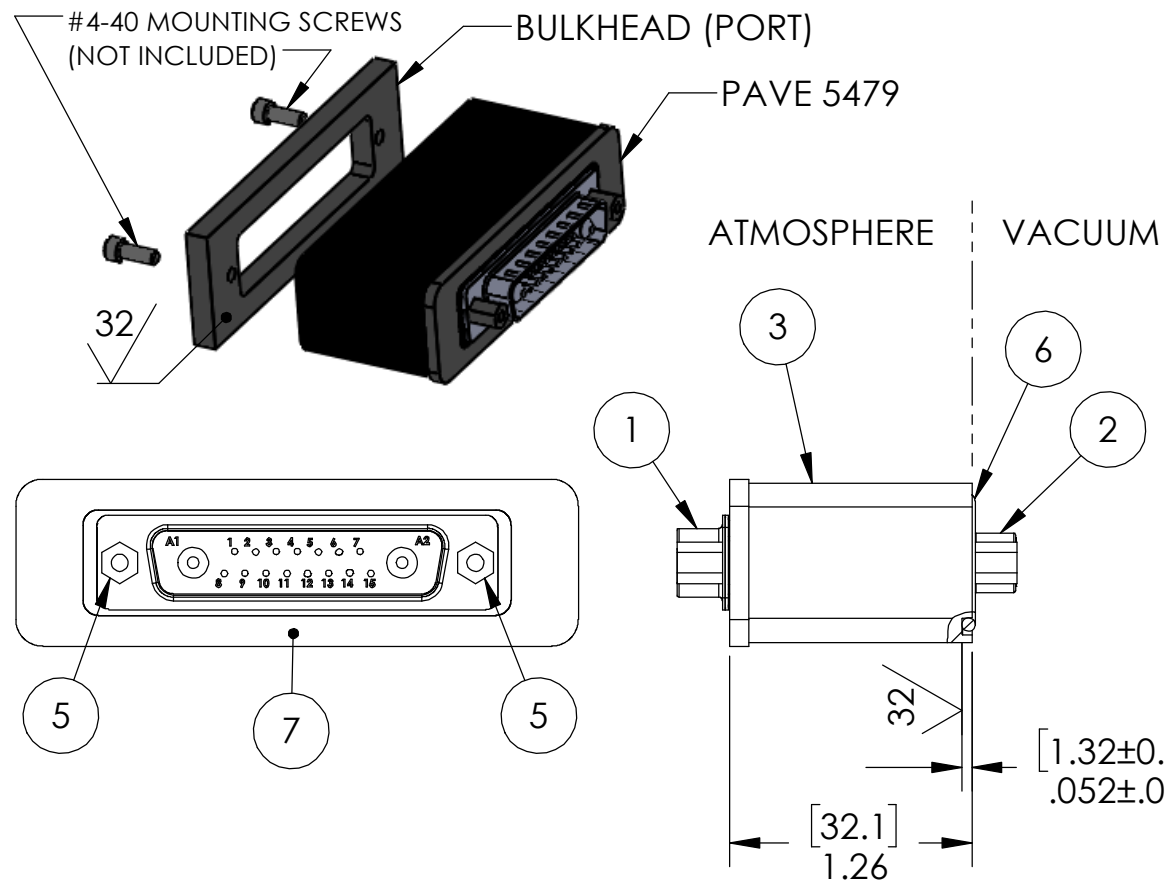

SP46/13 INSTALLATION PORT

SECURE PART WITH APPROPRIATE LENGTH #4-40 SCREWS

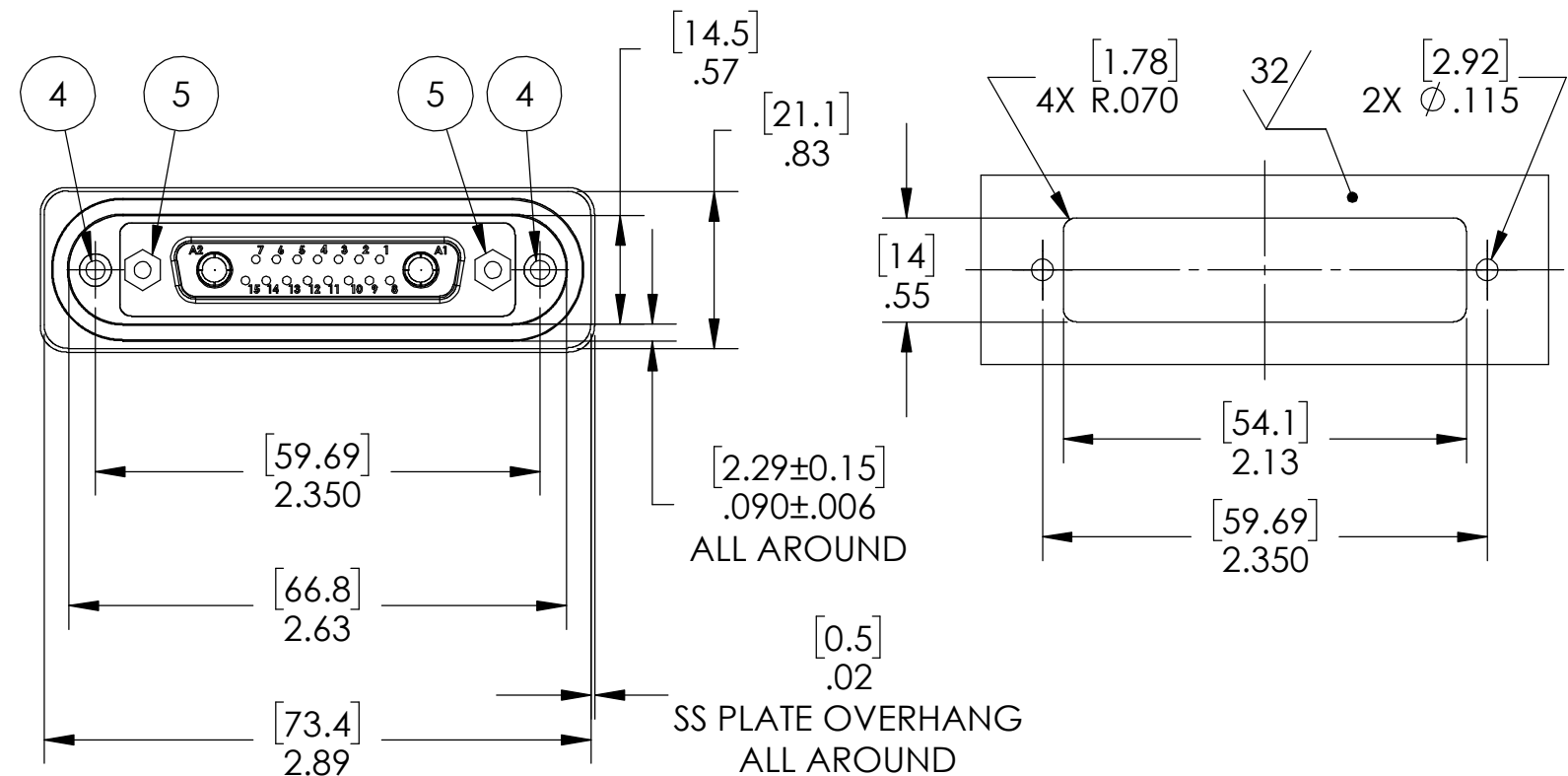

NOTES:

1. HE LEAK TEST @ 1 ATM. 1X10⁻⁶ CC/SEC OR LESS. A GREEN PAINT DOT ON THE ATMOSPHERE SIDE INDICATES THE PART HAS PASSED THE TEST. TEST CERTIFICATIONS FOR LOWER HELIUM LEAK RATES DOWN TO 10⁻¹⁰ CC/SEC RATE MAY BE AVAILABLE BY CONTACTING PAVE SALES ENGINEERING PRIOR TO ORDERING.
2. HYPOT 630 VDC 500 MEGOHMS MINIMUM 0.01 SECOND MINIMUM PIN TO PIN AND CONNECTOR FLANGES WITH MATING CONNECTORS.
3. CONTINUITY TEST <0.5 Ohm PINS TO SOCKETS WITH MATING CONNECTORS.
4. ALCOHOL OR FOMBLIN YVAC 3 MAY BE USED TO LUBRICATE O-RINGS FOR VACUUM HELIUM LEAK TESTING.
5. ALL TESTS ARE PERFORMED AT ROOM TEMPERATURE.
6. ALL PARTS MUST PASS ALL TESTS.
7. COSMETIC SURFACE VOIDS NOT ON O-RING SEALING SURFACES ARE ACCEPTABLE BASED ON THE SEAL'S DIAMETER:
 <= .5 [12.7] SEAL DIAMETER: Ø.035 [.89] MAX ALLOWED VOID SIZE
 > .5 [12.7] SEAL DIAMETER: Ø.060 [1.5] MAX ALLOWED VOID SIZE
8. REF-OPERATING TEMPERATURE RANGE -20 °C TO 125 °C.
9. DIMENSIONS ARE INCHES [millimeters].
10. PAVE-SEAL CAN BE A BI-DIRECTIONAL HERMETIC SEAL FOR VACUUM AND MOST PRESSURES. FOR PRESSURES ABOVE 150 PSI (10 BAR), CHECK WITH SALES ENGINEERING.

7	1	3420PG2C	PLATE TOP SS
6	1	-032 VITON	O-RING -032 VITON 75
5	4	JACKPOST 4-40	"P" STYLE 4-40 UNC
4	2	YARDLEY#440A5-8	THREADED INSERT SS 4-40 X .12
3	A/R	PAVE-Seal 150	EPOXY BLACK
2	1	680M17W2203L401	RCPT D-SUB 2#8/15#20 SOCKET PBT INSULATOR, NICKEL PLATED STEEL SHELL, GOLD PLATED COPPER ALLOY CONTACTS (40 AMP POWER)
1	1	680M17W2103L401	PLUG D-SUB 2#8/15#20 PIN PBT INSULATOR, NICKEL PLATED STEEL SHELL, GOLD PLATED COPPER ALLOY CONTACTS (40 AMP POWER)
ITEM	QTY	PART NUMBER	DESCRIPTION

PAVE technology co.
 2751 Thunderhawk Court
 Dayton, OH 45414-3445
 U.S.A.
 tel (937) 890-1100
 fax (937) 8905165
 www.pavetechnologyco.com

DESCRIPTION SP46/13-E-150-2/15-8/20-DSUB-DSUB	
PART NUMBER 5479	MATERIAL NOTED
REVISION LEVEL -	PROJECTION ☉

ALL DIMENSIONS AND TOLERANCES APPLY TO FINISHED PART IN INCHES.
 ALLOWABLE TOLERANCES UNLESS SPECIFIED OTHERWISE: NONE ±0.5
 X.X DECIMAL ±0.1 X.XX DECIMAL ±0.02 X.XXX DECIMAL ±0.005
 ANGLES ±1 DEGREE SURFACE FINISH 128 microinch RMS