

VS8 INSTALLATION PORT

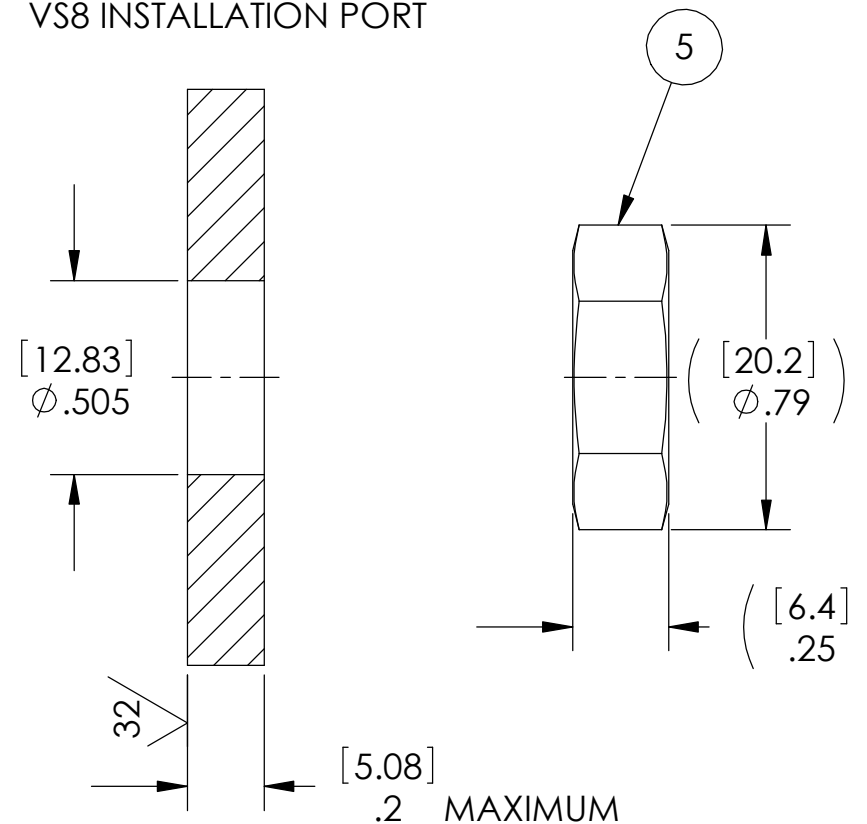

NOTES:

1. LEAK TEST: 750 PSI, NO BUBBLES 1 MINUTE MINIMUM.
2. HYPOT 630 VDC 500 MEGOHMS MINIMUM 0.01 SECOND MINIMUM CENTER CONDUCTOR TO MICRODOT SHELL TO HOUSING WITH MATING CONNECTORS.
3. ALL TESTS ARE PERFORMED AT ROOM TEMPERATURE.
4. ALL PARTS MUST PASS ALL TESTS.
5. VOIDS LARGER THAN $\phi .035$ [.89] ARE NOT ACCEPTABLE.
6. REF-OPERATING TEMPERATURE RANGE -37°C TO 107°C.
7. DIMENSIONS ARE INCHES [millimeters].
8. PAVE-SEAL CAN BE A BI-DIRECTIONAL HERMETIC SEAL FOR VACUUM AND MOST PRESSURES. FOR PRESSURES ABOVE 150 PSI (10 BAR), CHECK WITH SALES ENGINEERING.

ITEM	QTY	PART NUMBER	DESCRIPTION
5	1	0894	NUT VS8-SS
4	1	-112 NEOPRENE	O-RING -112 NEOPRENE 75
3	A/R	PAVE-Seal 150	EPOXY BLACK
2	2	131-0140-0001	RECEPTACLE 50 OHM S-50 MICRODOT
1	1	0892	HOUSING VS8-SS

PAVE technology co.

2751 Thunderhawk Court
Dayton, OH 45414-3445
U.S.A.
tel (937) 890-1100
fax (937) 8905165
www.pavetechnologyco.com

DESCRIPTION
VS8-SS-150-1-10-32 MICRODOT

PART NUMBER: **3349**

MATERIAL: NOTED

REVISION LEVEL: G

PROJECTION:

ALL DIMENSIONS AND TOLERANCES APPLY TO FINISHED PART IN INCHES.
ALLOWABLE TOLERANCES UNLESS SPECIFIED OTHERWISE: NONE ±0.5
X.X DECIMAL ±0.1 X.XX DECIMAL ±0.02 X.XXX DECIMAL ±0.005
ANGLES ±1 DEGREE SURFACE FINISH 128 microinch RMS