

RECEPTACLE PIN OUT TABLE

PIN/MARKER	COLOR
A	ORANGE
B	VIOLET
C	WHITE
D	GREEN
E	BLACK
F	BLUE
G	GRAY
H	RED

- NOTES:
- HE LEAK TEST @1 ATM. <math>10^{-7}</math> CC/S.
  - HYPOT 630 VDC 500 MW 0.01 SEC MINIMUM, WIRE TO WIRE & HOUSING.
  - ELECTRICAL CONTINUITY- PIN TO WIRE ENDS <math>< 0.5</math> W.
  - ALL TESTS ARE PERFORMED AT ROOM TEMPERATURE.
  - PERCENTAGE OF PARTS TESTED WILL BE 100% (MAY BE

A LESSER PERCENTAGE FOR LARGE PRODUCTION QUANTITIES, UNLESS OTHERWISE NOTED OR REQUIRED).

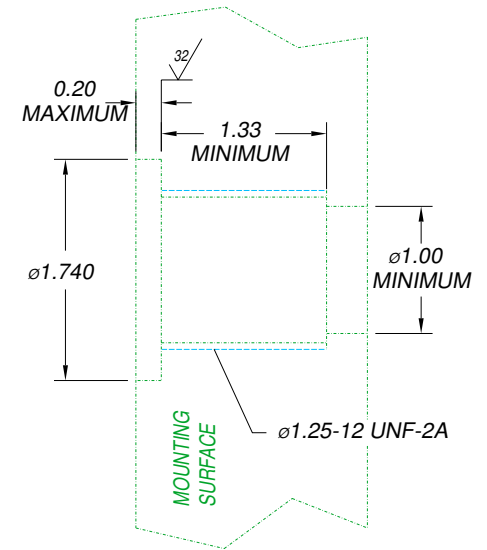
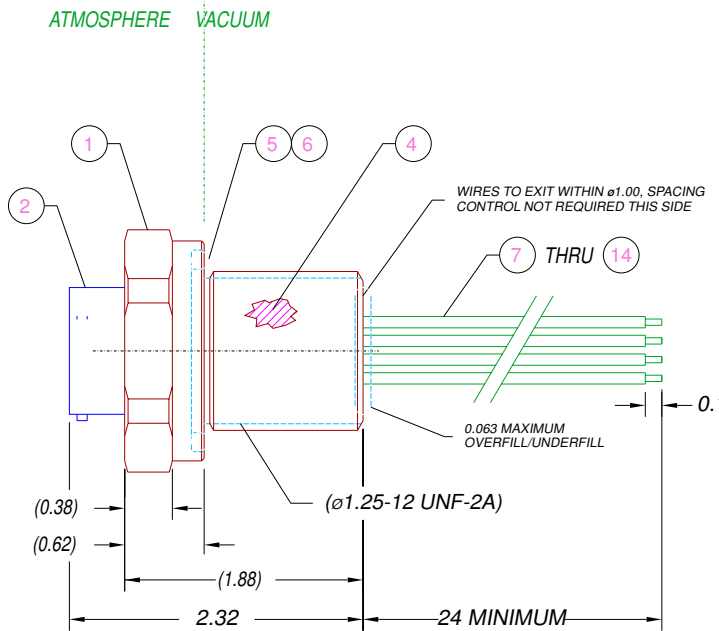

14	1	EE16 VIOLET	WIRE 16EE MIL-W-16878/5 .015 19/#29
13	1	EE16 GRAY	WIRE 16EE MIL-W-16878/5 .015 19/#29
12	1	EE16 WHITE	WIRE 16EE MIL-W-16878/5 .015 19/#29
11	1	EE16 RED	WIRE 16EE MIL-W-16878/5 .015 19/#29
10	1	EE16 ORANGE	WIRE 16EE MIL-W-16878/5 .015 19/#29
9	1	EE16 GREEN	WIRE 16EE MIL-W-16878/5 .015 19/#29
8	1	EE16 BLUE	WIRE 16EE MIL-W-16878/5 .015 19/#29
7	1	EE16 BLACK	WIRE 16EE MIL-W-16878/5 .015 19/#29
6	A/R	SUPER-O-LUBE	LUBRICANT O-RING SILICONE BASED
5	1	-219 VITON	O-RING -219 VITON 75
4	A/R	PAVE-Seal 150	EPOXY BLACK
3	1	SC3126F16-8S	PLUG 8 #16 SOCKETS
2	1	SC3112E16-8P	RCPT 3112 8 #16 PINS
1	1	0660 VS18-SS	HOUSING VS18-SS
ITEM	QTY	PART#	DESCRIPTION

ALL DIMENSIONS AND TOLERANCES APPLY TO FINISHED PART IN INCHES  
 ALLOWABLE TOLERANCES UNLESS SPECIFIED OTHERWISE: NONE +/-0.5  
 .X DECIMAL +/- 0.1 .XX DECIMAL +/- 0.02 .XXX DECIMAL +/-0.005  
 ANGLES +/- 1 DEG SURFACE FINISH 128 microinch RMS

**PAVE technology** 2751 Thunderhawk Court  
 Dayton, Ohio 45414-3445  
 U.S.A.  
 (937)890-1100  
 fax (937)890-5165  
 www.pavetechnologyco.com

DESCRIPTION  
**VS18-SS-150-8-TEE16-3112P-24**

PART NUMBER  
**2666**

REVISION LEVEL  
 -

PROJECTION